

OFFICE OF STATE ENGINEER

REC'D  
APR 22 1912

Application No. 2230  
Permit No. 1121

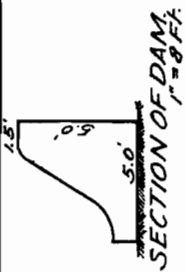
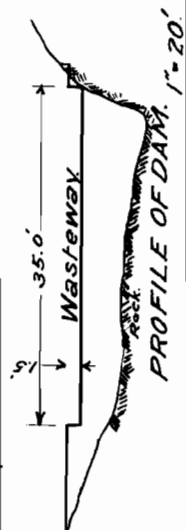
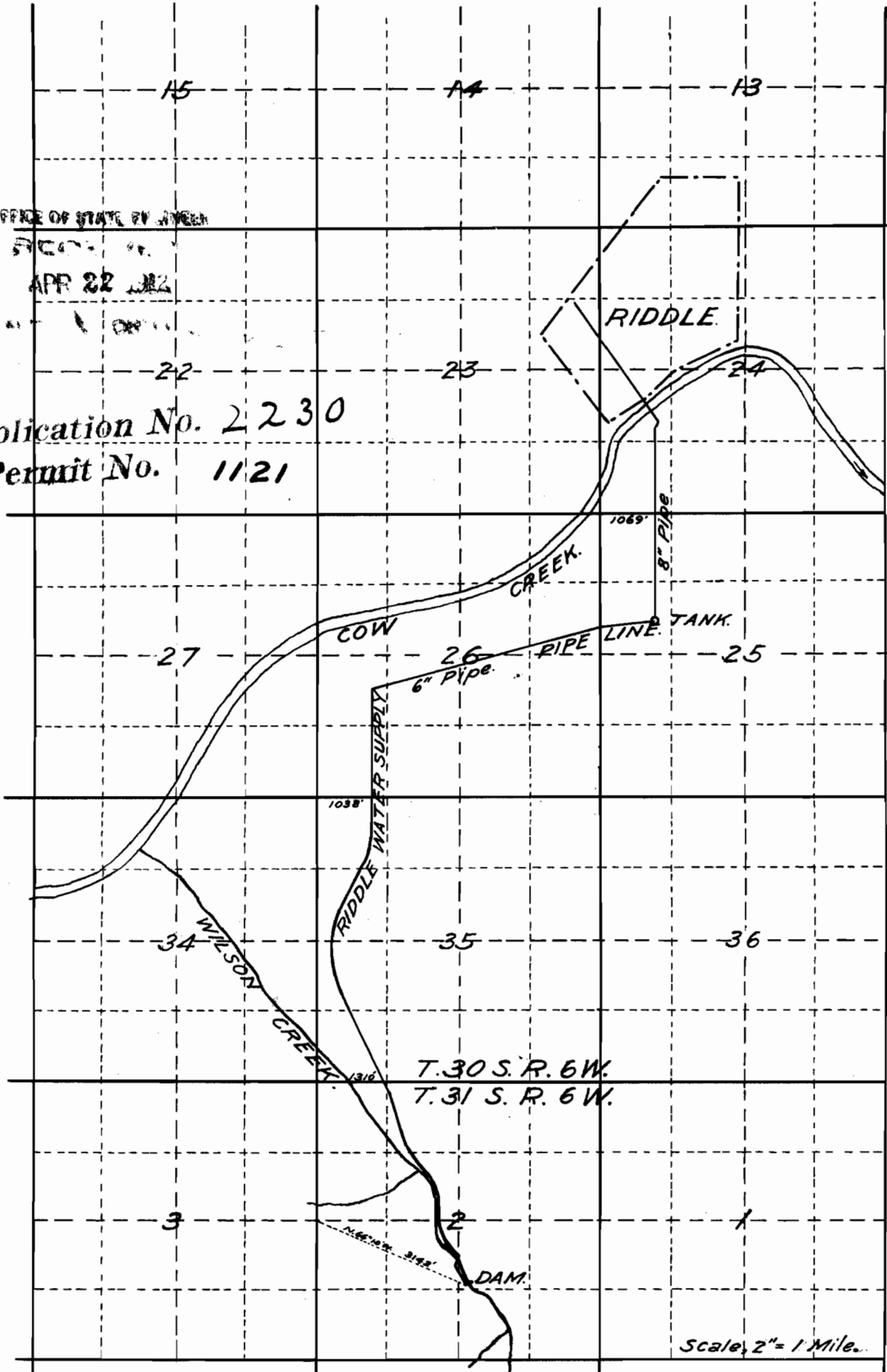

Scale, 2" = 1 Mile.

CERTIFICATE OF SURVEYOR.

I, C.C. Boyer, of Roseburg, Ore., do hereby certify that this map was made from notes taken during an actual survey made by me Jan. 16 to 20, 1912, and that it correctly represents the works described in the accompanying application, together with the location of streams in the immediate vicinity.

C.C. Boyer  
SURVEYOR.

RIDDLE WATER SUPPLY.

Map accompanying application for  
permit to appropriate water.

April 20th, 1912.