

SECTION

TOWNSHIP 10S, RANGE 30E, W. M.

North

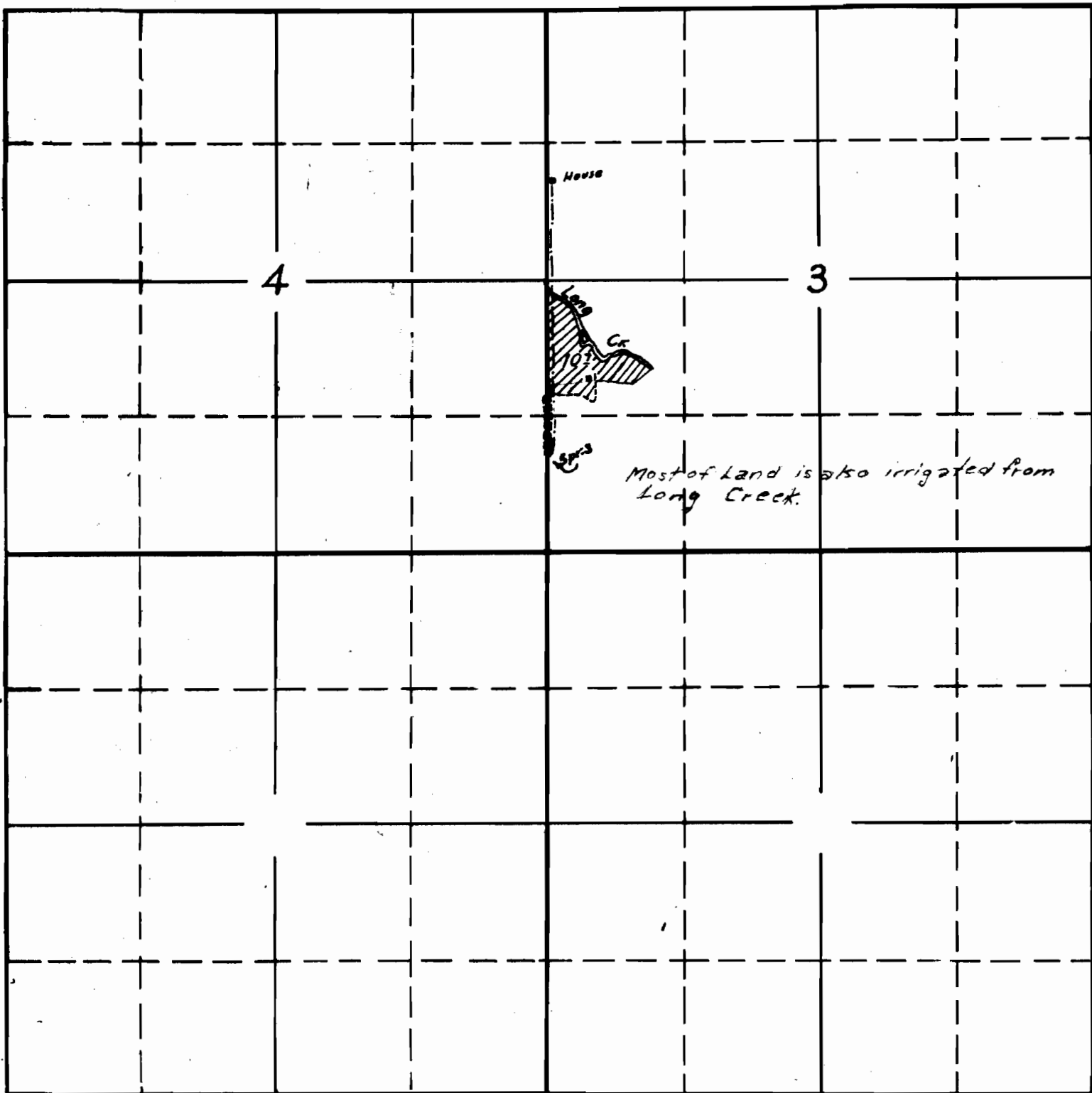

South

APPLICATION No. 15126

PERMIT No. 11210

Source
2 Springs

Pendleton - John Day Highway

Sec 4
Sec 3

1/4 CORNER

11.67 A.

Irrigation Ditch

Irrigation

Proposed

Creek

Long

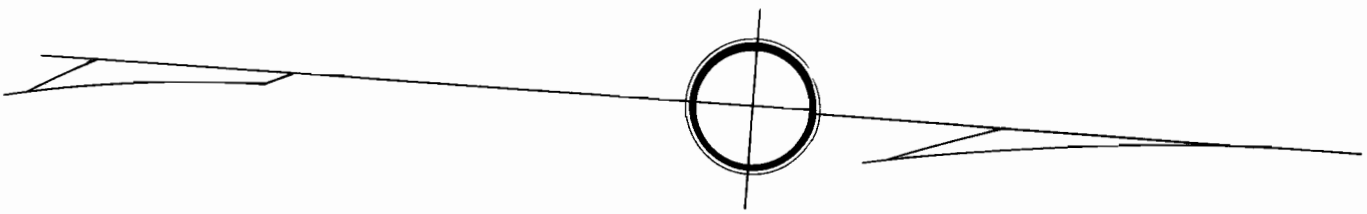

Source, Proposed Irrigation Ditch and
Acreage to be Irrigated by JOHN FRENCH
in the NW 1/4 of the S.W 1/4 of Sec 3. T10S., R30E.W.M.
Grant County - Oregon.

Scale 1" = 100'

App. No. 15126
Per. No. 11210

