

North

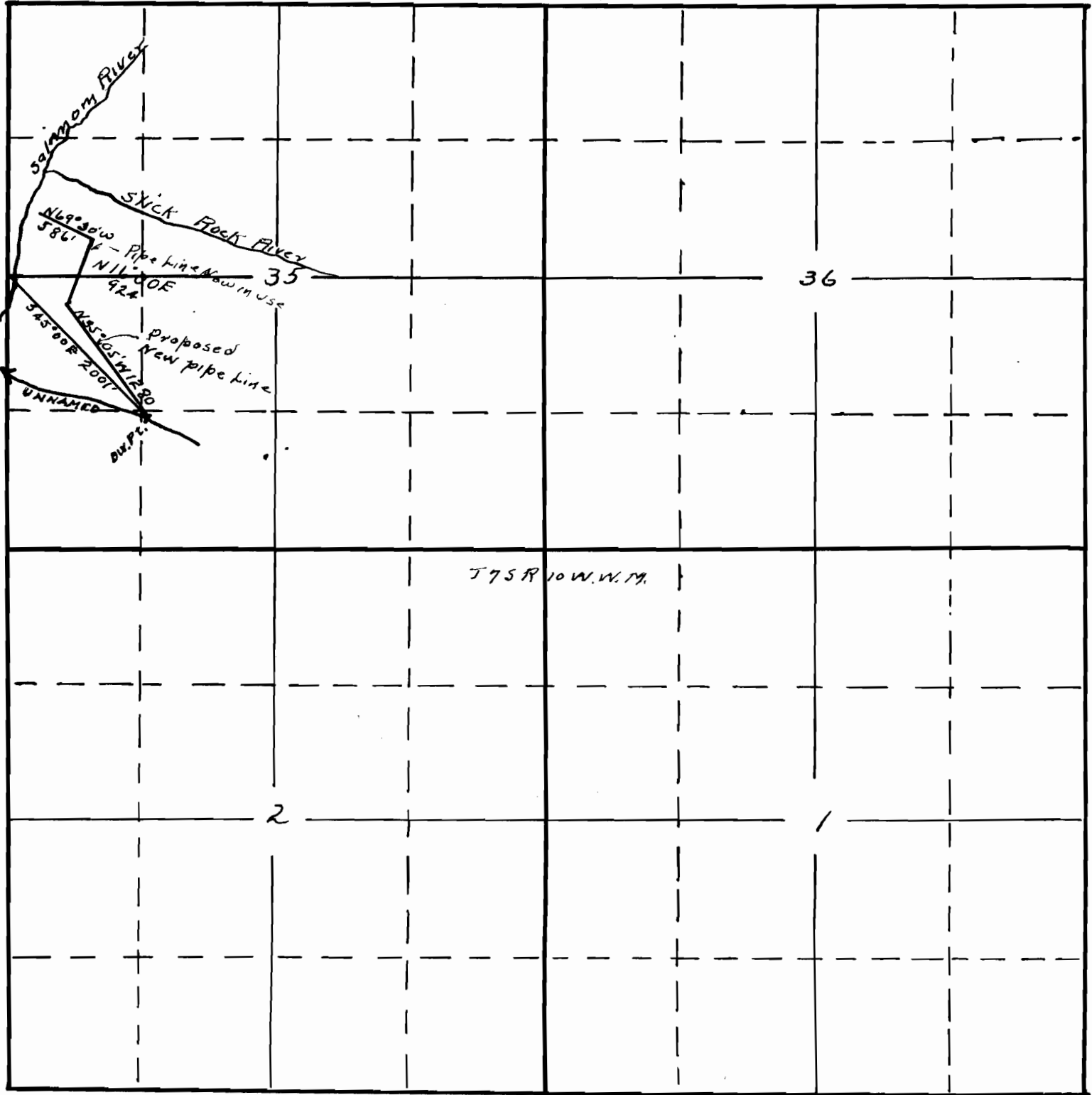

T75 R 10 W. W. M.

South

I, H M. Teel of Toledo Oregon do hereby certify that this map was made from notes taken during an actual survey made by me on Feb 25 1934 and that it correctly represents the works described in the accompanying application together with the location of streams in the immediate vicinity

H. M. Teel

Oregon No 1013
App. No. 15305
Per. No. 11222

May 8 1920
Date of Registration