

SECTION

\_\_\_\_\_  
\_\_\_\_\_  
\_\_\_\_\_

TOWNSHIP 34S, RANGE 5W, W. M.

North

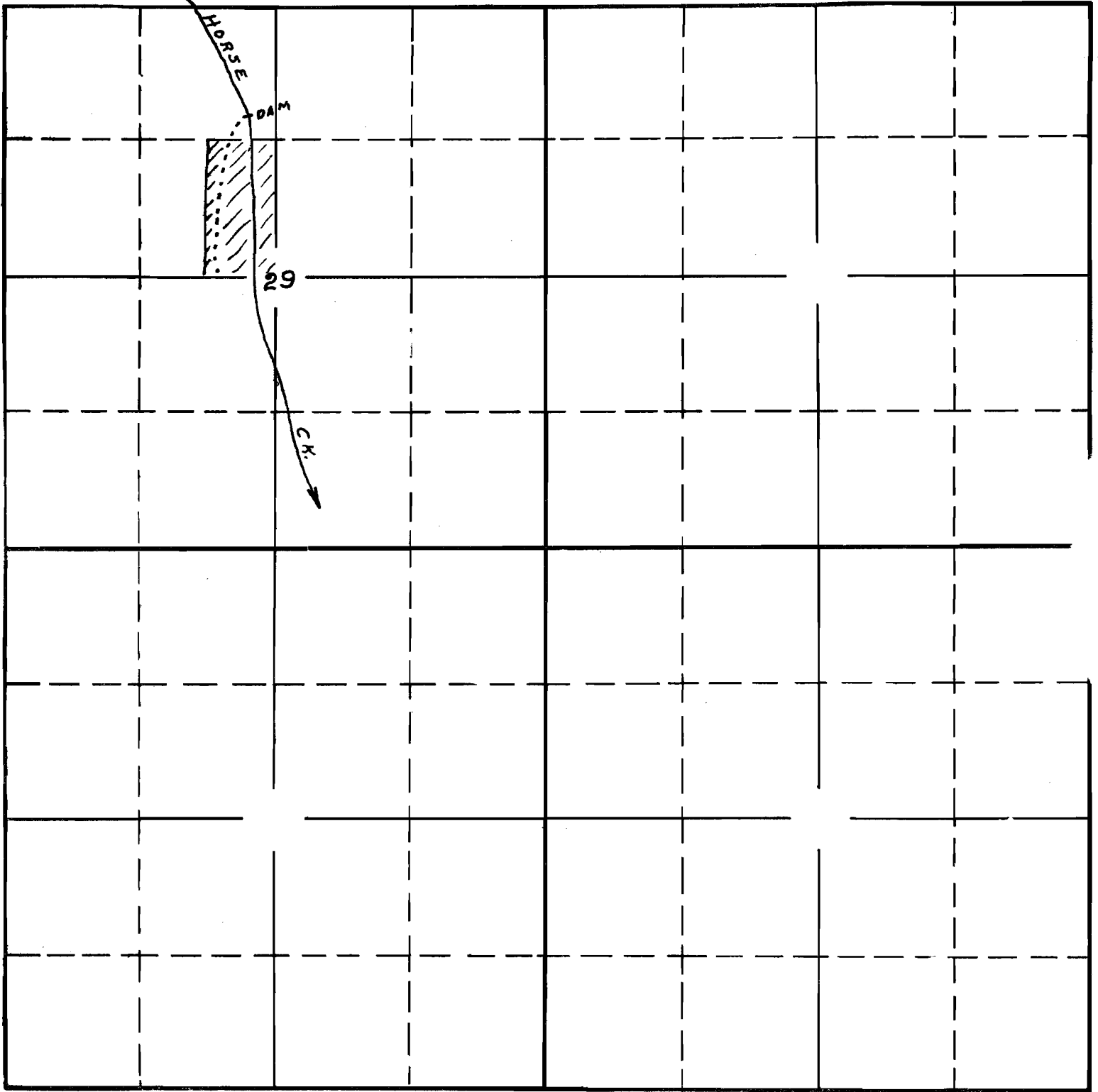

South

APPLICATION No. 15417

PERMIT No. 11314

SECTION  
29.  
\_\_\_\_\_  
\_\_\_\_\_

TOWNSHIP 34<sup>s</sup>, RANGE 5<sup>w</sup>, W. M.

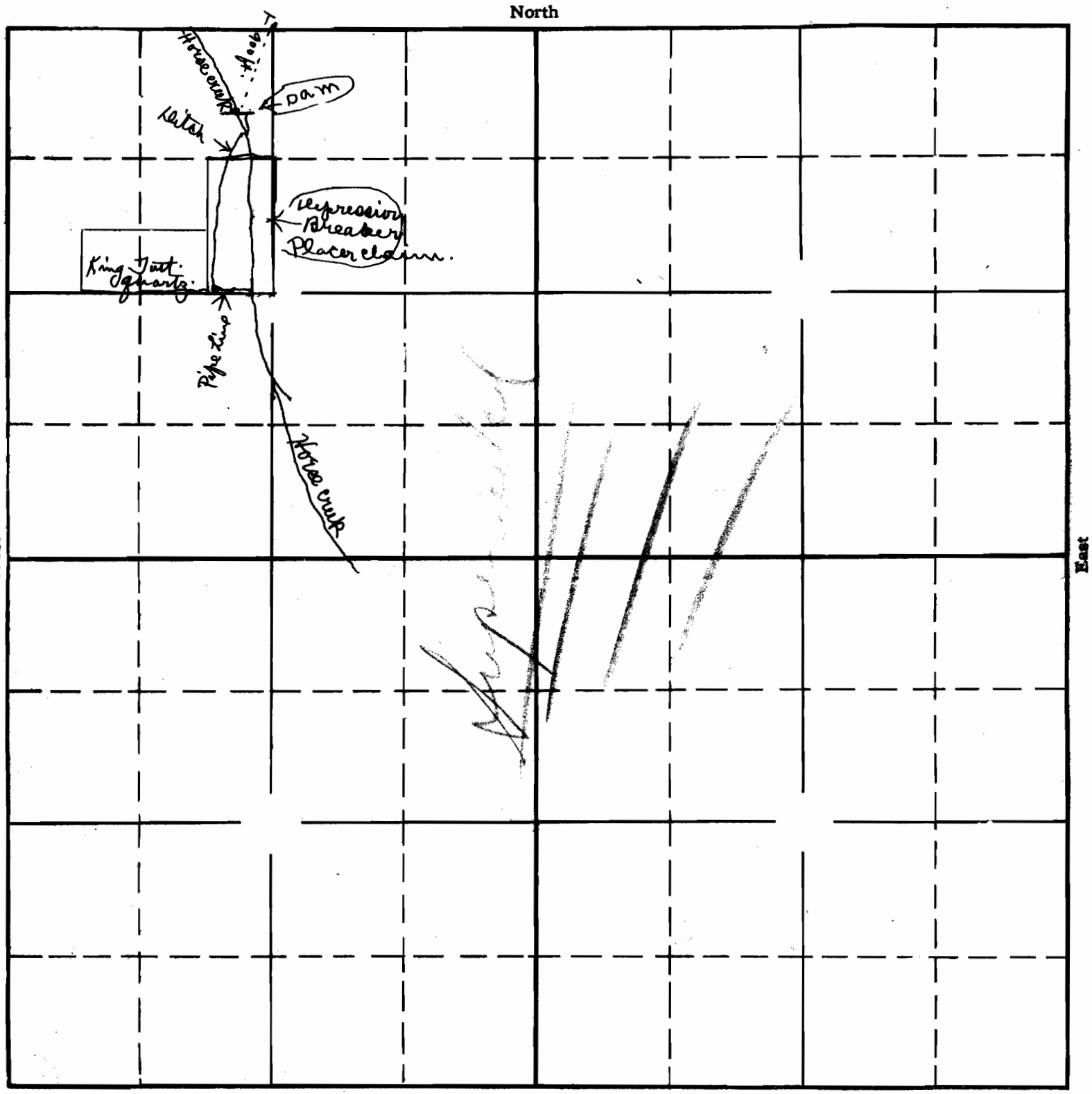

**RECEIVED**  
JUL 25 1934  
**STATE ENGINEER**  
SALEM, OREGON

APPLICATION No.  
PERMIT No.