

MAP

Accompanying application of PAUL S. SEELEY of Portland, Oregon, for permit to appropriate the Springs, Seepage and waste Waters as designated on plat tributary to Evans Creek, tributary to Rogue River, Jackson County Oregon.

August 1918.

Tp 35 S. R. 4 W. W. M.

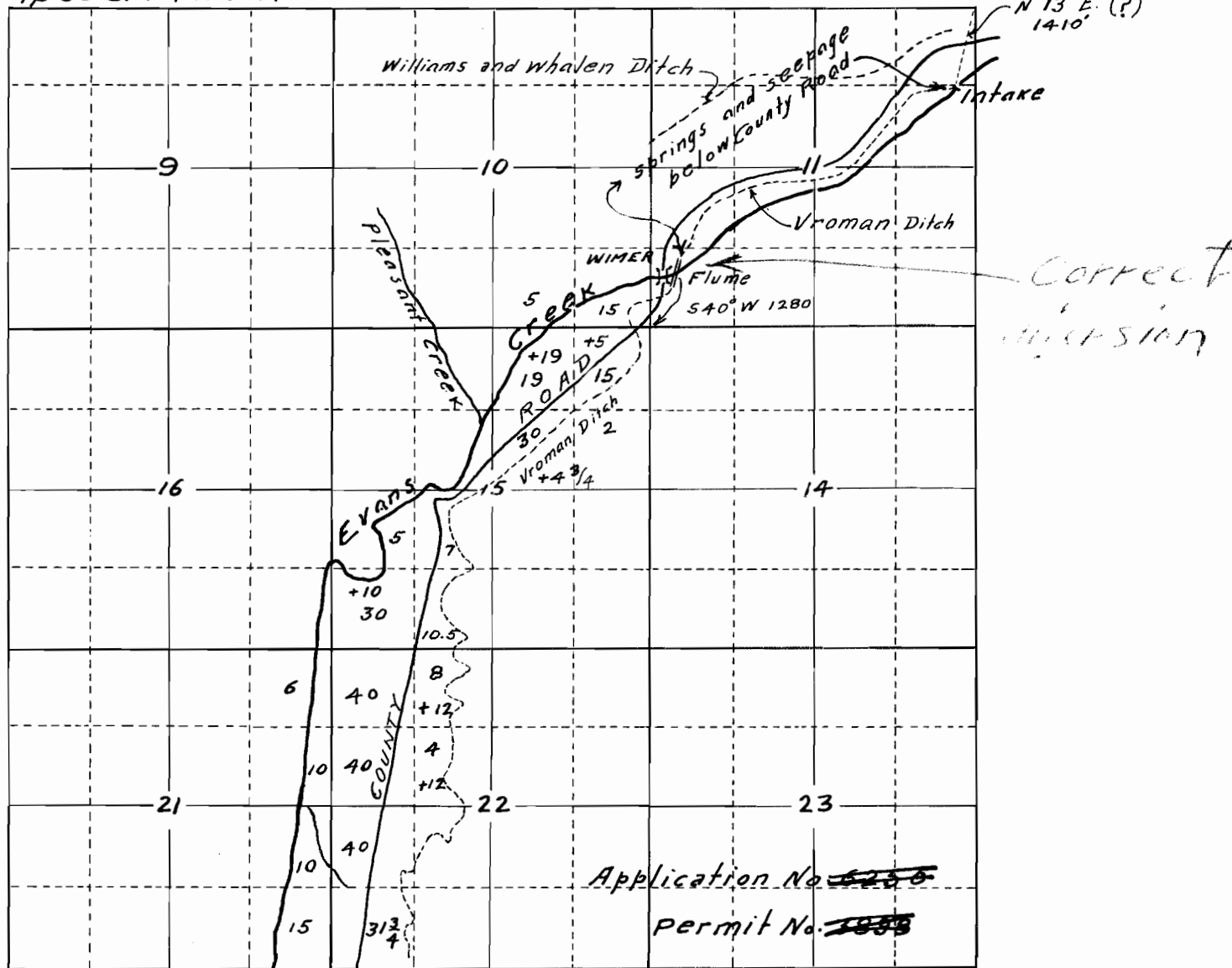

App. No. 15062
Per. No. 11337

Map made from Map of the irrigated lands and from actual survey in the field of the location of ditch at intake and points of seepage and waste waters made by V. T. McCray and compiled from his notes showing correctly location of ditches and streams in the immediate vicinity.

Fred N. Cummings. C.E.

Note- Retraced from blue print by R. D. Cooper - Aug. 1934.