

SURVEYOR'S CERTIFICATE.

I, W.E. Anderson County Surveyor of Tillamook County, do hereby certify that this map was made from notes taken during an actual survey made by me on Sept. 7, 1934, and that it correctly represents the property herein shown.

W.E. Anderson
County Surveyor

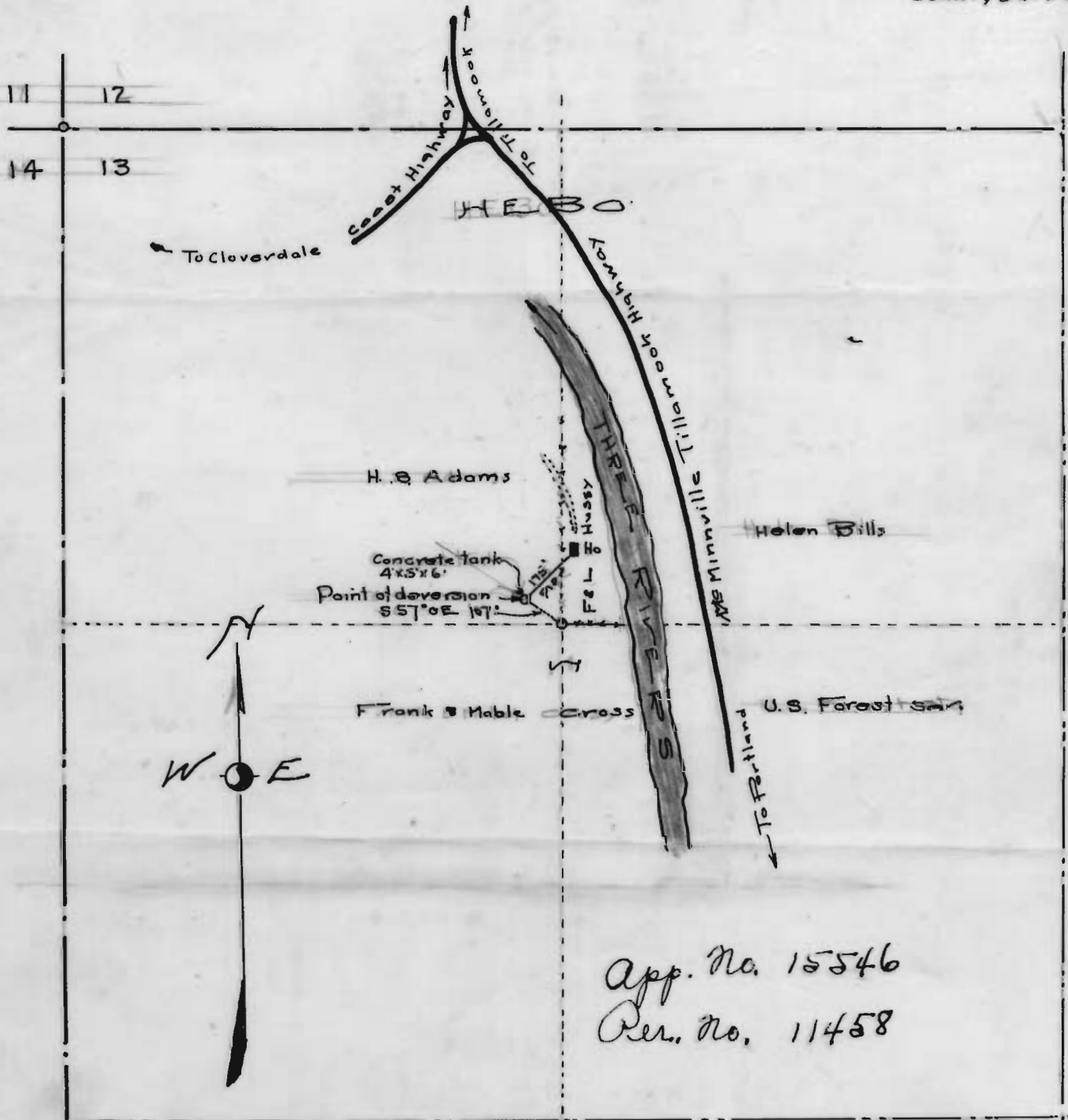

App. No. 15546
Per. No. 11458

RECEIVED

SEP 21 1934

STATE ENGINEER

GLEN, OREGON

WATER RIGHT

FOR

Fred & Harline Hubert, et al

Located in N $\frac{1}{2}$ of the NW $\frac{1}{4}$ Sec 13, T. 4. S. R. 10. W.

W.M. TILLAMOOK COUNTY OREGON

Scale 1" = 400'

W.E. Anderson