

SECTION

2
3
10
11

TOWNSHIP 30 S, RANGE 4 W, W. M.

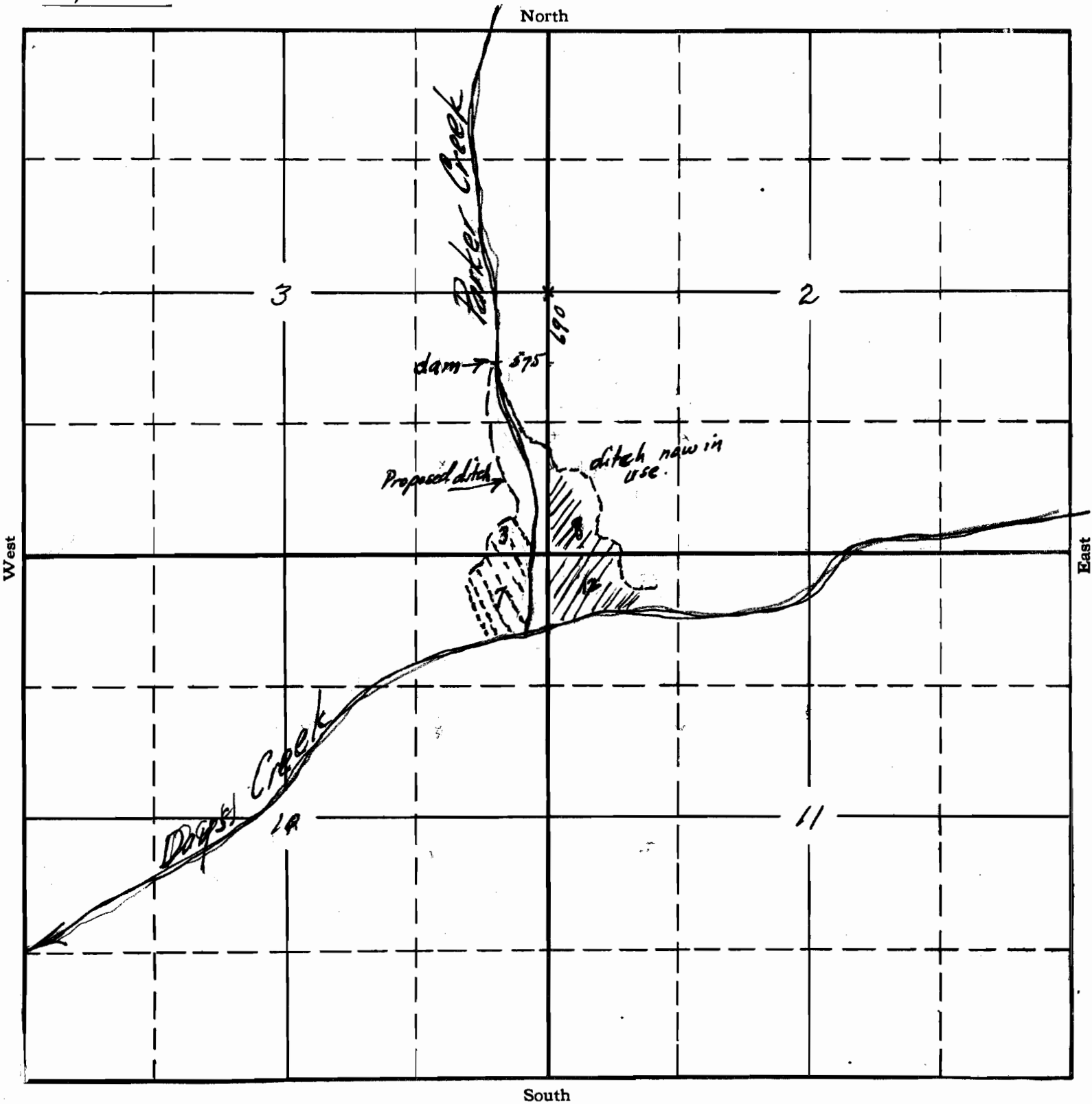

RECEIVED
SEP 17 1934

STATE ENGINEER
SALEM, OREGON

APPLICATION No. 15576
PERMIT No. 11465

SECTION

TOWNSHIP 30S , RANGE 4W , W. M.

North

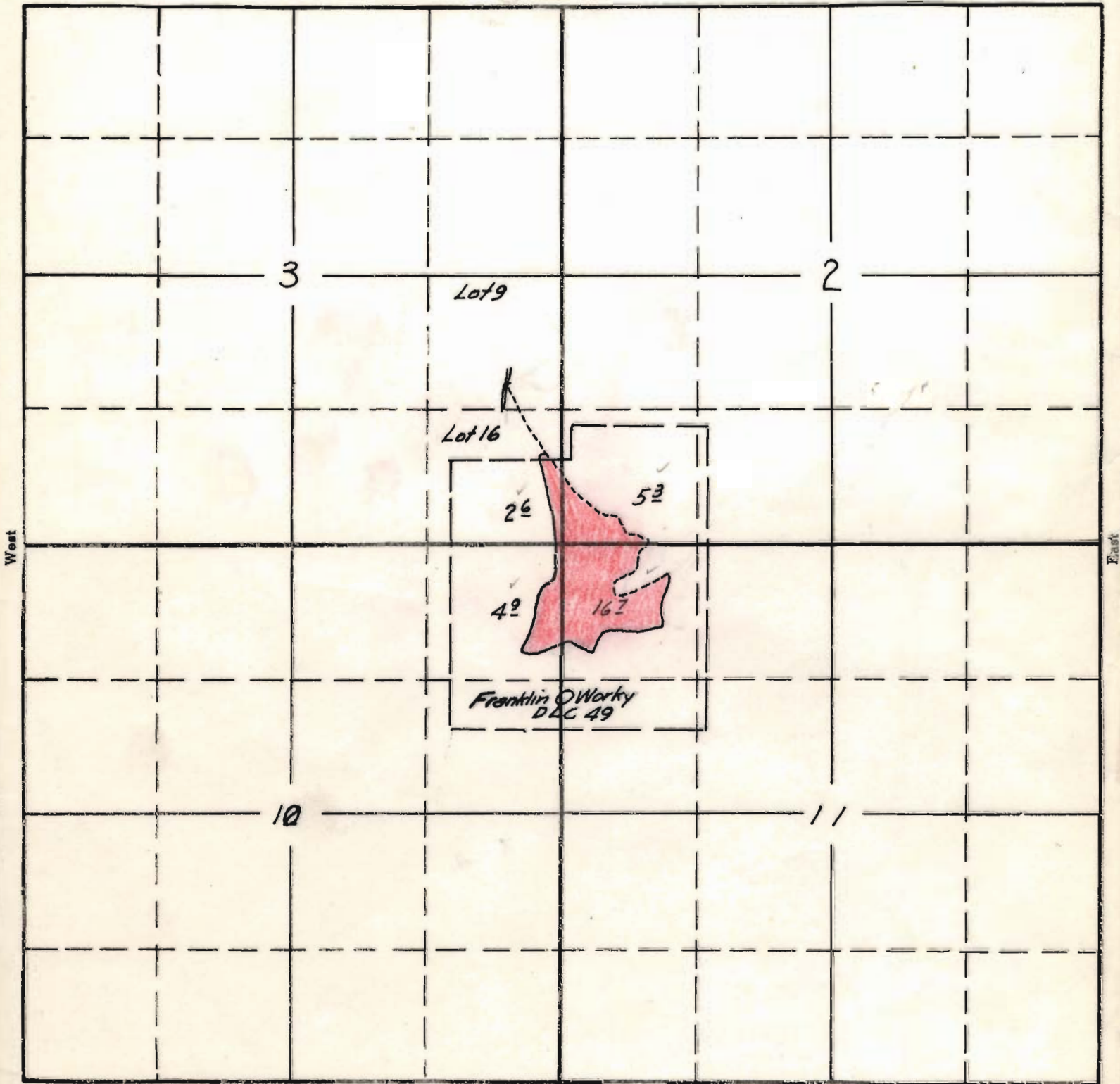

Surveyed July 8, 1940 CAC.

South

APPLICATION No. 15576
PERMIT No. 11465