

Map accompanying application for permit to appropriate water from
Applegate River, by J. V. Ruefely.

Surveyed, Oct, 1911

By M. F. McCann.

Scale: 2 ins = 1 mile.

X ~~Section 16~~

T. 38 S. R. 4 W.

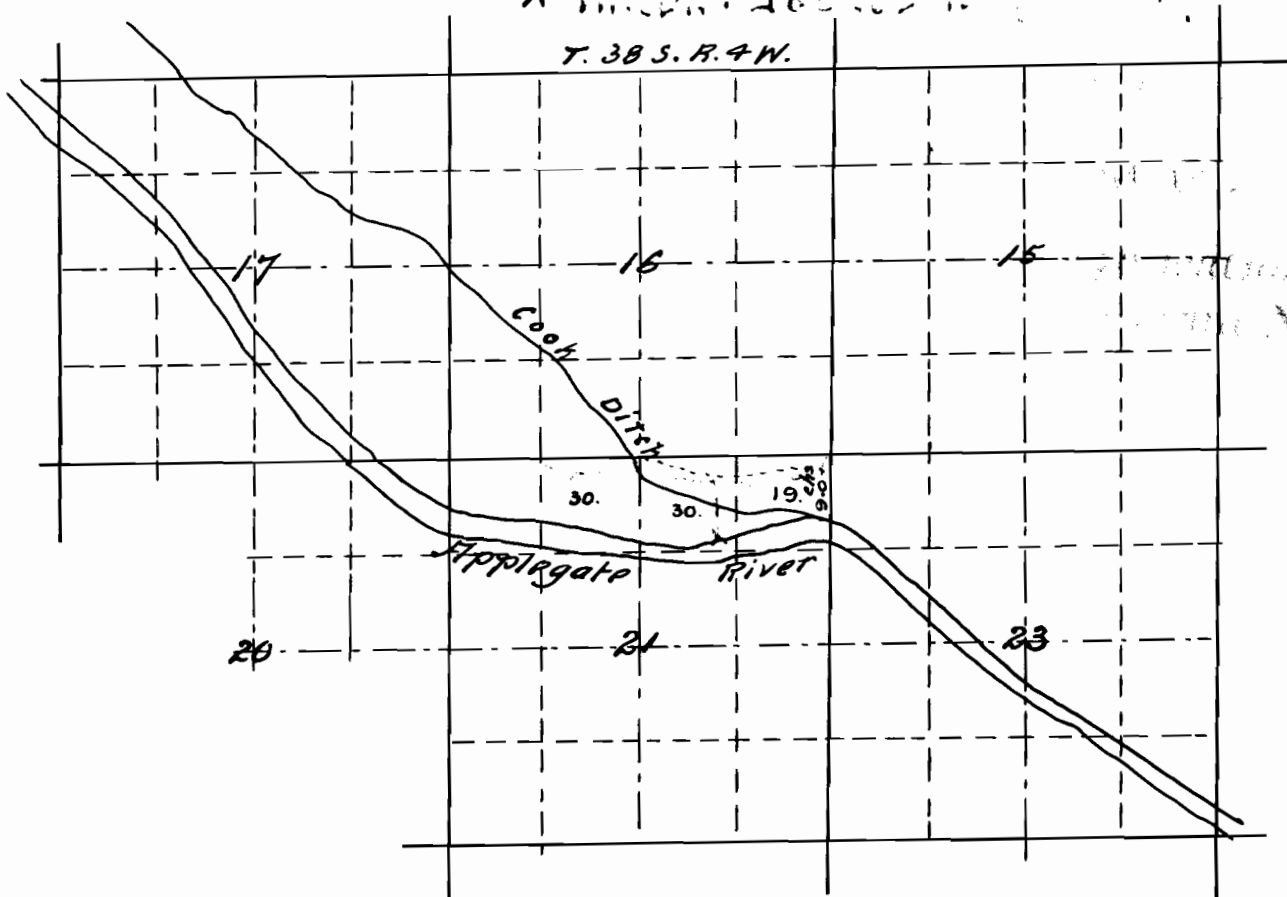

I hereby certify that the above map is a correct representation of a survey
made by me on the ground, Oct. 1911.

M. F. McCann

Surveyor.