

SE, C, L, A

TOWNSHIP 38 & 39 RANGE 2 W., W. M.

North

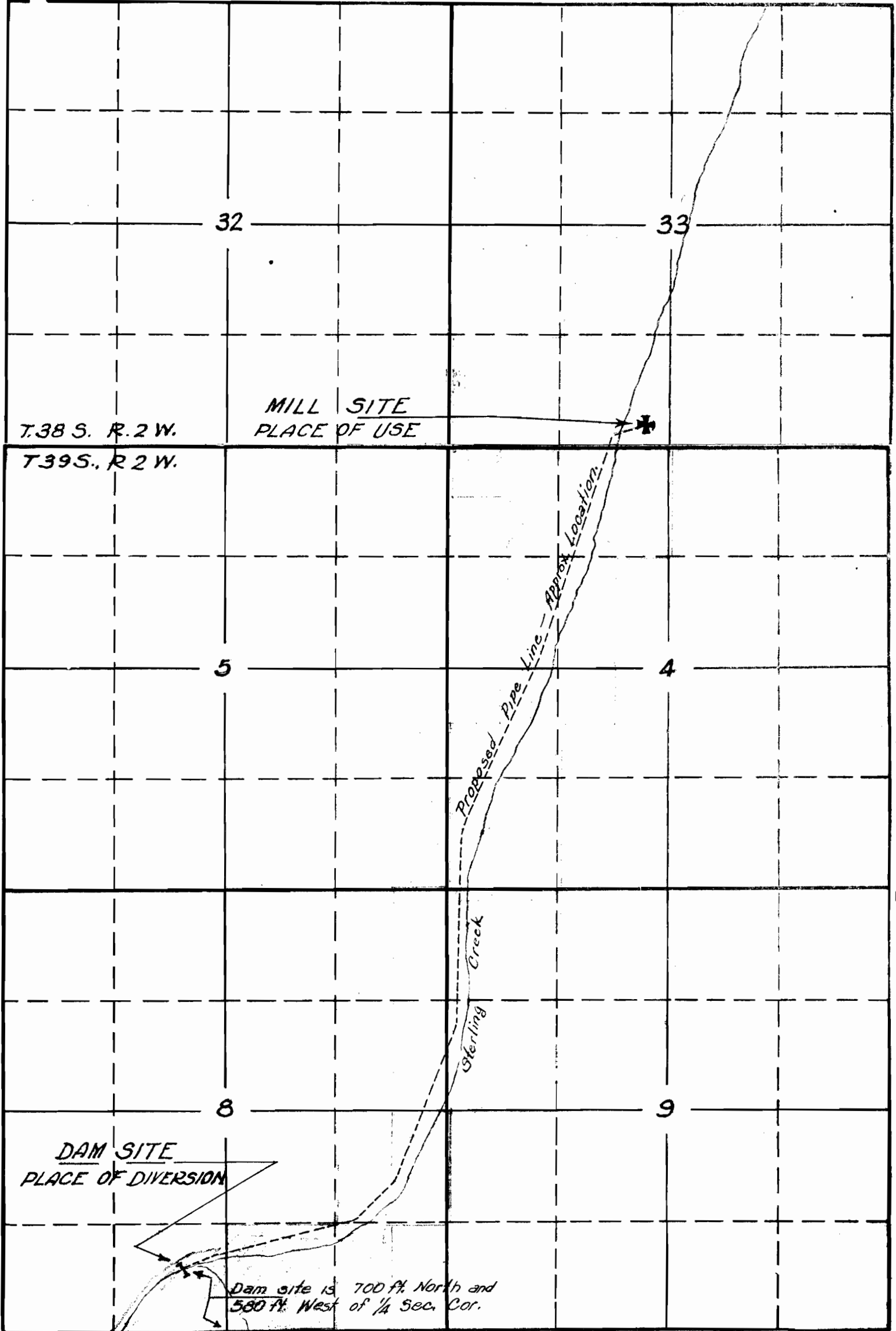

South

APPLICATION No. 15750
PERMIT No. 11612

TOWNSHIP 38 & 39 RANGE 2 W., W. M.

North

32

33

T.38 S. R.2 W.
T.39 S., R.2 W.

MILL SITE
PLACE OF USE

5

4

Proposed Pipe Line - Approx. Location
Sterling Creek

8

9

DAM SITE
PLACE OF DIVERSION

Dam site is 700 ft. North and
580 ft. West of 1/4 Sec. Cor.

South

RECEIVED
MAR 25 1935

APPLICATION No. 15750
PERMIT No. 11612

Amstrang St.