

SECTION

TOWNSHIP 85, RANGE 4 W, W. M.

North

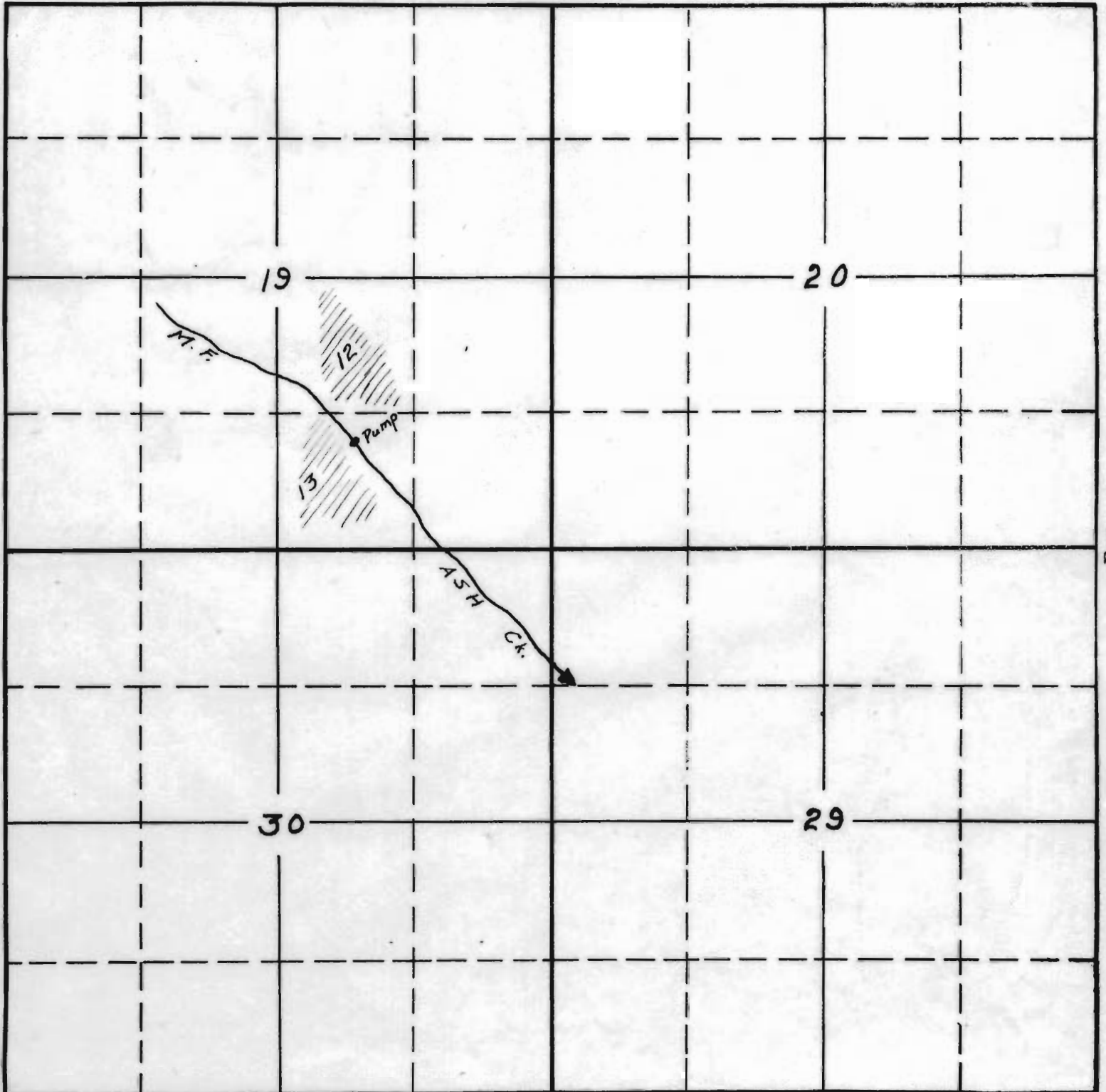

South

*Copied from applicant's
sketch - 4/1/35-*

APPLICATION No. 15757

PERMIT No. 11615

ON

TOWNSHIP 85, RANGE 4W, W. M.

North

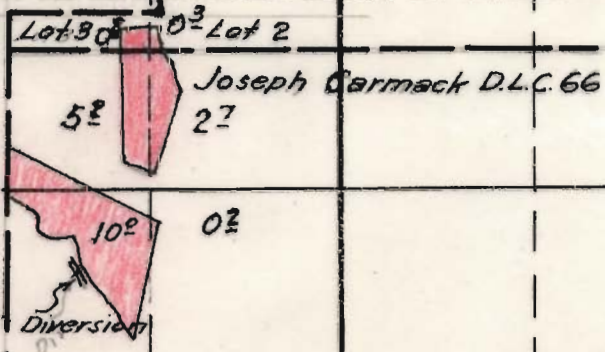

19

20

West

East

South

Surveyed by C.A.G.
Apr 3 1939

APPLICATION No. 15757
PERMIT No. 11615