

SECTION

TOWNSHIP 39.5, RANGE 1 W, W. M.

RECEIVED
MAY 31 1935

STATE ENGINEER
SALEM, OREGON

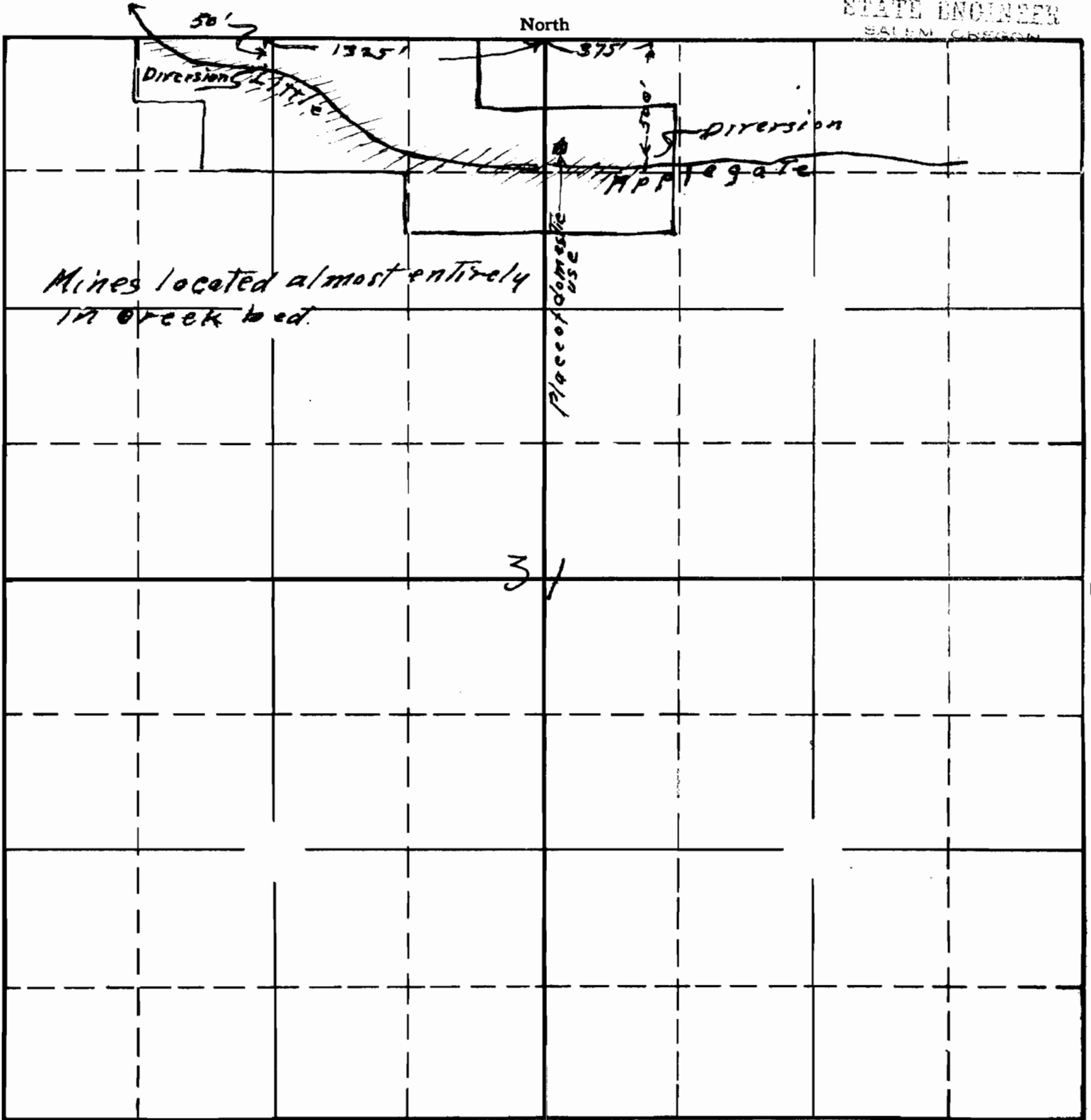

Map to accompany application of
 Probt L Taylor for the use of the waters
 of the Little Applegate for mining and
 domestic purposes
 Made from measurements in the field by R.L.T.

APPLICATION No. 15848
 11691
 PERMIT No. ↗