

MAP
 ACCOMPANYING APPLICATION OF THE CROSS
 COUNTRY CANAL COMPANY OF LOSTINE, OREGON
 FOR A PERMIT TO APPROPRIATE WATER.
 WALLOWA COUNTY, OREGON

Scale: 4" = 1 Mile

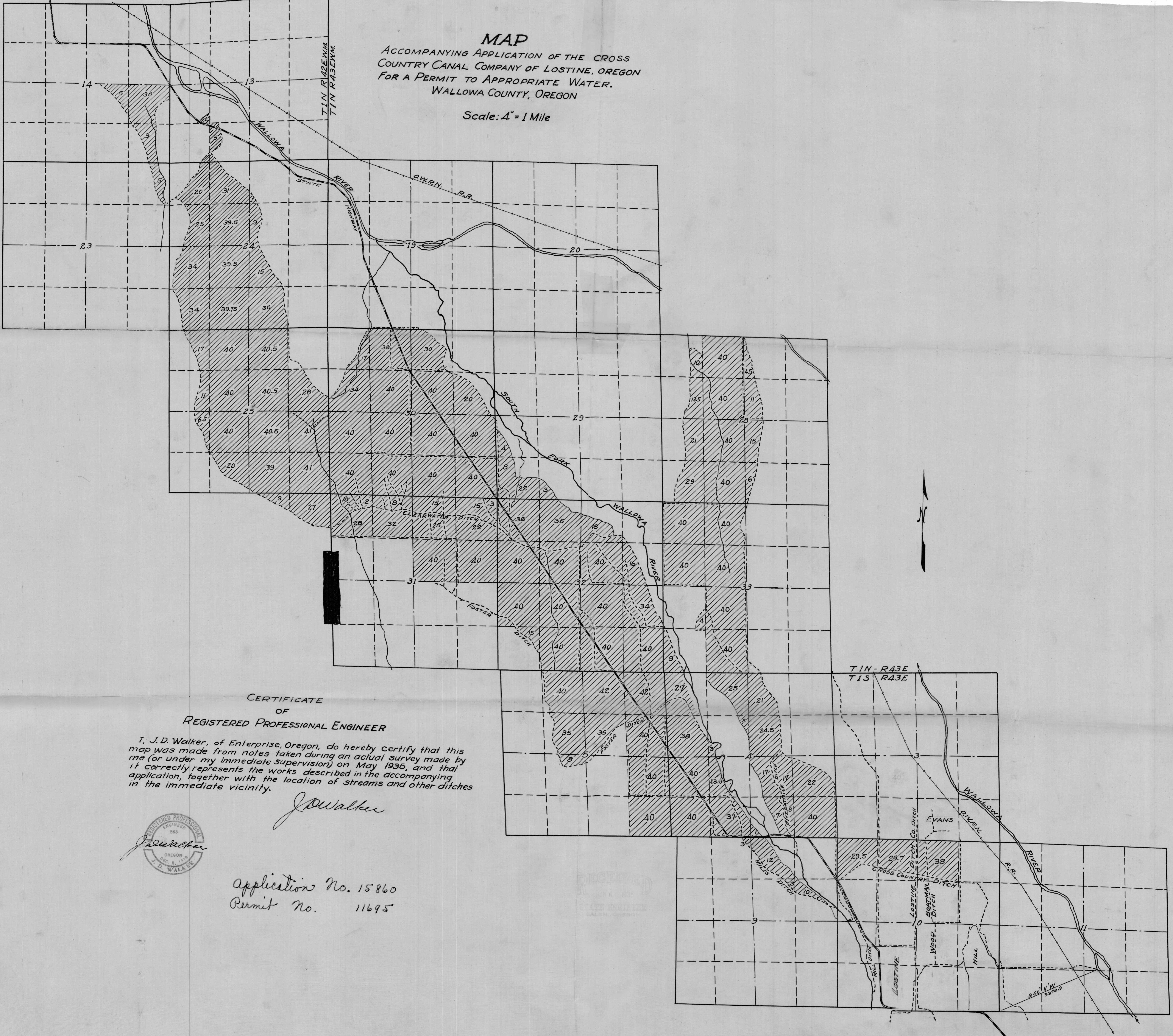

CERTIFICATE
 OF
 REGISTERED PROFESSIONAL ENGINEER

I, J. D. Walker, of Enterprise, Oregon, do hereby certify that this map was made from notes taken during an actual survey made by me (or under my immediate supervision) on May 1935, and that it correctly represents the works described in the accompanying application, together with the location of streams and other ditches in the immediate vicinity.

J. D. Walker

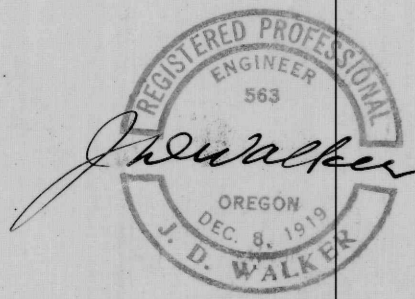

Application No. 15860
 Permit No. 11695