

SECTION

TOWNSHIP **4S**, RANGE **3E**, W. M.

North

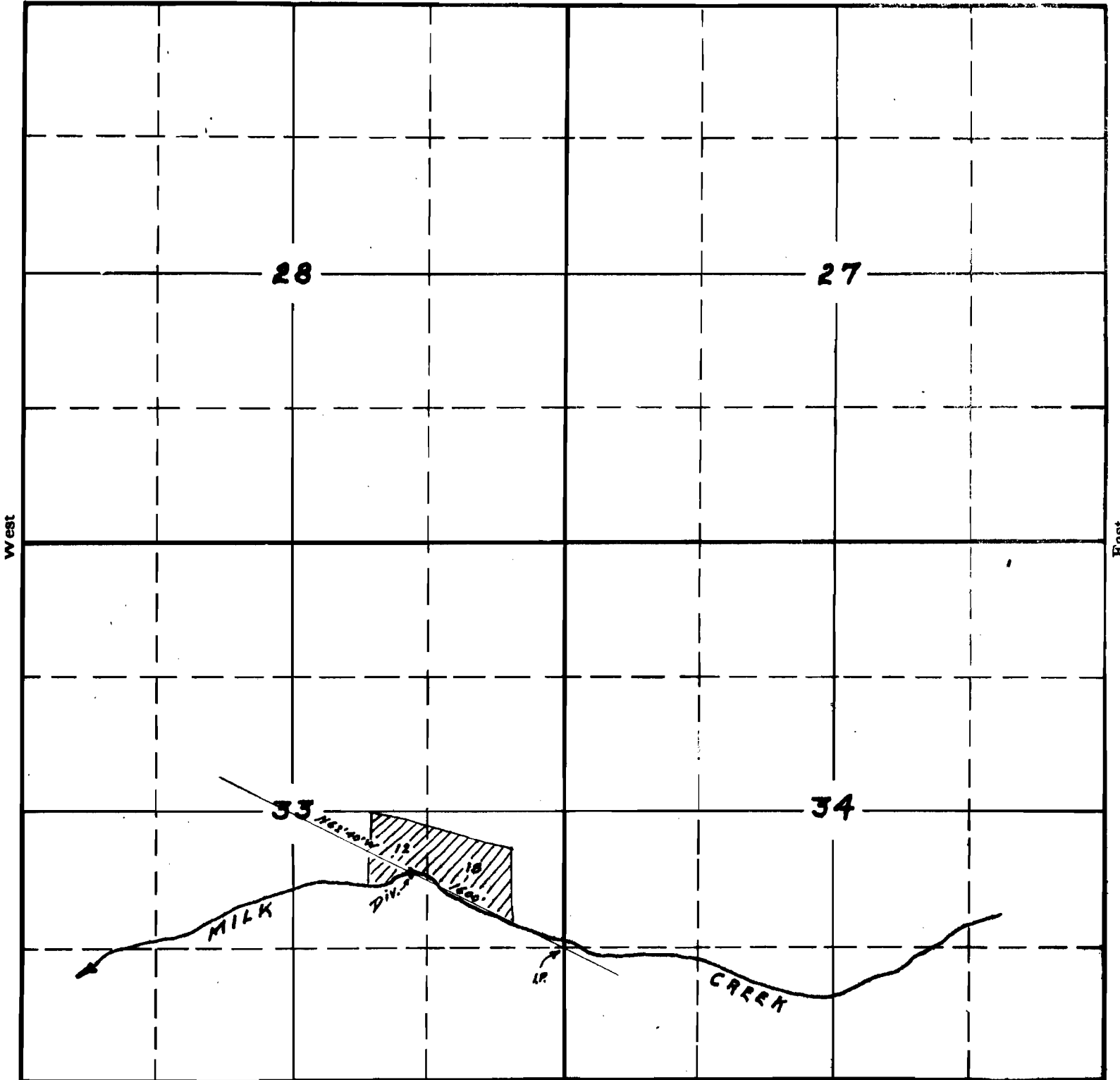

South

*Copied from applicants
 sketch - 7/20/35 -
 Corrected - 9/27/35 -*

2-32A- *OK* -
 APPLICATION No. **15946**
 PERMIT No. **11787**

SECTION

TOWNSHIP 4S , RANGE 3E., W. M.

North

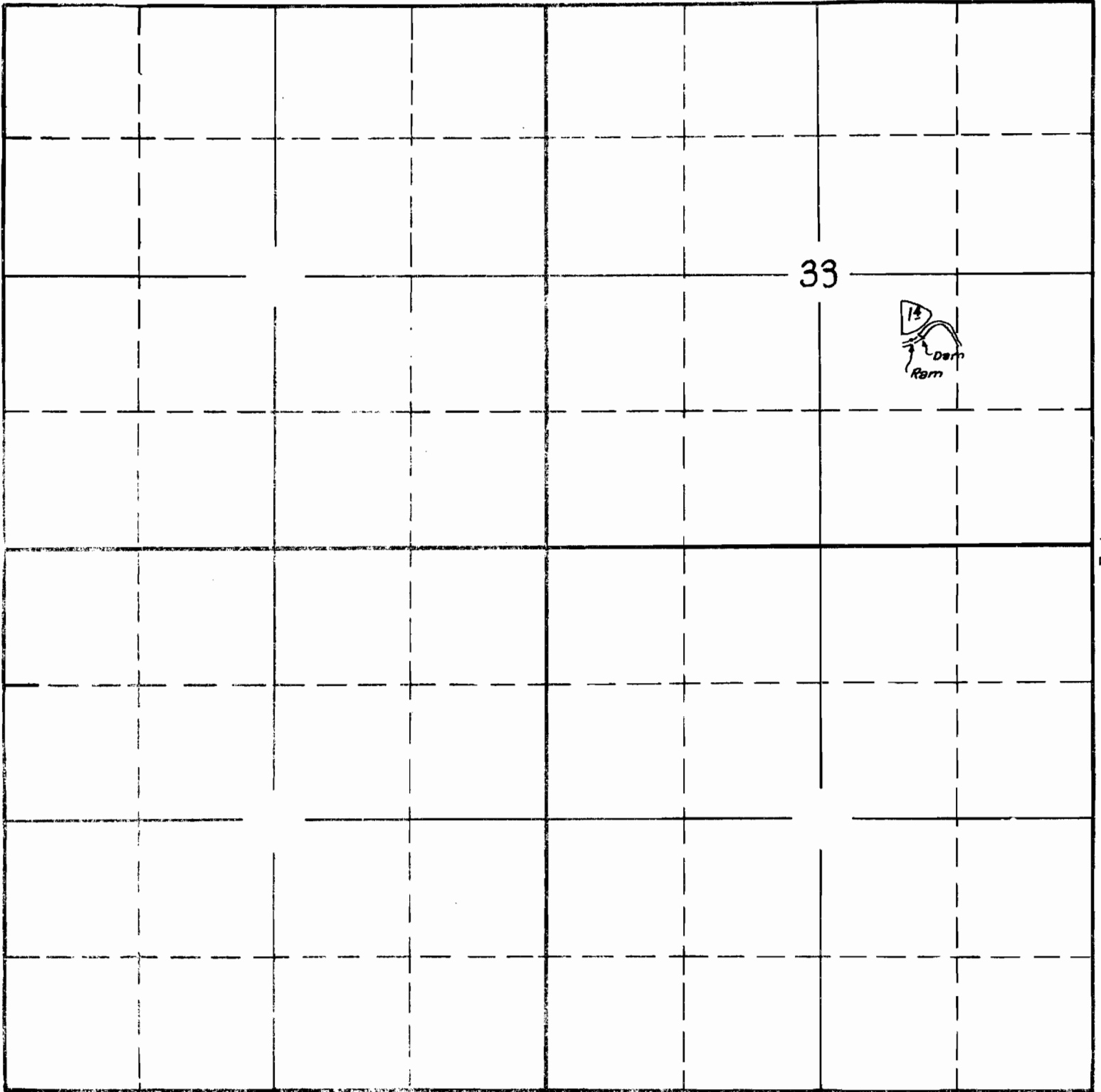

33

1 1/2
Darn
Ramp

West

East

South

Surveyed by
C.A. Cummings
Apr 10 1939

APPLICATION No. 15948

PERMIT No. 11787

SECTION

TOWNSHIP 45, RANGE 3E, W. M.

North

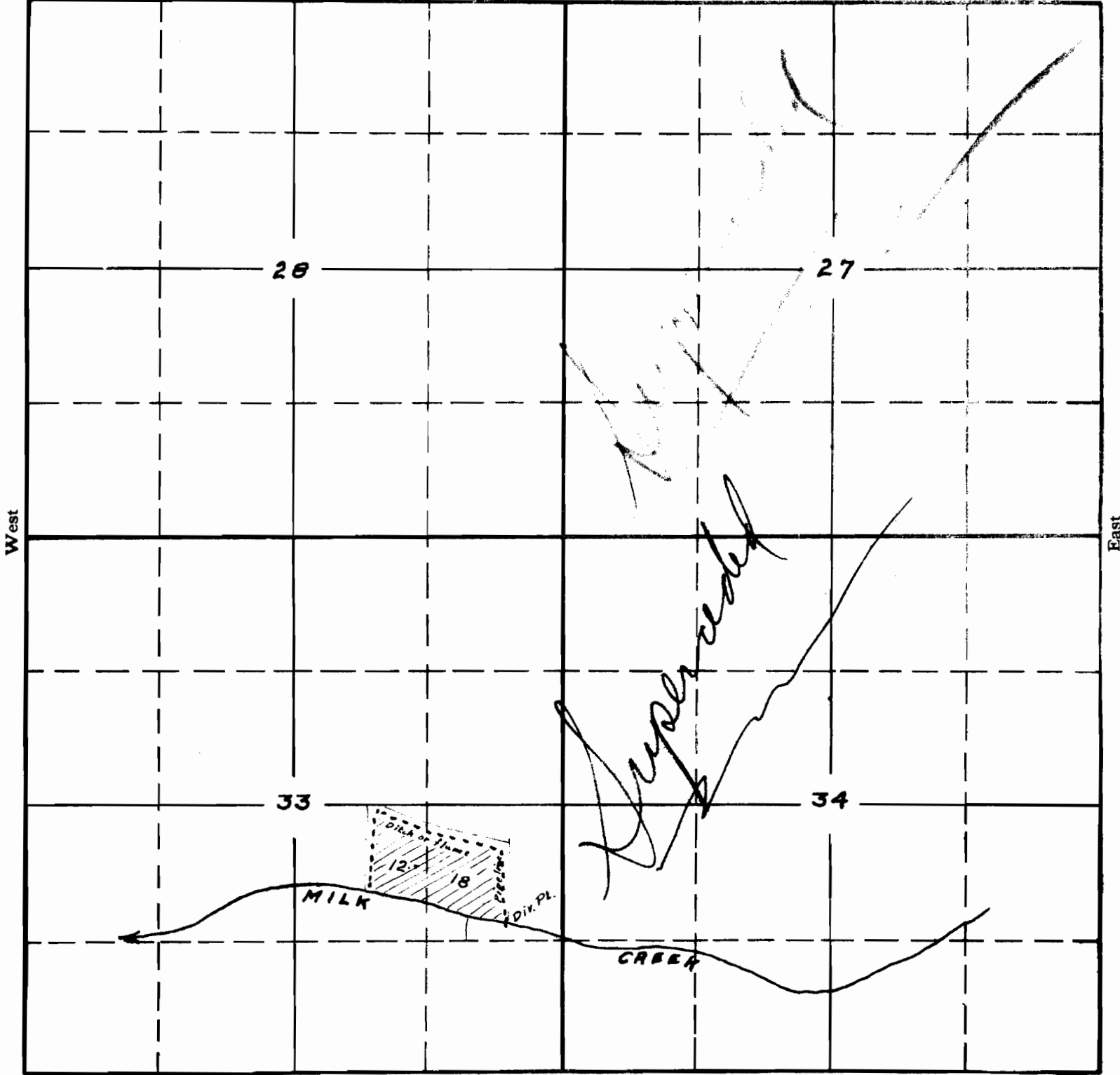

South

Copied from applicant's sketch - 7/20/35-

2-32A-^{ck}

APPLICATION No. 15948

PERMIT No. 11787