

TOWNSHIP 12 S , RANGE 5 W , W. M.

North

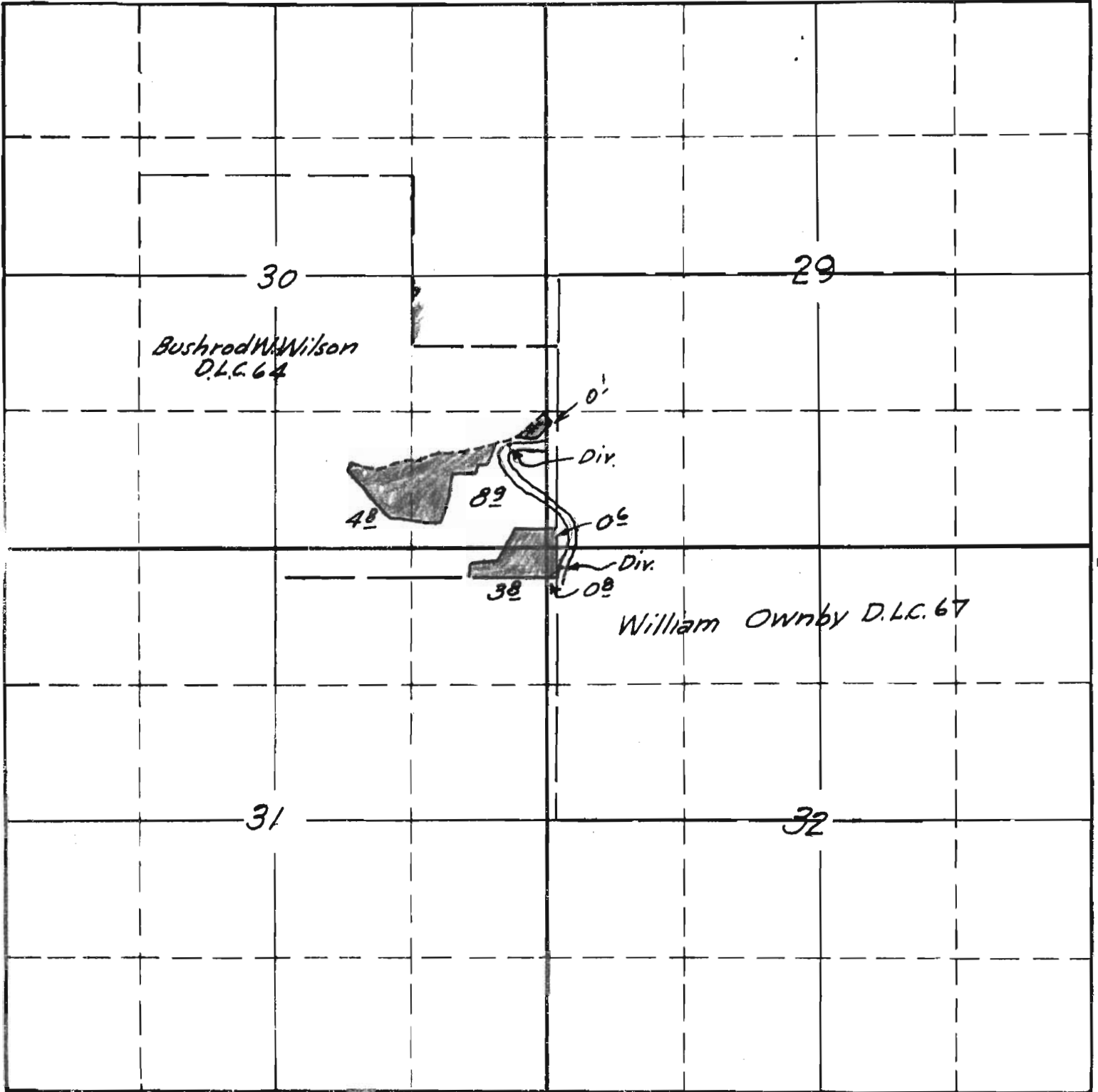

West

East

South

Surveyed July 23 1940 C.A.C.

APPLICATION No. 15979

PERMIT No. 11806

30
31
32

TOWNSHIP 12 S, RANGE 5 W, W. M.

North

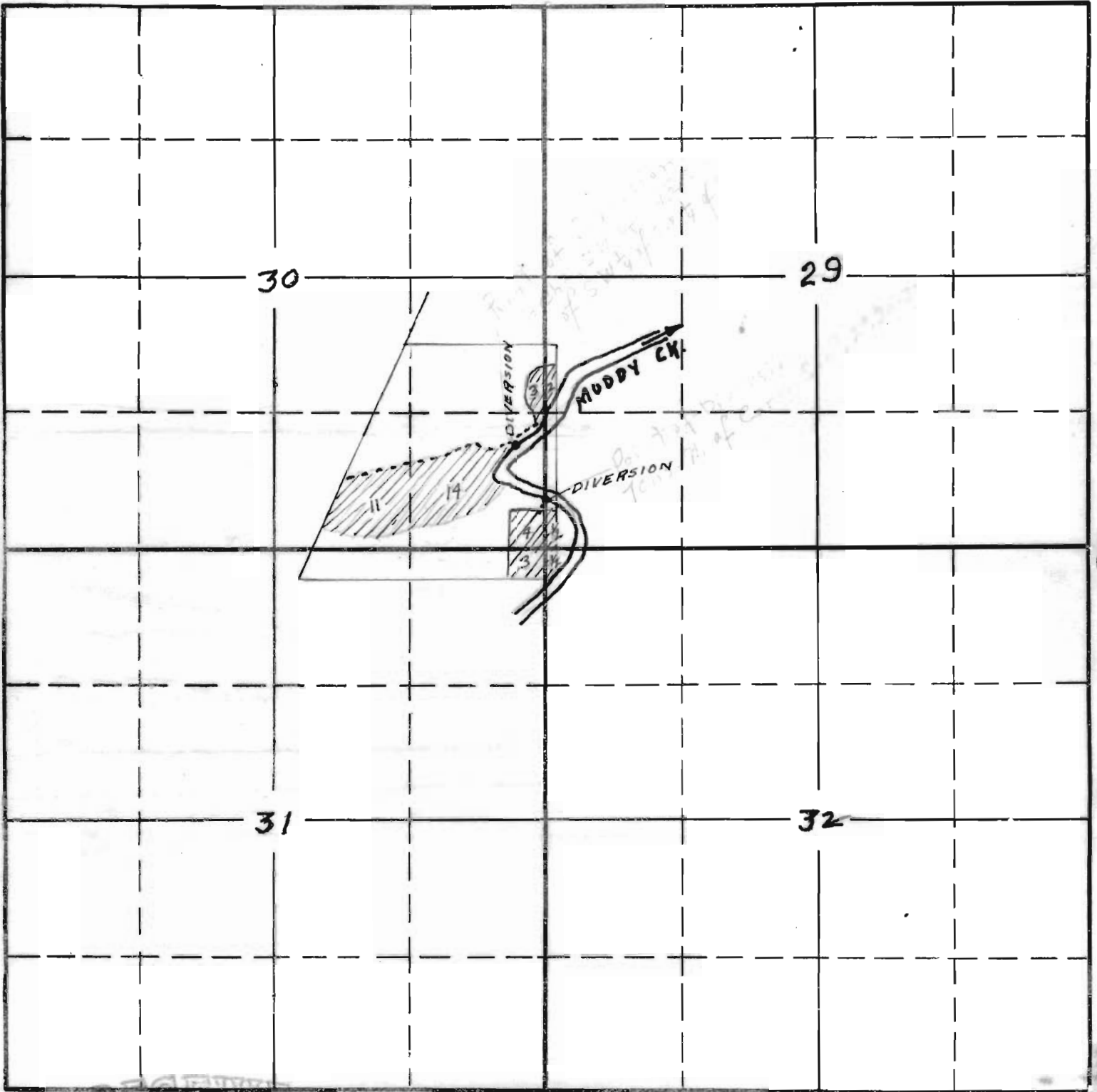

South

RECEIVED

AUG 9 1935

STATE ENGINEER
SALEM, OREGON

2-22-15979

APPLICATION No. 15979

PERMIT No. 11806