

S-1197

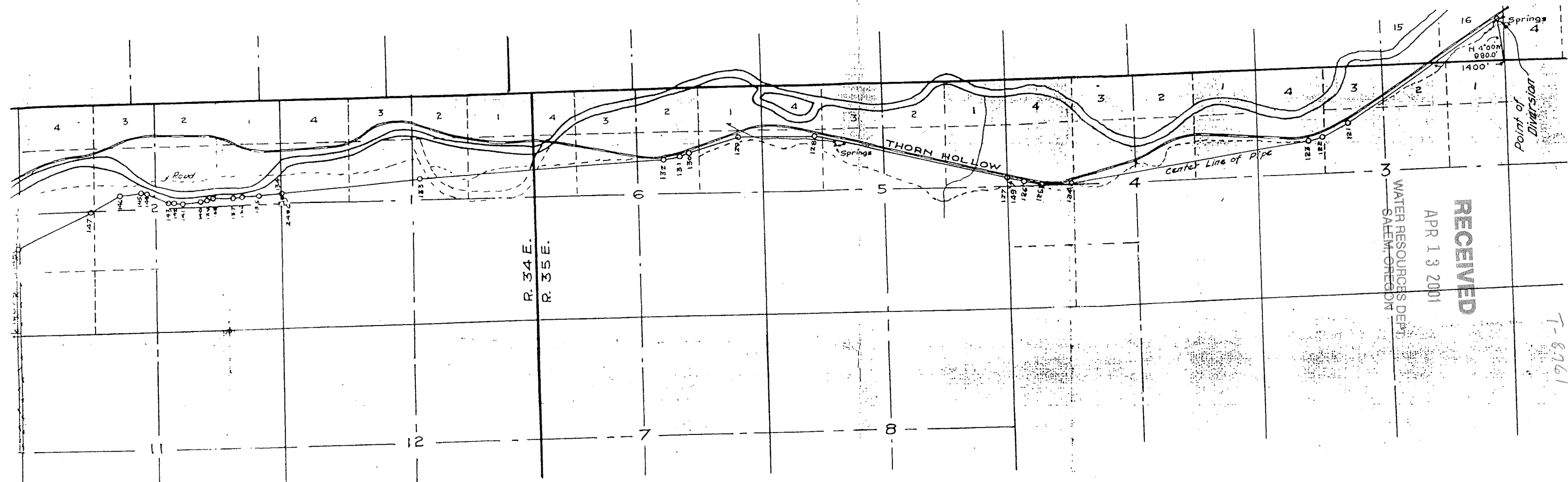

RECEIVED
 APR 13 2001
 WATER RESOURCES DEPT.
 SALEM, OREGON

T-8761

I, Frank C. Kelsey, of Portland, Oregon, do hereby certify that this map was made from notes taken during an actual survey made under my immediate supervision on August, 22, 1910 to October, 8, 1910, and that it correctly represents the works described in the accompanying application, together with the location of streams.

Frank C. Kelsey
 Surveyor.

PENDLETON CITY WATERWORKS

MAP OF PIPE LINE

FROM
 SPRINGS IN SECS. 34 & 35
 TOWN. 3 N. RANGE 35 E. W. M.
 TO
 PENDLETON

MAY 5, 1912.

SCALE: 1 IN. = 2000 FT.

FRANK C. KELSEY
 CIVIL ENGINEER
 PORTLAND, ORE.

S-1197

STATE OF OREGON

MAY 20 1912

Commissioner of State Lands