

SECTION

TOWNSHIP 7135, RANGE 711, W. M.

North

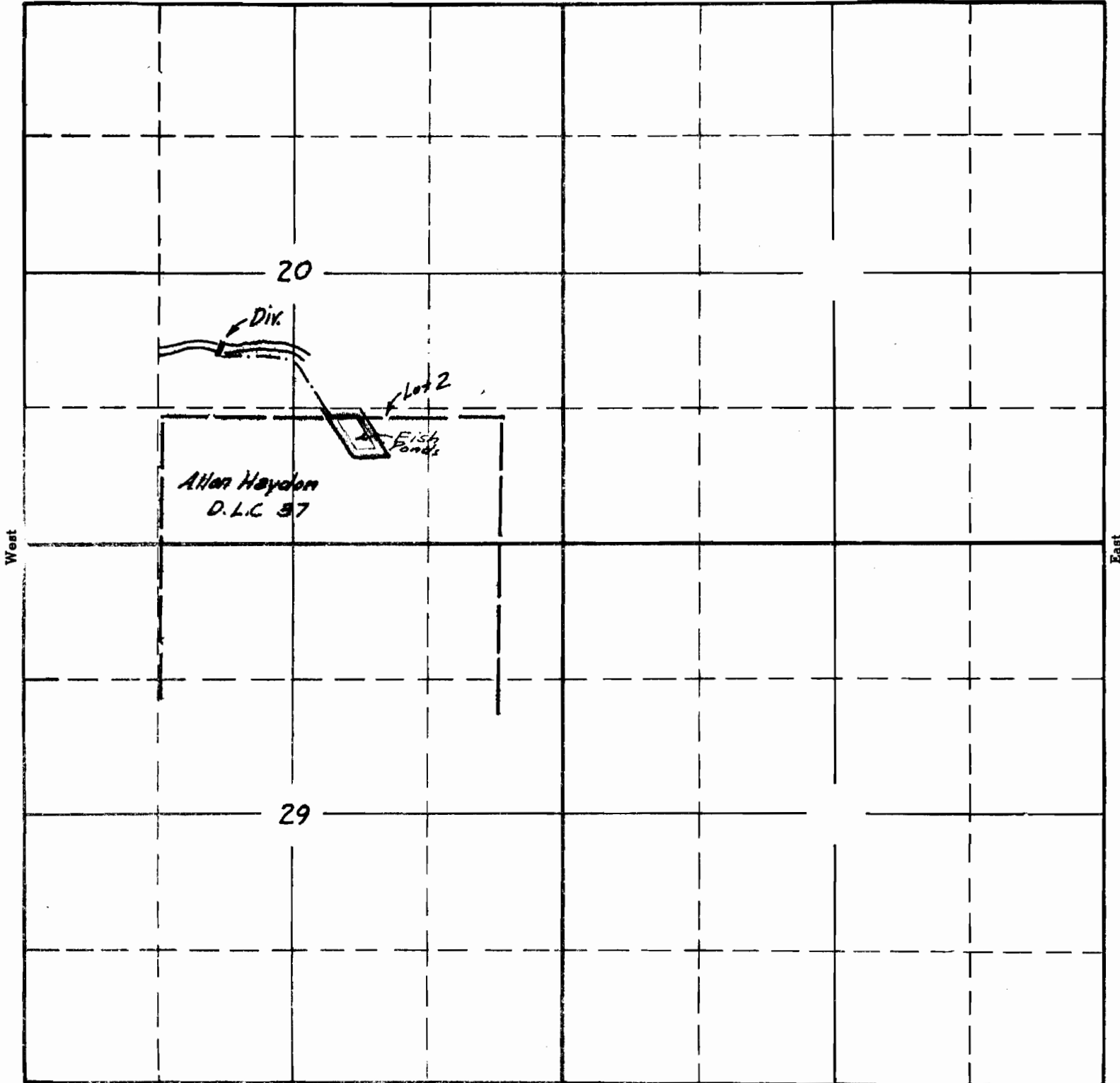

Surveyed July 23 1940 C.A.C.

South

APPLICATION No. 15241

PERMIT No. Y2036

20

1473.1'

1/4 Sec. Corner

1" Axle

North 1429.9'

1 1/8" Axle

North 597.8'

East 541.3'

HEADGATE

PIPE LINE

4751' NW 1/4 E

3281.1' to NE cor. Claim
1615.2' to Pipe Line

W-621.3'

157.6011

Stone NE Corner D.L.C. #37



NORTH FORK ALSA RIVER

2116.8'

OREGON STATE GAME COMMISSION
Portland Oregon

Sec. 20

Sec. 21

Stone

Sec. 29

Sec. 28

App. No. 15241
Per. No. 12036

A-15241
P.

Twp. 13 S.
Rge. 7 W. W.M.