

T. I. S.

R. A. W.

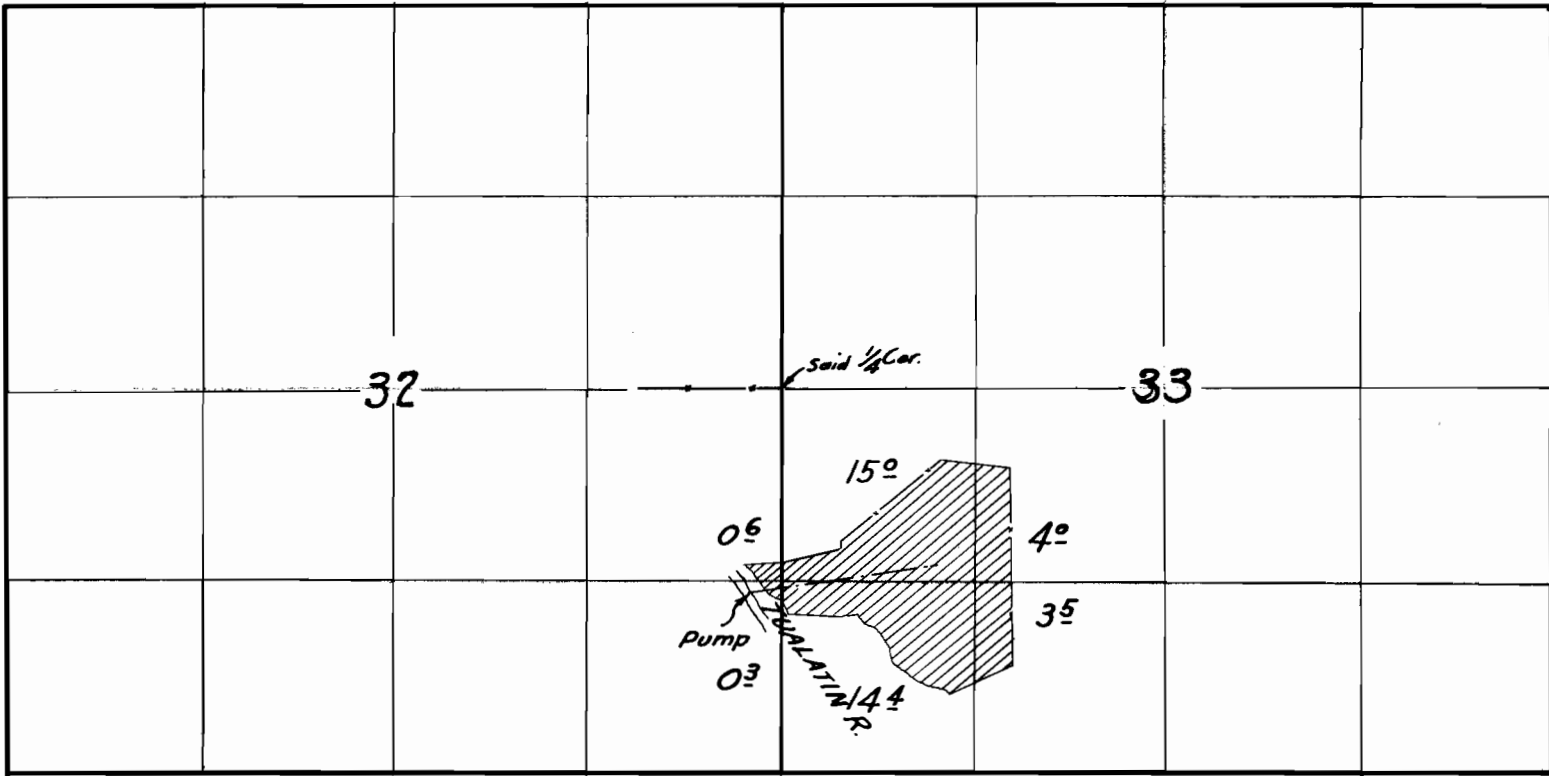

Surveyed Aug. 14, 1941
C. A. Cummings

App. 16281
Per. 12113

SECTION

32

33

TOWNSHIP 15, RANGE 4W, W. M.

North

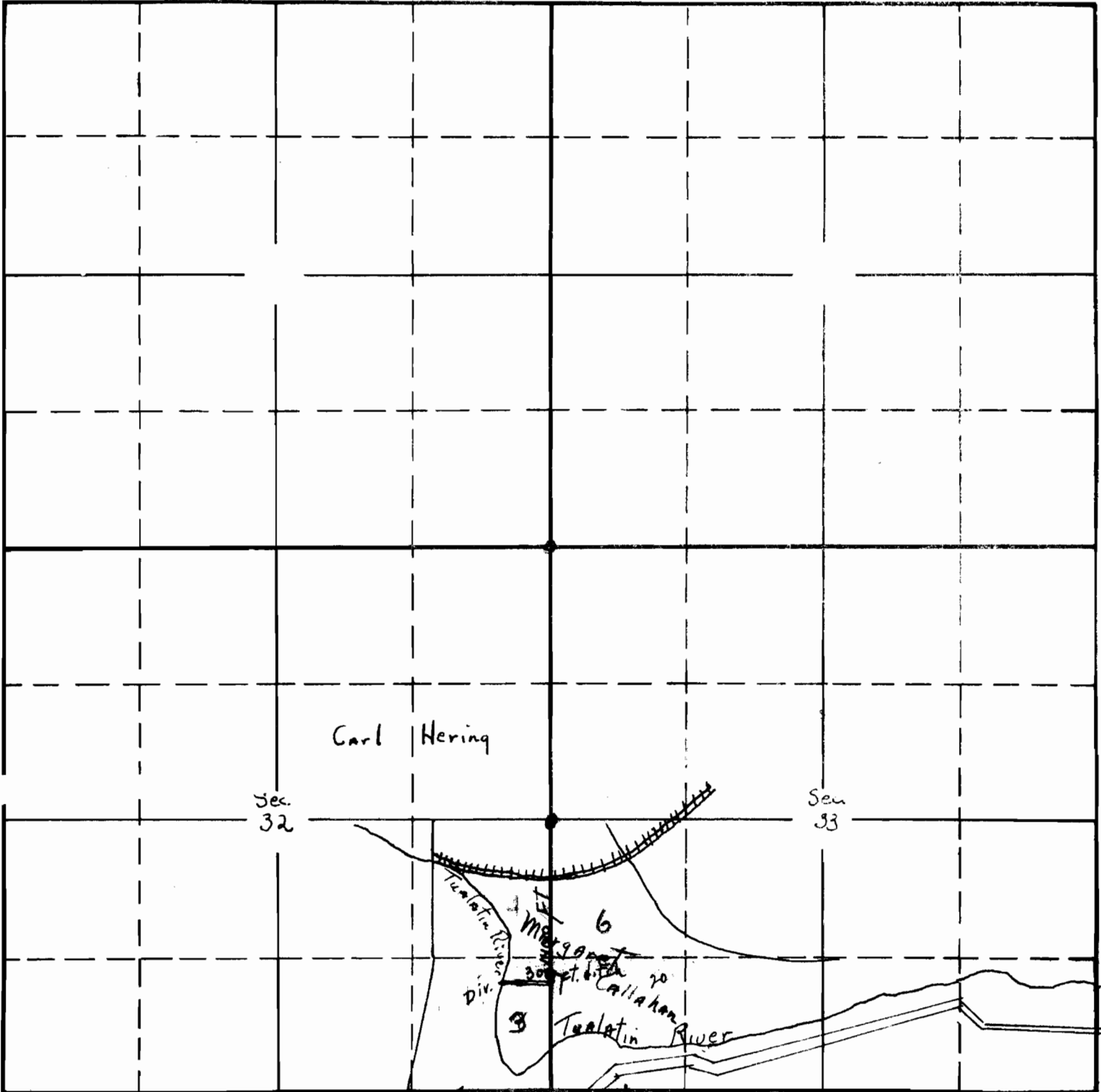

Carl Hering

Sec. 32

Sec. 33

Tualatin River
Div.

Margarita
300 ft. ditch

6

Callahan

Tualatin River

South Road

The land indicated red is that which is to be irrigated.

There is 100 ft. of pipe from the Tualatin River and then 300 ft. of ditch

APPLICATION No. 16281

PERMIT No. 12113