

SECTION  
34

TOWNSHIP 67, RANGE 35 E.W. M.

North

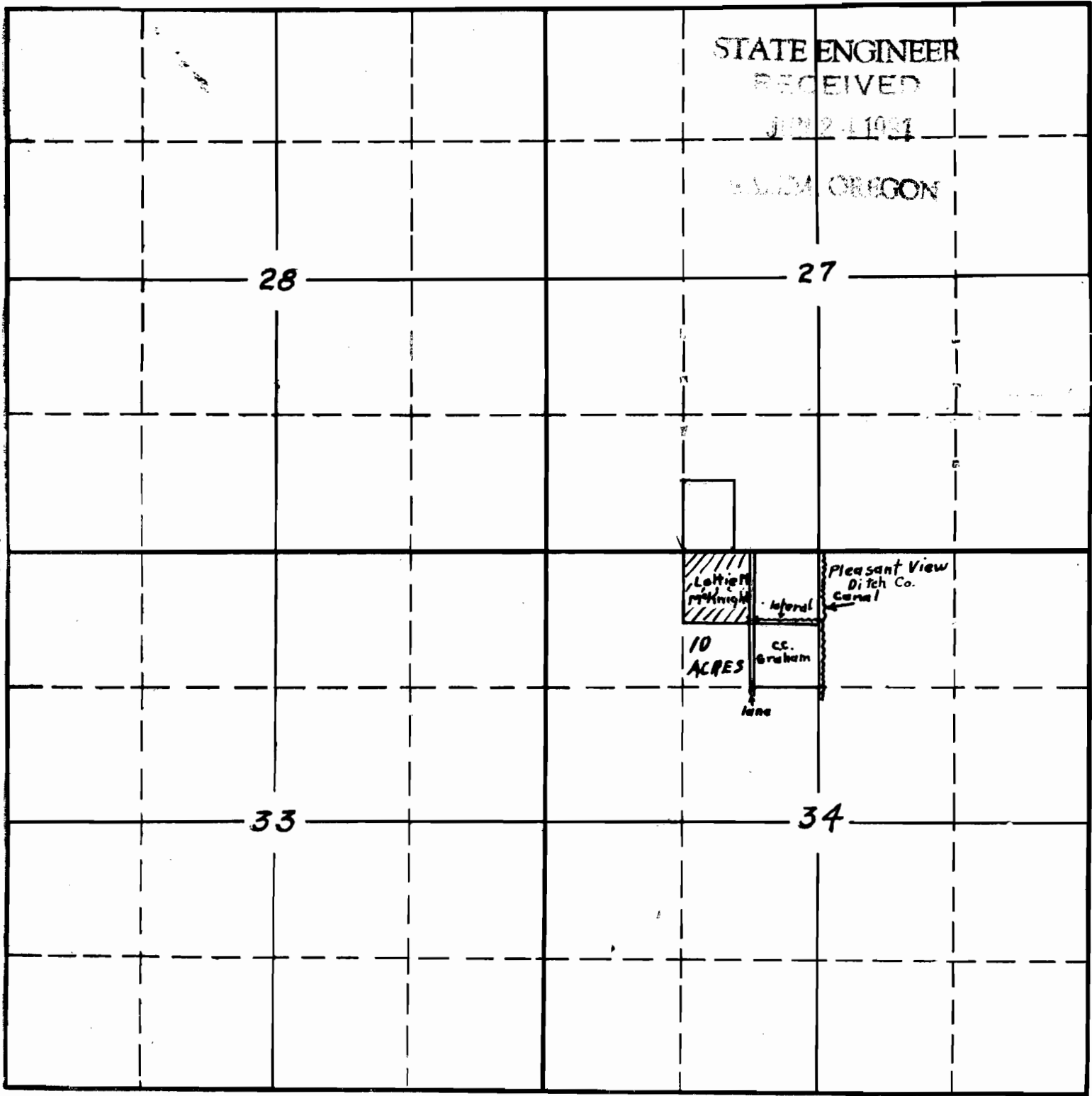

STATE ENGINEER  
RECEIVED  
JUN 24 1981  
WALDA, OREGON

28

27

33

34

Lottier  
right-of-way

10  
ACRES

cc.  
Graham

Pleasant View  
Ditch Co.  
Canal

lane

7-22-81  
APPLICATION No. 14158  
PERMIT No. 12153