

SECTION

3
10

TOWNSHIP 12S, RANGE 5W, W. M.

North

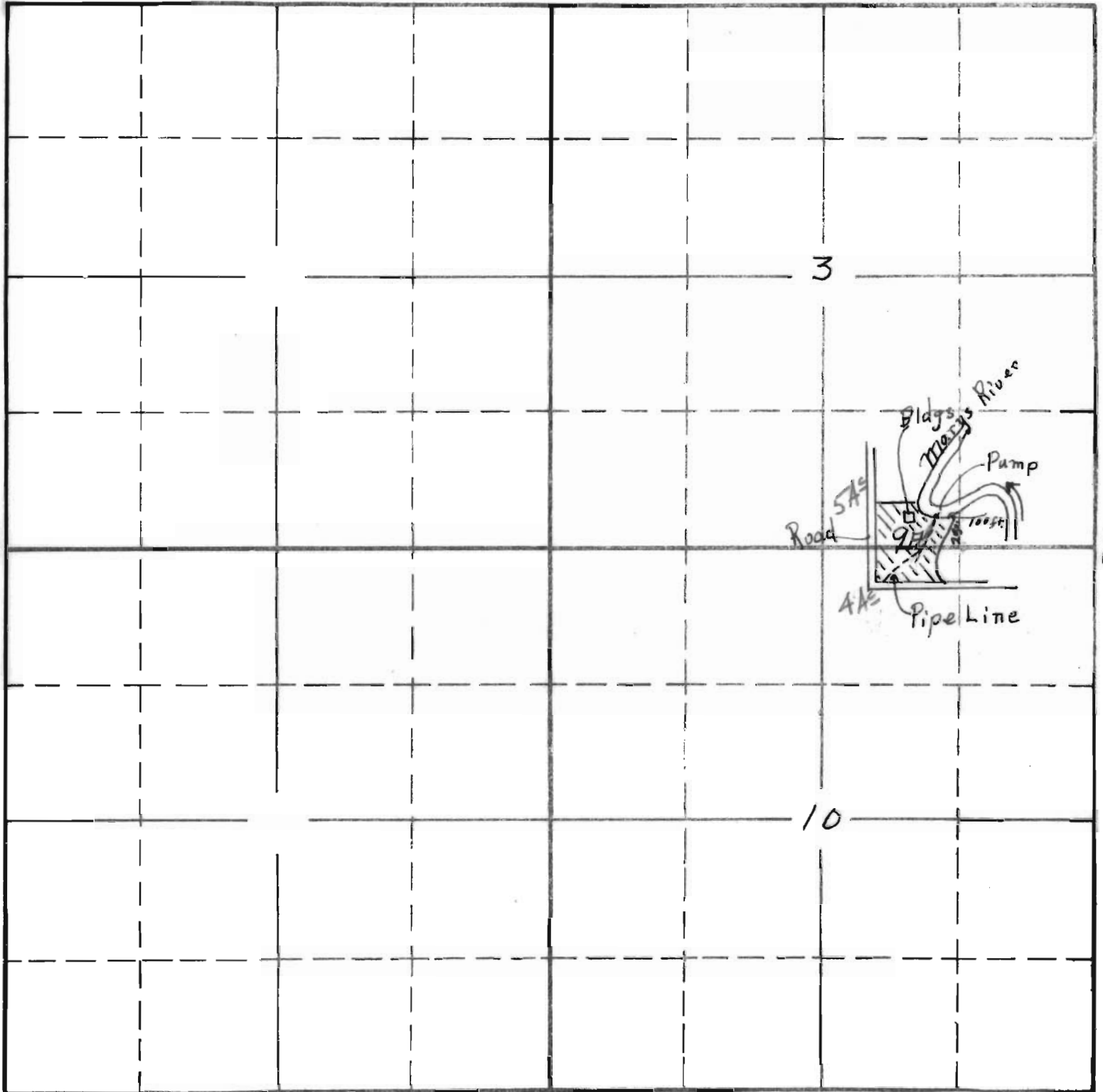

West

East

South

RECEIVED
 JUN 25 1936
 STATE ENGINEER
 SALEM, OREGON

2-19-16435
 APPLICATION No. 16435
 PERMIT No. 12234

SECTION

TOWNSHIP 125 , RANGE 5W , W. M.

North

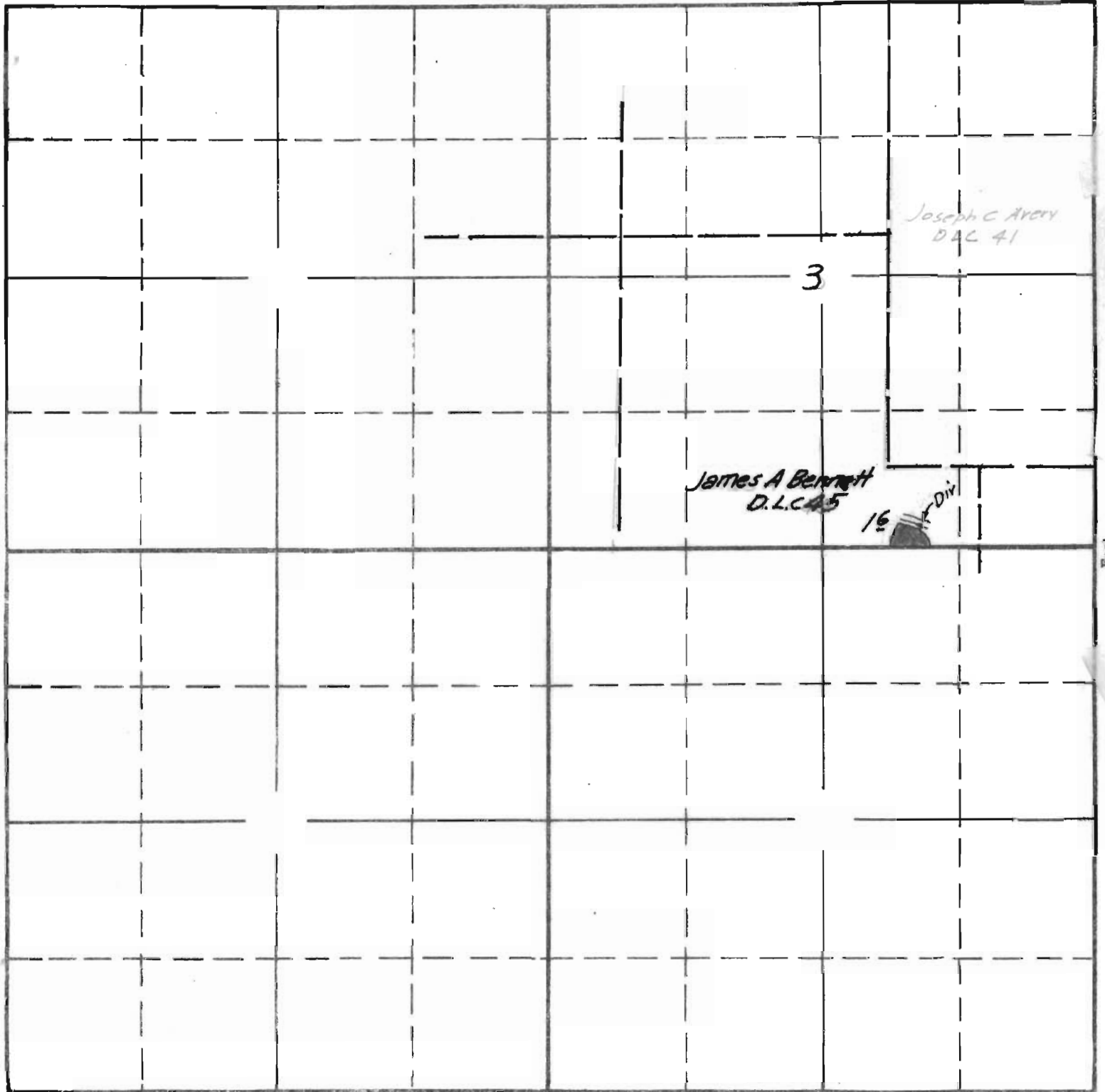

West

East

Surveyed July 23 1940 C.A.C.

South

APPLICATION No. 16435

PERMIT No. 12234