

TOWNSHIP 39^S, RANGE 3^W, W. M.

North

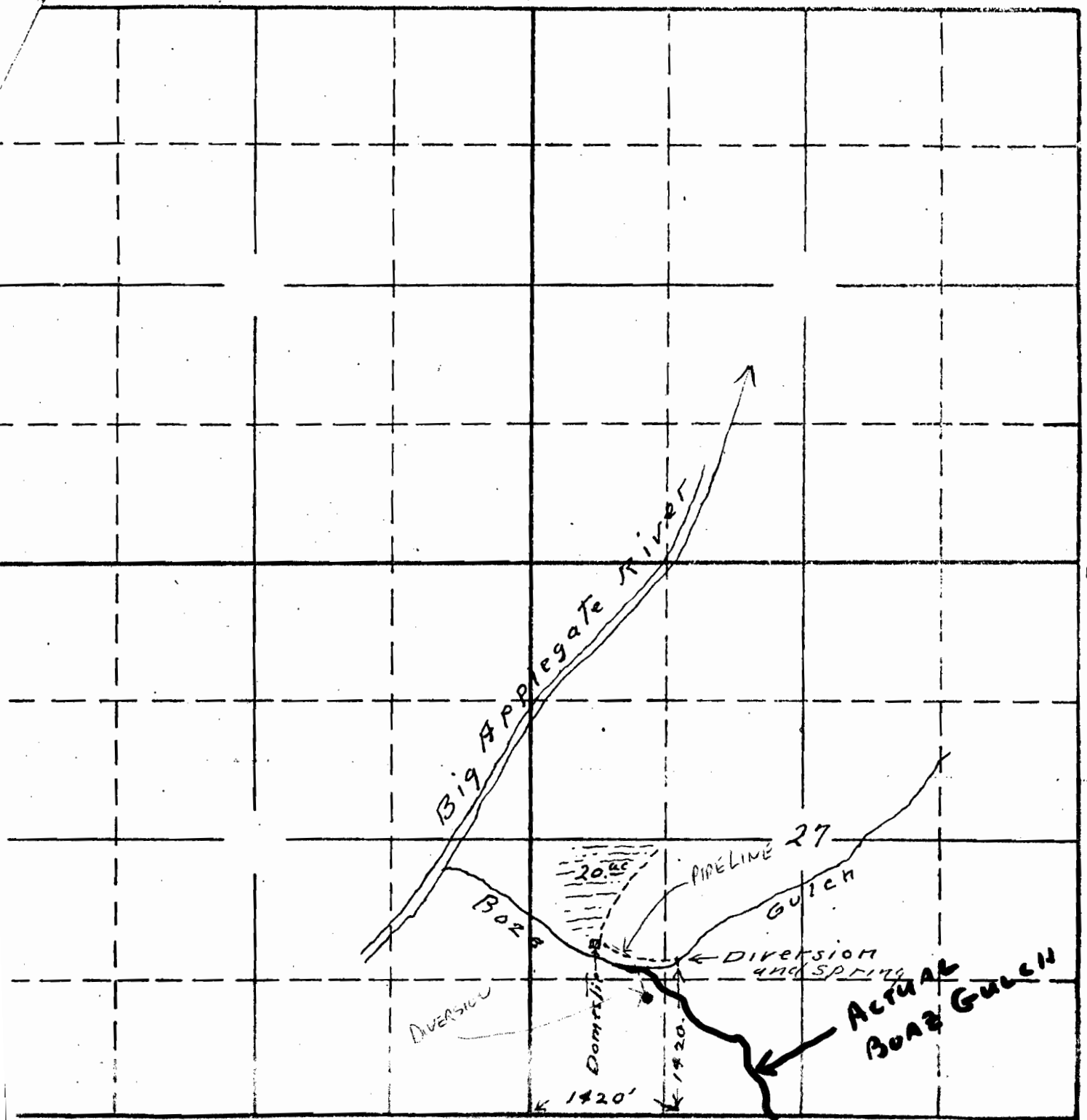

East

South

sketch To accompany application of
 V B Harlow for the use of the waters
 of Boze Gulch and spring in this gulch
 + point of diversion

APPLICATION No. 16470
 PERMIT No. 12265

TOWNSHIP 39-S, RANGE 3 W, W. M.

North

West

East

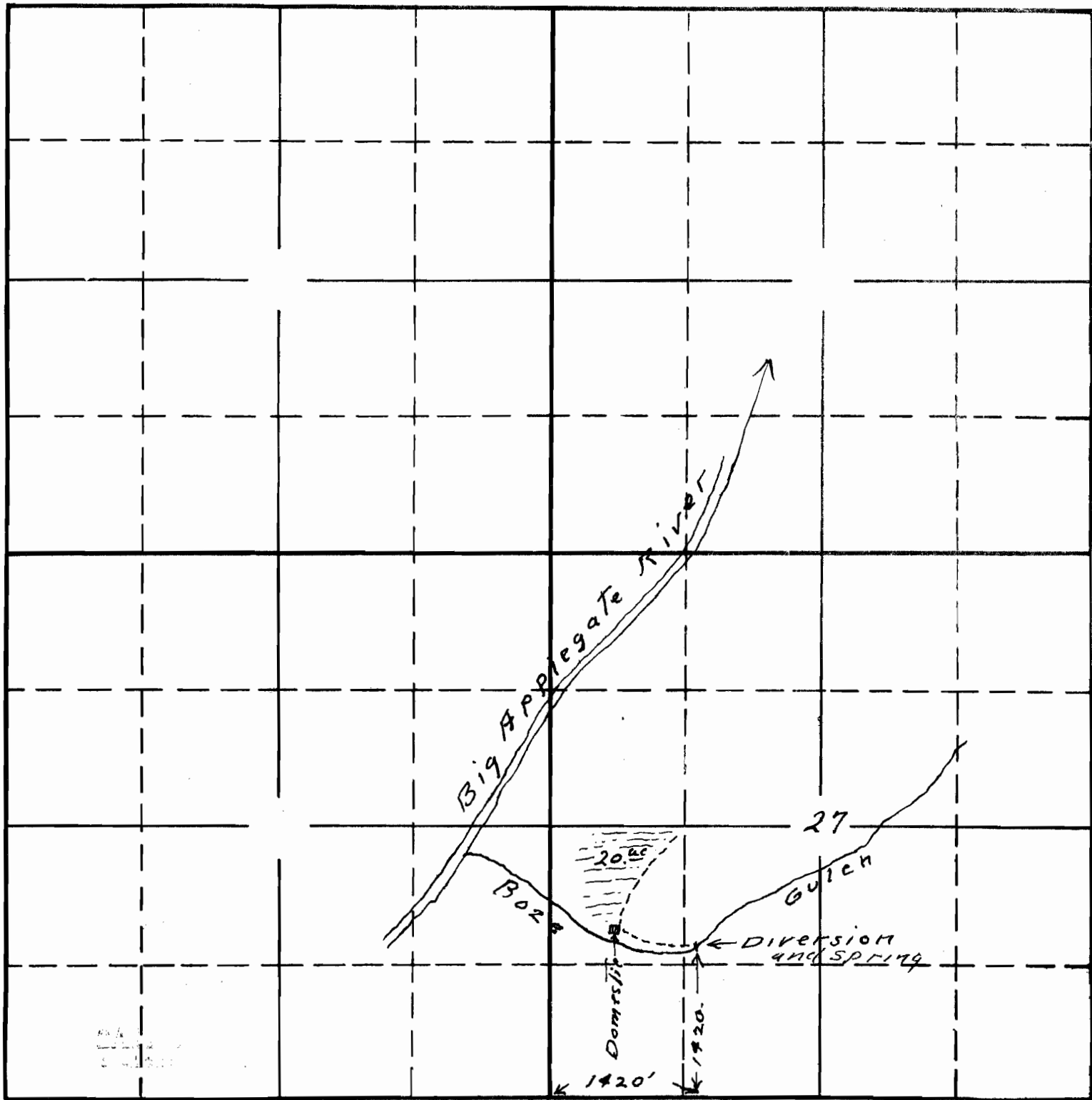

Sketch To accompany application of
 WB Harlow for the use of the waters
 of Boze Gulch and spring in this gulch
 at point of diversion

16470 ac

APPLICATION No. 16470

PERMIT No. 12265