

SECTION

30

31

36

TOWNSHIP 385, RANGES 8-9

Permit: S 12291  
Volume: 8A  
Strm: NOGLE CR  
Trib: JOSEPHINE CR  
Priority: 7/31/36

North

I, Tom R. Pearce, of Grants Pass, Oregon do hereby certify that this map was made from notes taken during an actual survey made by me on July 26, 1936 and that it correctly represents the work described in the accompanying application.



Tom R. Pearce

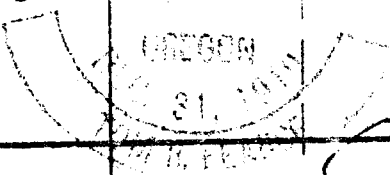

West

East

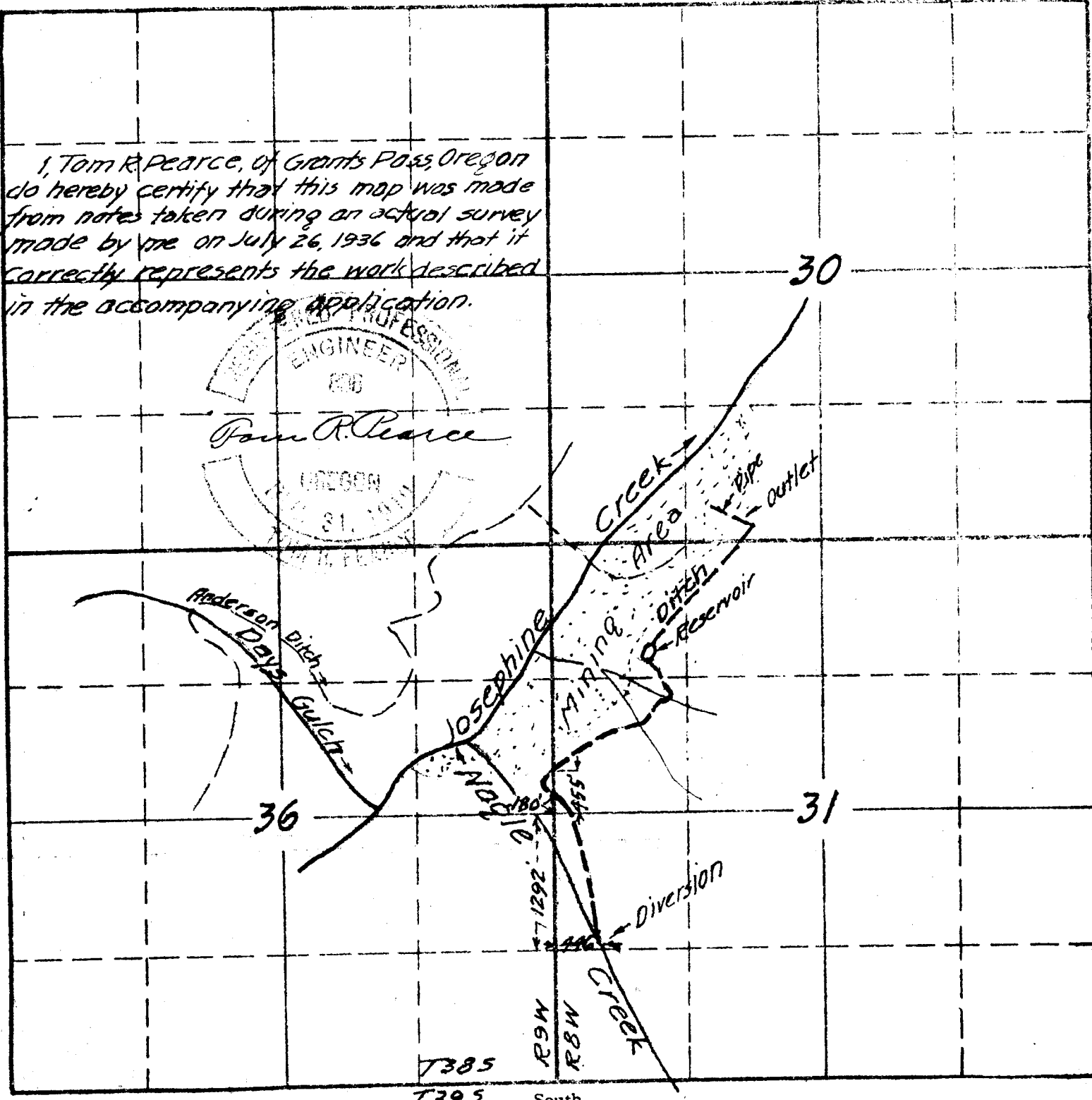

Golden Princess Mines Corp.  
Scale 4" = 1 Mile - July 1936

APPLICATION No. 16490  
PERMIT No. 12291

South