

SECTION

24

TOWNSHIP 30 S, RANGE 6 W, W. M.

North

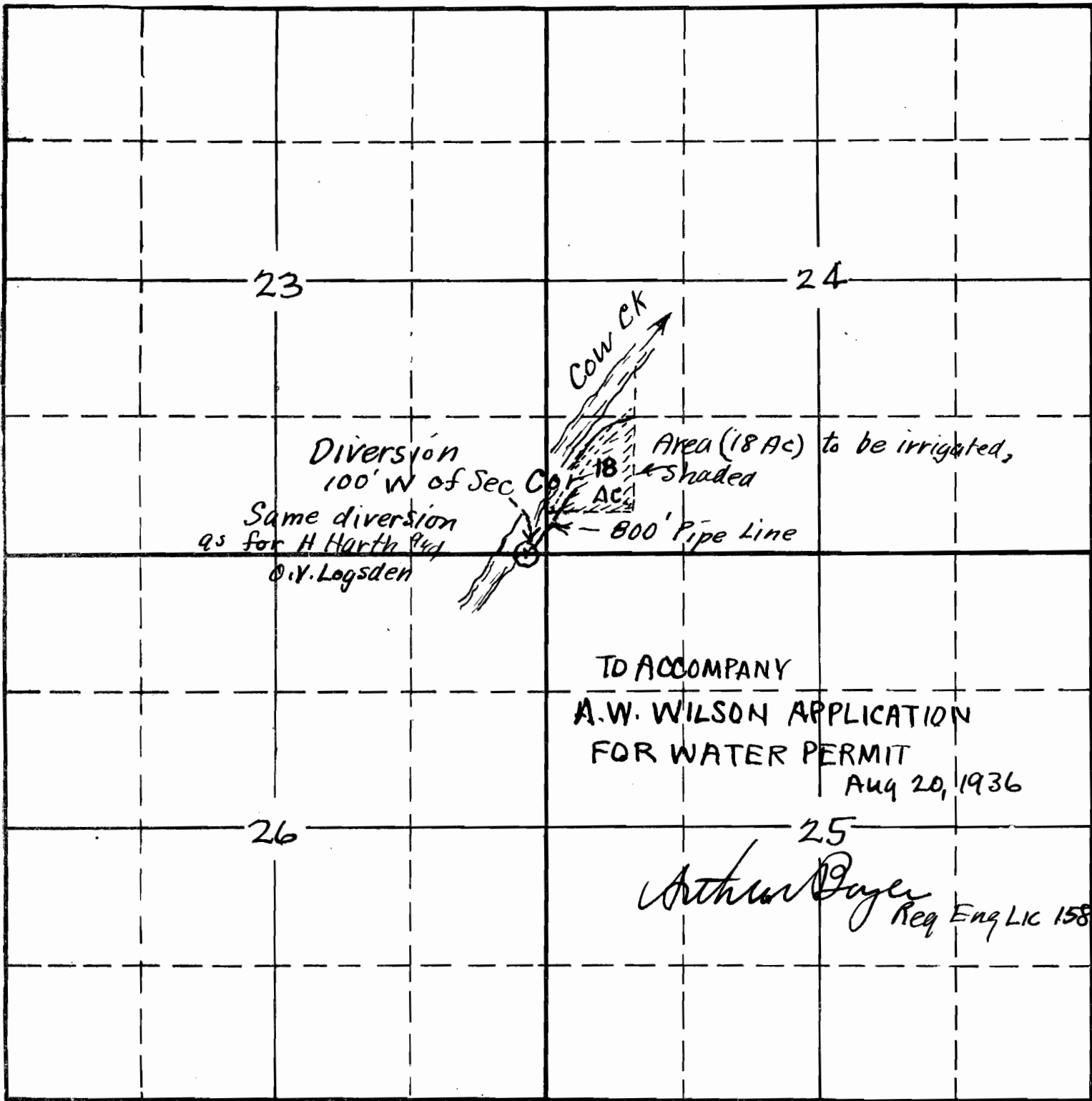

23 24

Diversion
100' W of Sec 24
Same diversion
as for H Harth Per
O.V. Logsdon

Cow Crk

18 Ac shaded

Area (18 Ac) to be irrigated,

800' Pipe Line

TO ACCOMPANY
A.W. WILSON APPLICATION
FOR WATER PERMIT
Aug 20, 1936

26

25

Arthur Dyer
Reg Eng LIC 1581

South

APPLICATION No. 16531
PERMIT No. 12327

SECTION

24

TOWNSHIP 30 S, RANGE 6 W, W. M.

North

23

24

Cow Ck

Diversión
100' W of Sec. Cor.

Area (18 Ac) to be irrigated,
shaded

Same diversión
as for H. Harth

as for H. Harth

Y. Logsdon



800' Pipe Line

TO ACCOMPANY

A.W. WILSON APPLICATION

FOR WATER PERMIT

AUG 20, 1936

26

25

Arthur Dyer

Reg. Eng. Lic 1581

South

APPLICATION No. 16531

PERMIT No. 12327