

MAP of Joseph Veys Irrigation Ditch

T. 2. N. R. 32. E. W. 6.

Township 2 North Range 33 East Will, Meridian Oregon.

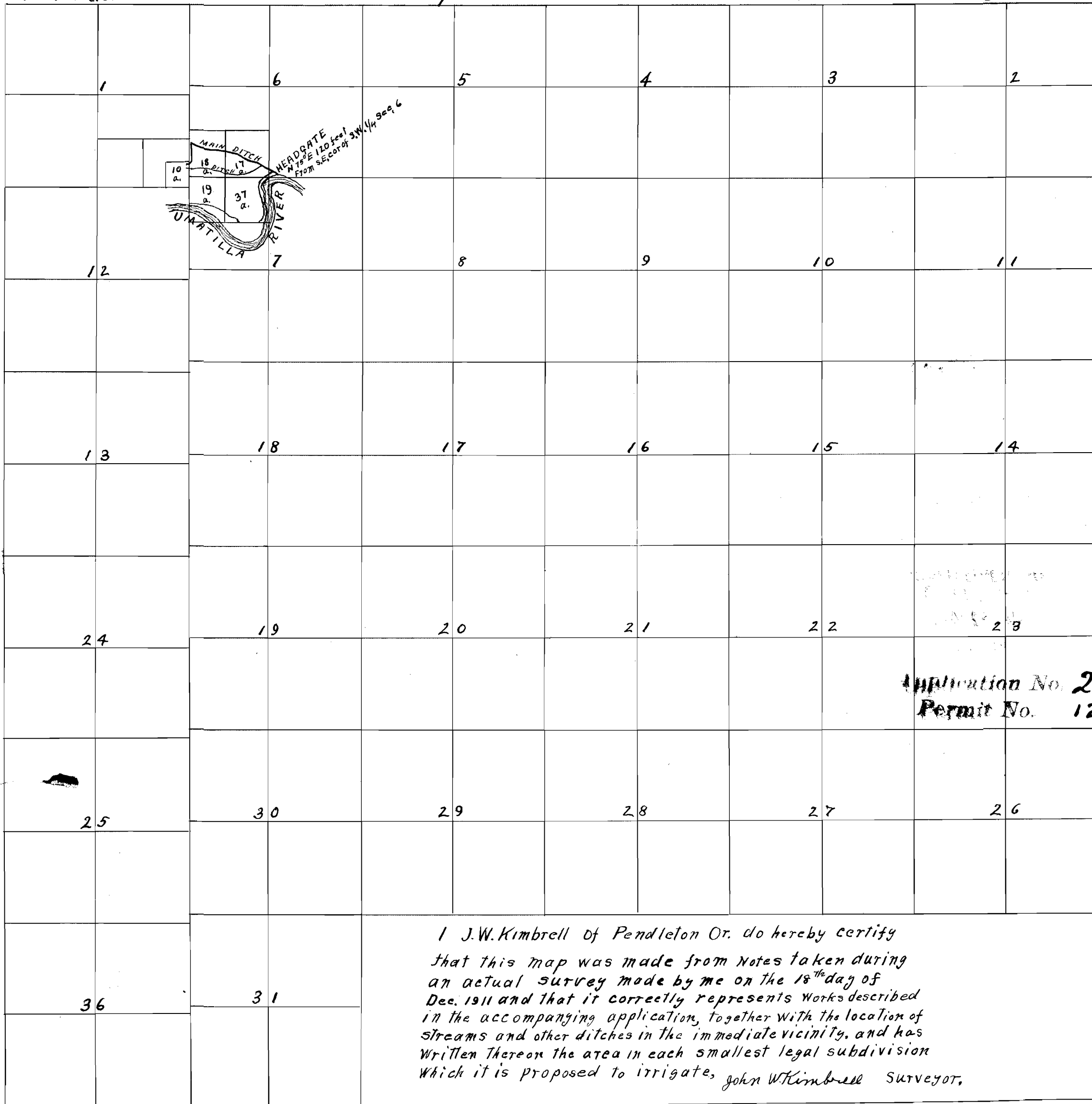

I J.W. Kimbrell of Pendleton Or. do hereby certify that this map was made from notes taken during an actual survey made by me on the 18th day of Dec. 1911 and that it correctly represents works described in the accompanying application, together with the location of streams and other ditches in the immediate vicinity, and has written thereon the area in each smallest legal subdivision which it is proposed to irrigate, John W. Kimbrell Surveyor.

True Meridian
 Var. 21° 15' E
 scale 40 chs. 1 inch