

T165 R47E W.M.
 4 3 2 1 4 3 2 1 2
 70.71 66.98 66.83 66.68 66.60 66.60 66.60 66.60 66.49

PAYETTE-OREGON SLOPE
 IRRIGATION PROJECT.

Map accompanying application for
 permit to appropriate water.
 C.P. Lattig Payette, Idaho.
 Feb. 8, 1912

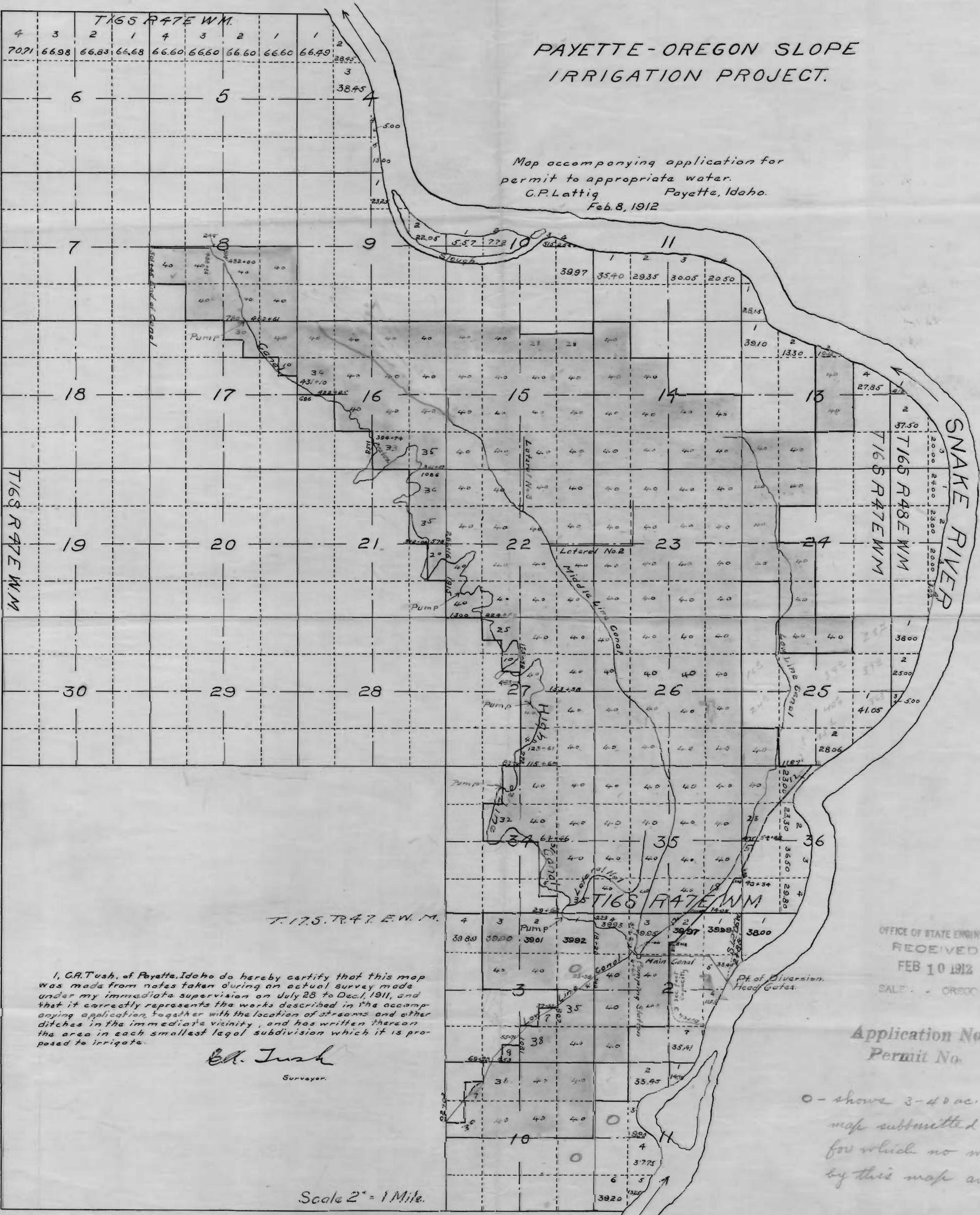

T165 R47E W.M.

Snake River
 T165 R48E W.M.
 T165 R47E W.M.

I, C.A. Tush, of Payette, Idaho do hereby certify that this map was made from notes taken during an actual survey made under my immediate supervision on July 28 to Dec. 1, 1911, and that it correctly represents the works described in the accompanying application, together with the location of streams and other ditches in the immediate vicinity, and has written thereon the area in each smallest legal subdivision which it is proposed to irrigate.

C.A. Tush
 Surveyor.

Scale 2" = 1 Mile.

OFFICE OF STATE ENGINEER
 RECEIVED
 FEB 10 1912
 SALE - OREGON

Application No. 2079
 Permit No. 1243

○ - shows 3-40 ac. tracts on map submitted by Clark H.S. Colloch for which no water right is shown by this map and permit.