

SECTION

27

TOWNSHIP 36 S, RANGE 4 W, W. M.

North

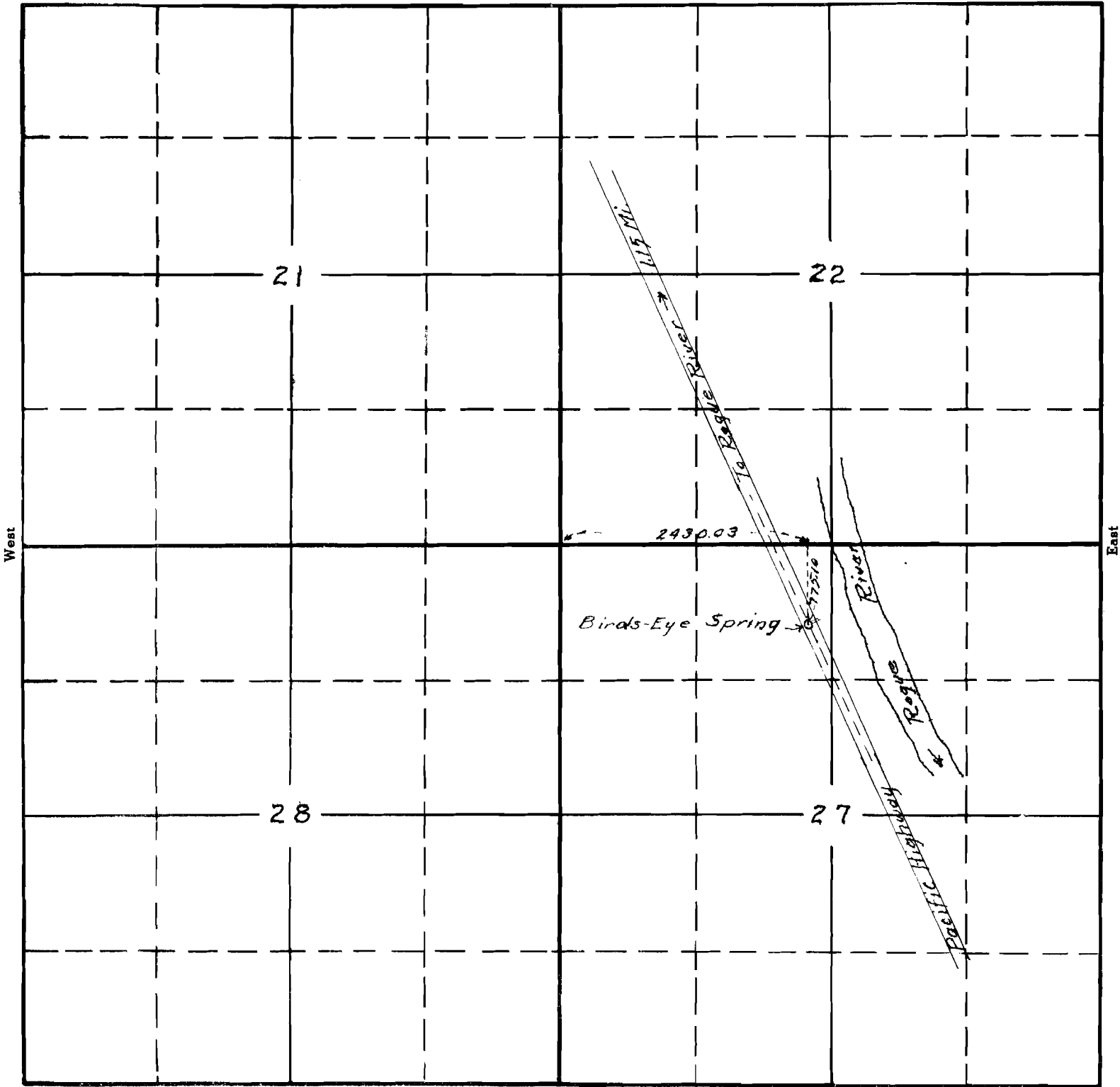

South

I, R.H. Baldock, State Hwy. Engr., do hereby certify that this map was made from notes taken during an actual survey made by me (or under my immediate supervision) on Sept. 22, 1936, and that it correctly represents the work described in the accompanying application, together with the location of streams and other ditches in the immediate vicinity.

[Signature]

Registered Professional Engineer

Oregon No. 157

Nov. 8, 1919

Date of Registration

16957
APPLICATION No. 16957

PERMIT No. 12698