

SECTION

TOWNSHIP 35, RANGE 2 W. M.

Twp 35 R 2 W North

Twp 35 R 1 W

36

31

Twp 45 R 2 W

place of use

proposed location

1

6

South

West

East

RECEIVED
JUL 3 1937
STATE ENGINEER
SALEM, OREGON

RECEIVED
JUL 10 1937
STATE ENGINEER
SALEM, OREGON

APPLICATION No. 16962
PERMIT No. 12718

SECTION

TOWNSHIP _____, RANGE _____, W. M.

North

West

East

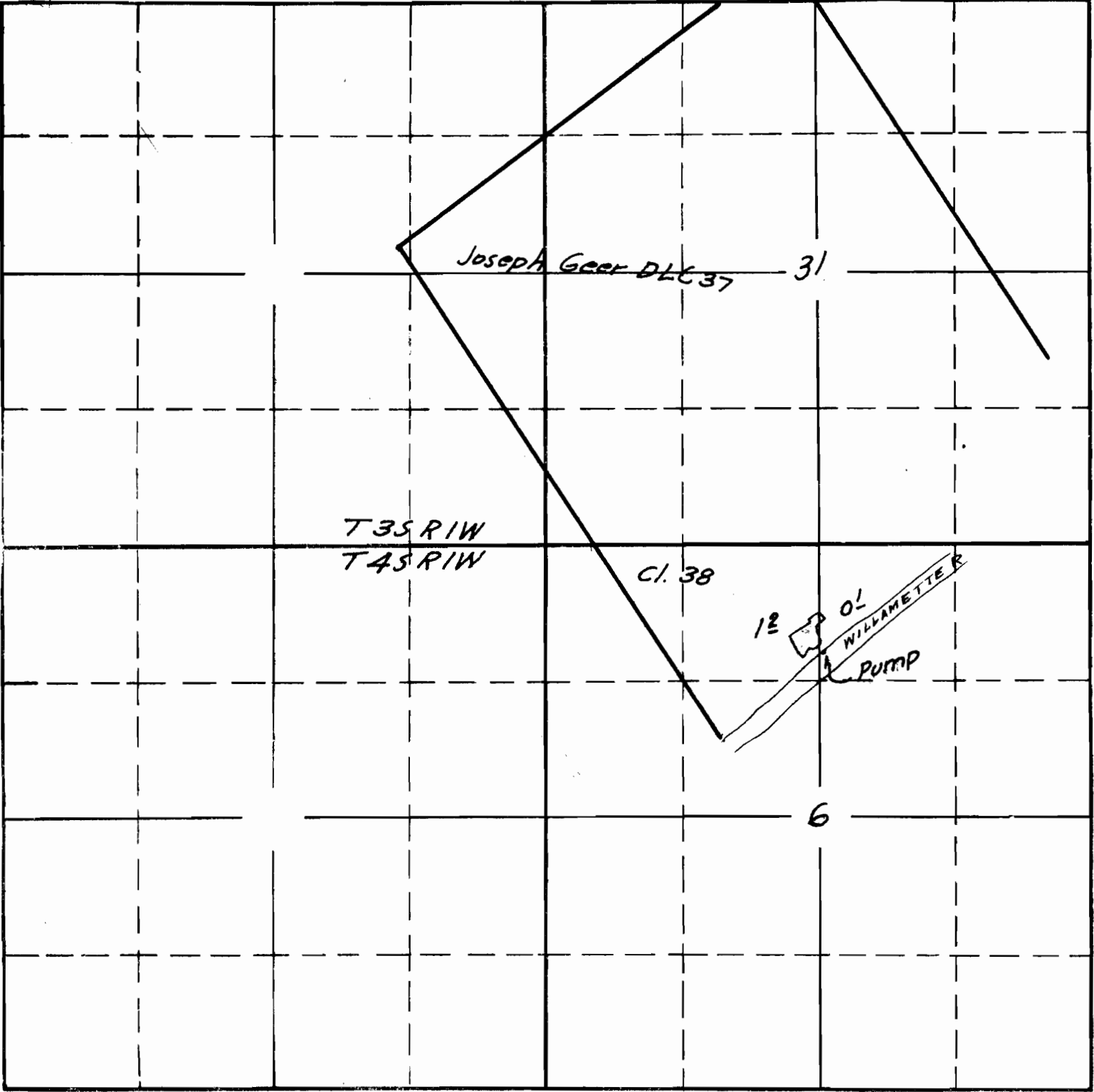

South

APPLICATION No. 16962
PERMIT No. 12718