

SECTION

TOWNSHIP 1N, RANGE 3W, W. M.

North *Scale, 1 inch = 1320 feet.*

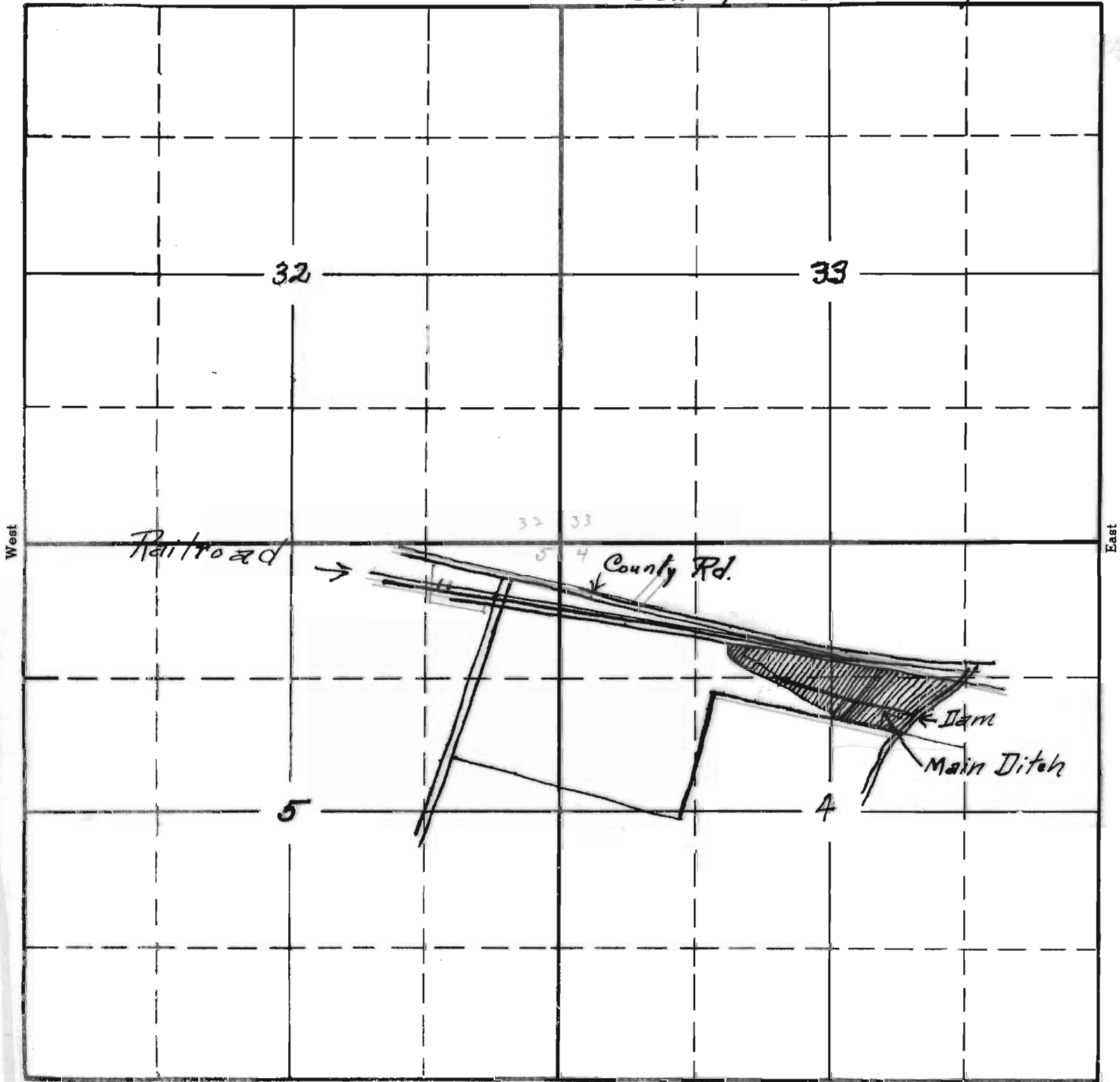

South 2P62C

17018 OK

**RECEIVED**  
 AUG 7 1937  
 STATE ENGINEER  
 SALEM, OREGON

APPLICATION No. 17018  
 PERMIT No. 12764

SECTION

TOWNSHIP 1N, RANGE 3W, W. M.

North

William Wilson  
D.L.C. 37

John L. Matthrop  
D.L.C. 76

2'

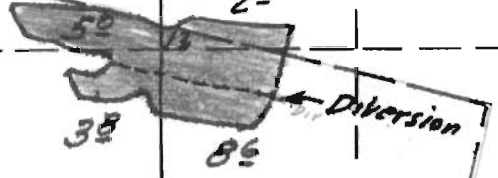

4

West

East

Surveyed June 10, 1940 C.A.C.

South

APPLICATION No. 17018  
PERMIT No. 12764