

MAP
SHOWING LOCATION
OF
WATER WHEEL - PIPE

LINE and FLUME ON

LOT 23 - to cover water
right also on Lot 24 -

Rogue Acres - Sec. 3 - Twp 34²

Range 1 W. - Willamette meridian

To accompany
application of
Loren J & Lela Ruth
Beaufait
of Trail, Ore.

4 | 3
9 | 10

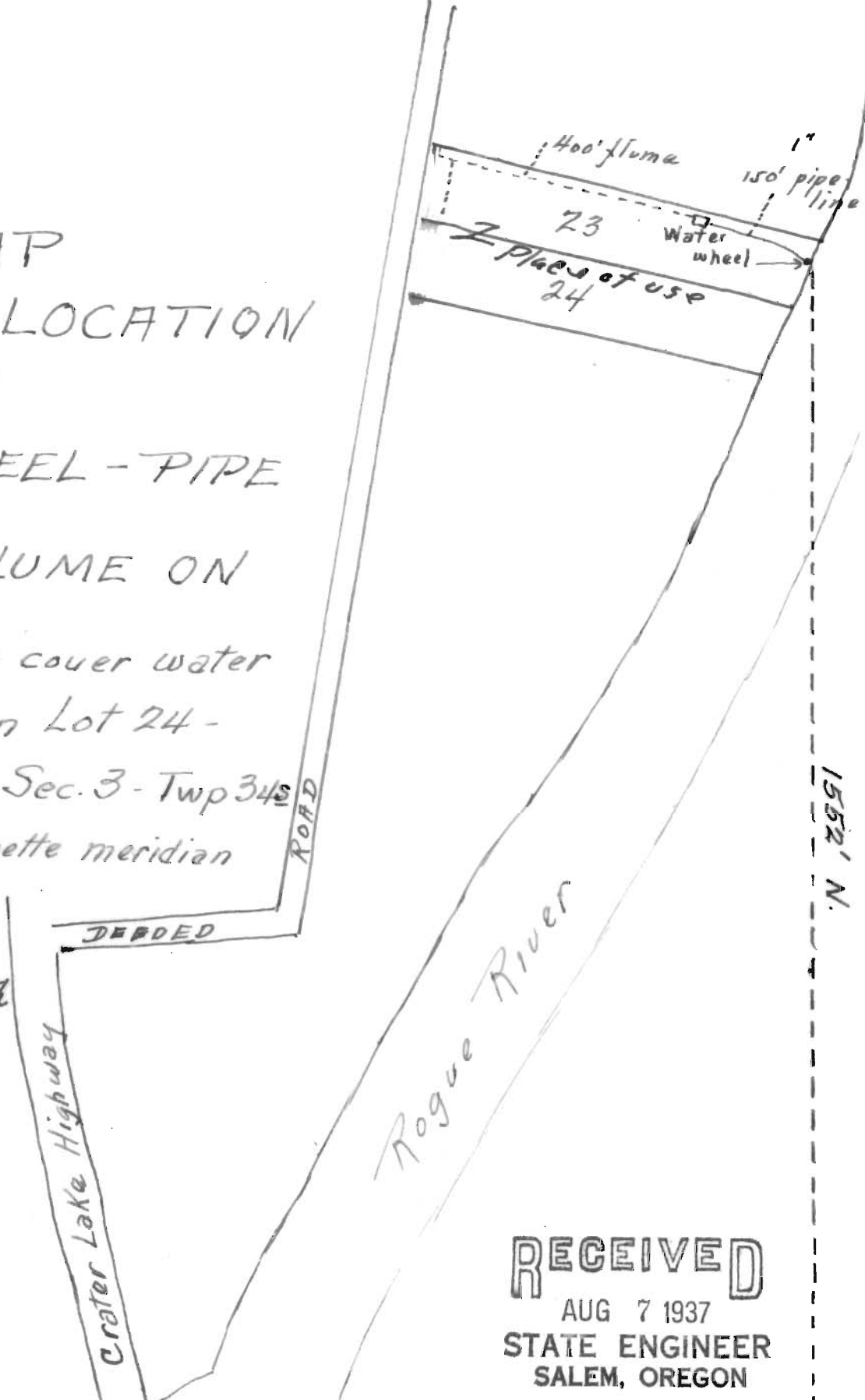

3263' E. of Section corner.

15 p60

17019 BK

RECEIVED
AUG 7 1937
STATE ENGINEER
SALEM, OREGON

Application No. 17019
Permit No. 12765