

SW. Cor.
J.E. Lyle D.L.C.

N line Levens' D.L.C.

RECEIVED
AUG 14 1937
STATE ENGINEER
SALEM, OREGON



1 in. = 5 chs.

Limits
Dallas, Oregon

River

L.F.
Greosser

Maude Butler

La Creole

County Road

40 chs. S } of NW Cor
27 chs. E } Sec. 32 T. 7 S. R. 5 W.

CLOY

Washington St.

Ave.
ST

POLK CO.

David Guthrie

West
City Boundary

Oregon

Fairview

overflow water from Res.

Point of diversion
5.35 chs. N } of most southerly
22.12 chs. E } S.E. Cor. Benj. Nichols D.L.C.

Sec 31
Sec 32

Water
Com.

Sec. Line

Maple St.

Ap. 17025
Per. 12774

SECTION

32

TOWNSHIP 7 N., RANGE 5 W., W. M.

North

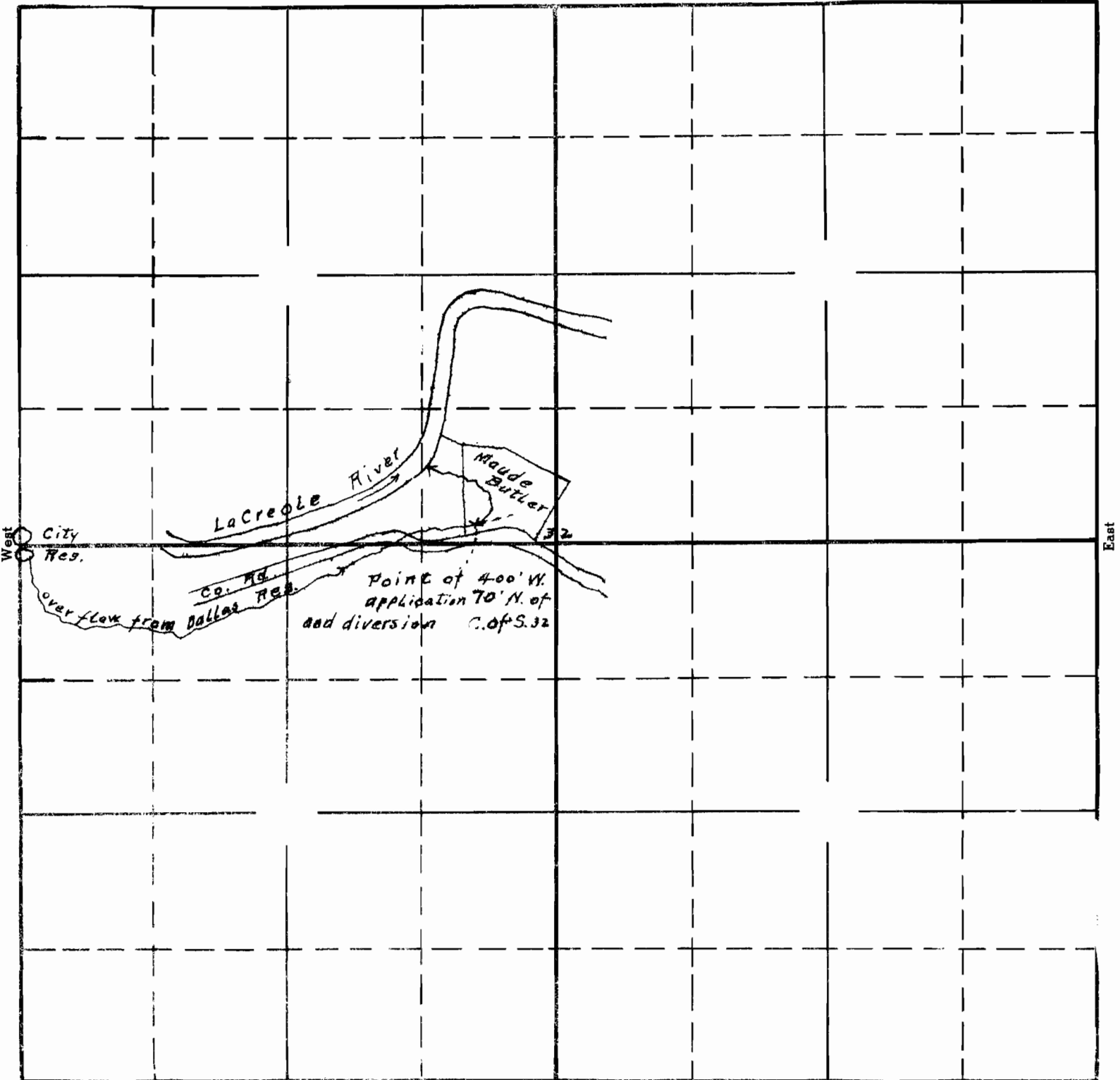

West

East

South

1" = 10 chs.

APPLICATION No. 17025
PERMIT No. 12774

SECTION

TOWNSHIP 75, RANGE 5W, W. M.

North

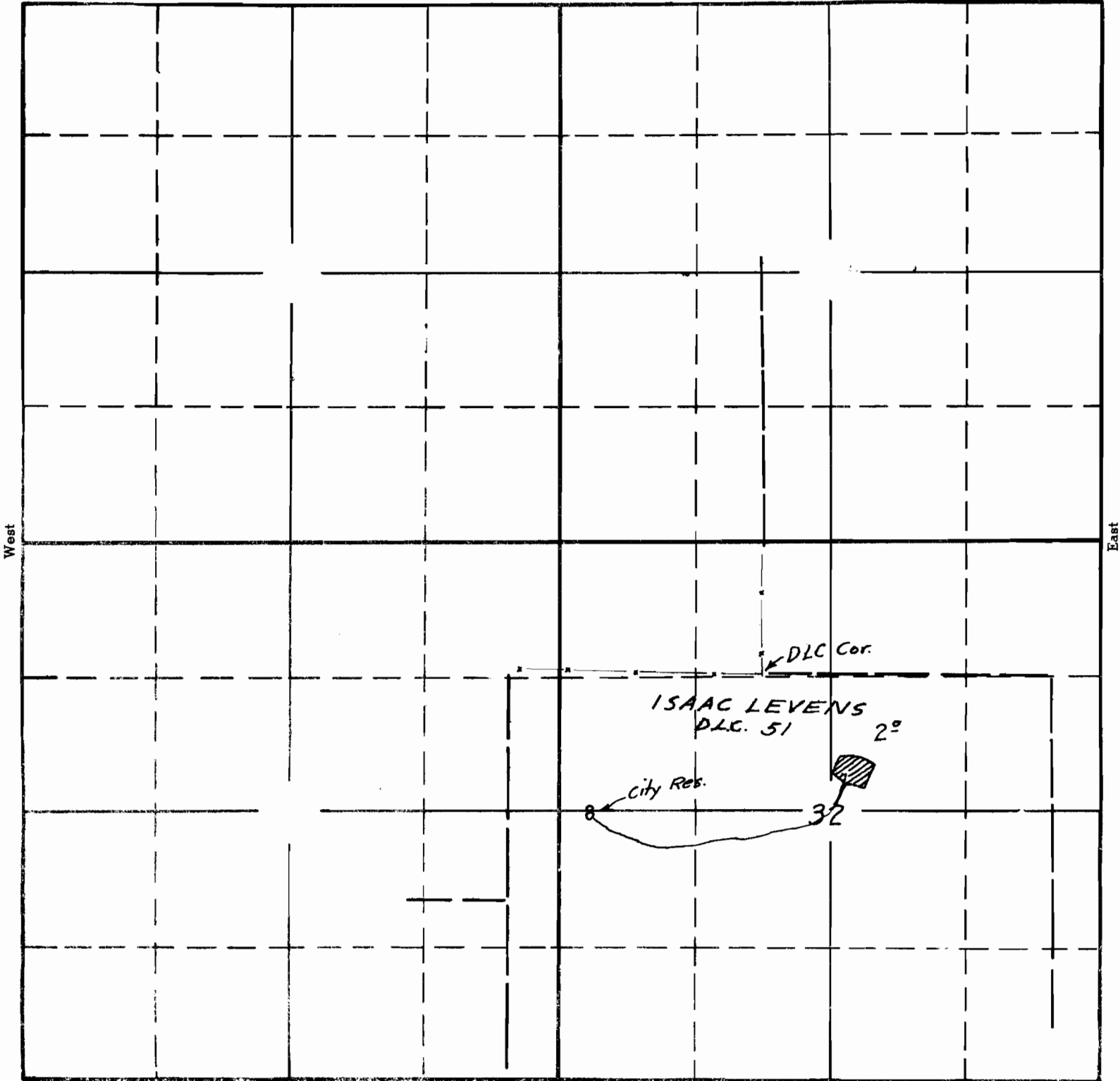

South

APPLICATION No. 17025

PERMIT No. 12774