

North

WATER RIGHT APPLICATION
MAP

BRUSHY BAR GUARD STATION
and

FOREST CAMP

Lots 1 & 2 & S 1/2 N 1/2 NE 1/4 - Sec. 36 - T33S,
R11W W.M.

Siskiyou National Forest

Curry County, Oregon

Scale - 1" = 660' (10 chains)

Mapped by - F.K. Lightfoot - Sept. 1937

Re-platted by - H. T. S. - Oct. 8, 1937

Sec. 19 T 33S R 10W W.M.
Sec. 30

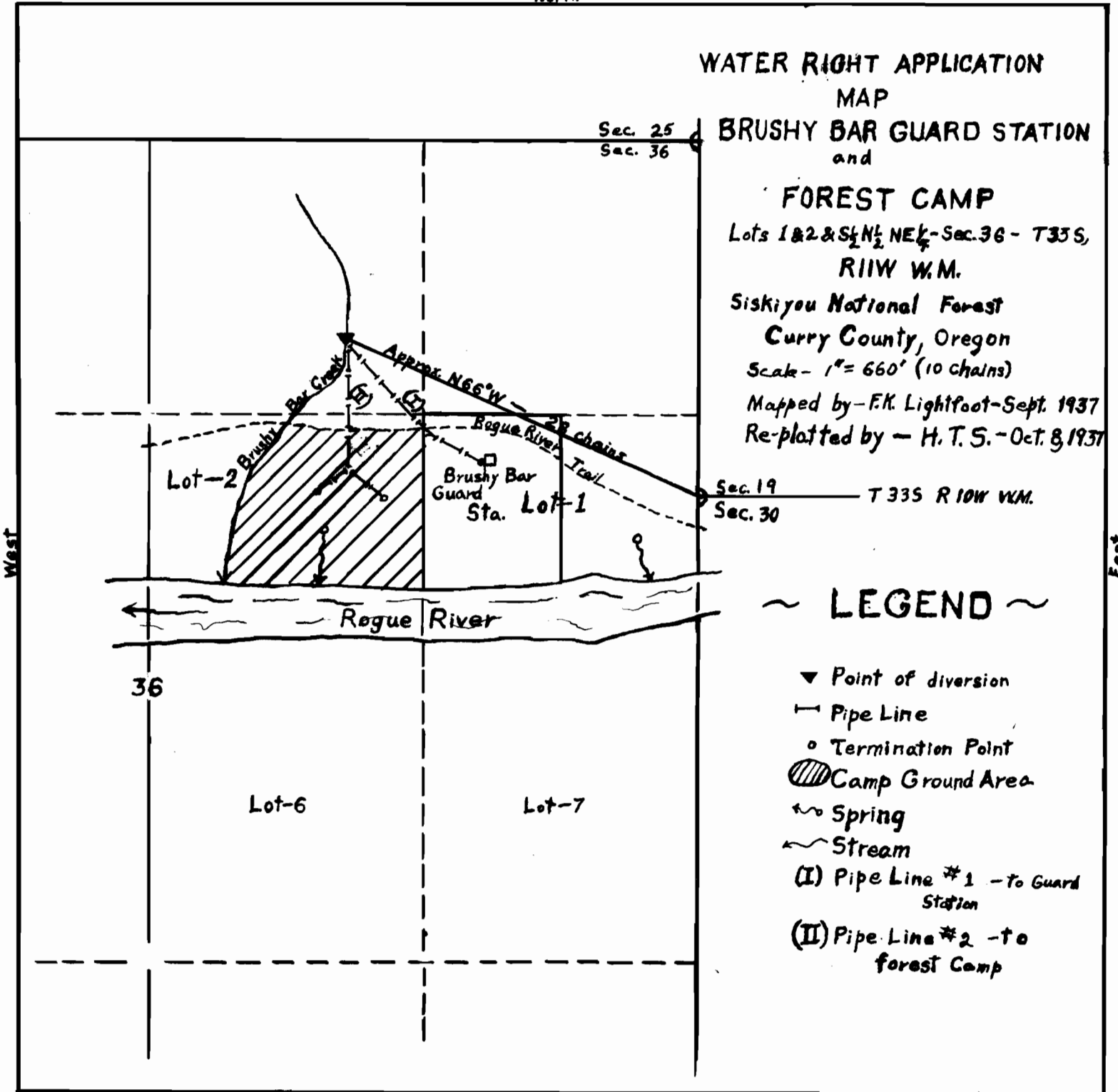

~ LEGEND ~

- ▼ Point of diversion
- Pipe Line
- Termination Point
- ▨ Camp Ground Area
- ~ Spring
- ~ Stream
- (I) Pipe Line #1 - to Guard Station
- (II) Pipe Line #2 - to forest Camp

South

RECEIVED

OCT 11 1937

STATE ENGINEER
SALEM, OREGON

Application No. 17112
Permit No. 12842

APPLICATION No. -17112

PERMIT No. 12842