

SECTION

27

TOWNSHIP 39S, RANGE 1W, W. M.

North

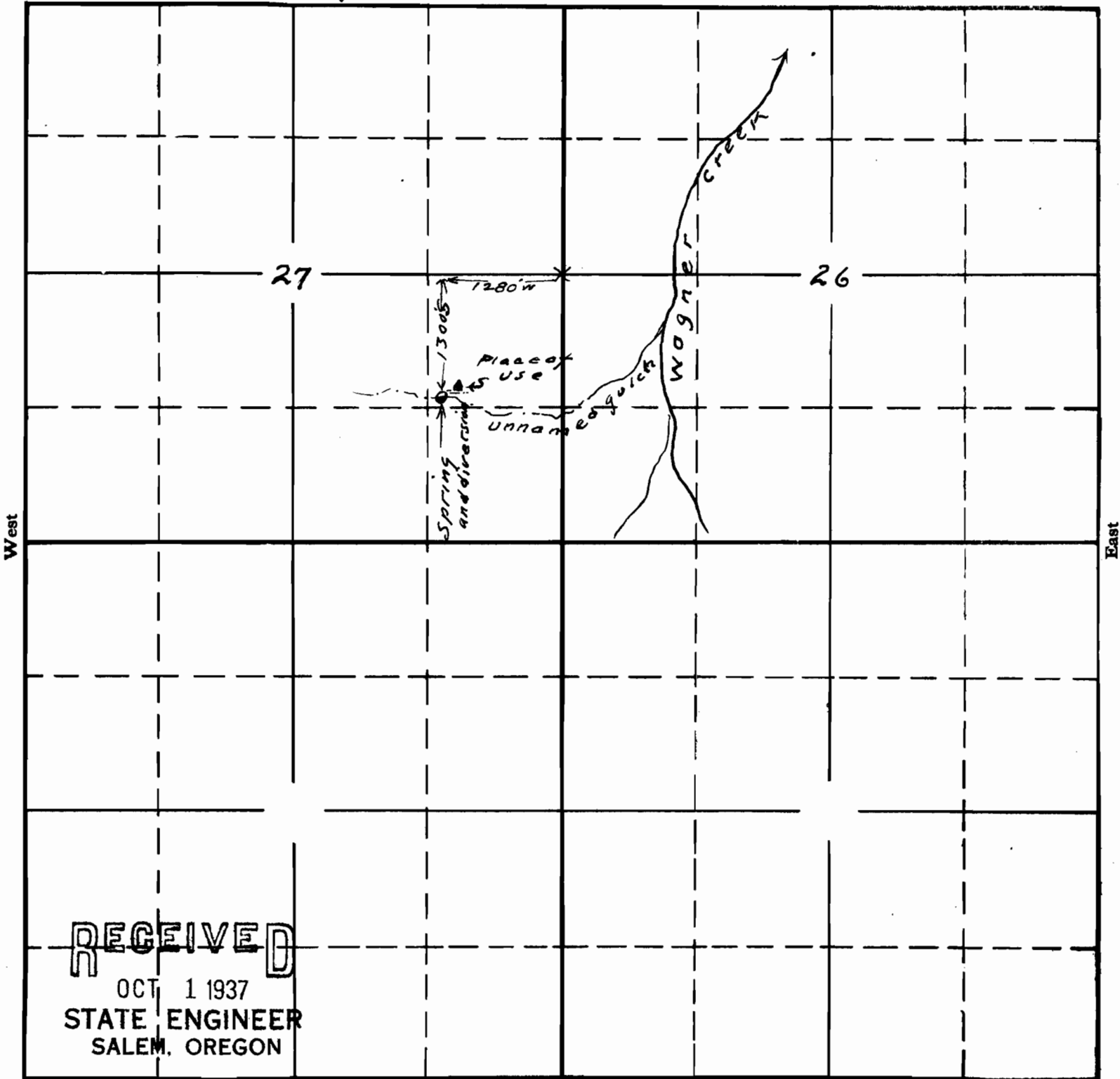

RECEIVED

OCT 1 1937
STATE ENGINEER
SALEM, OREGON

Sketch showing location of spring-
diversion for application of
Dora E Wight

APPLICATION No. 17116
PERMIT No. 12845

This office Sept 29, 1937 15-22

17116 MS