

RECEIVED
OCT 13 1937
STATE ENGINEER
SALEM, OREGON

T. 29 S. R. 12 W. W. M.

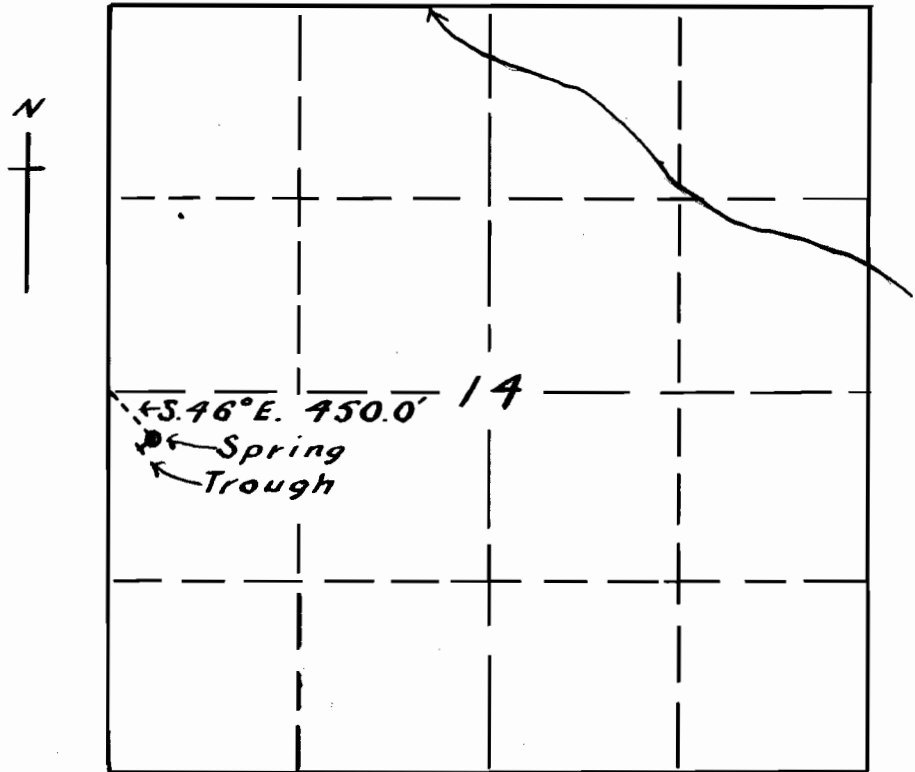

Map
accompanying
application of
THOS. D. GUERIN
to
appropriate water.

Scale 4 ins. = 1 mile

I, J. N. Gearhart, of Myrtle Point, Oregon, do hereby certify that this map was made from notes taken during an actual survey made by me on Oct. 7, 1937, and that it correctly represents the works described in the accompanying application, together with the location of streams and other ditches in the immediate vicinity.

Application No. 17128
Permit No. 12852
J. N. Gearhart
Oregon Reg. No. 183.