

SECTION

\_\_\_\_\_

\_\_\_\_\_

\_\_\_\_\_

4496

TOWNSHIP 36S, RANGE 7W., W. M.

North

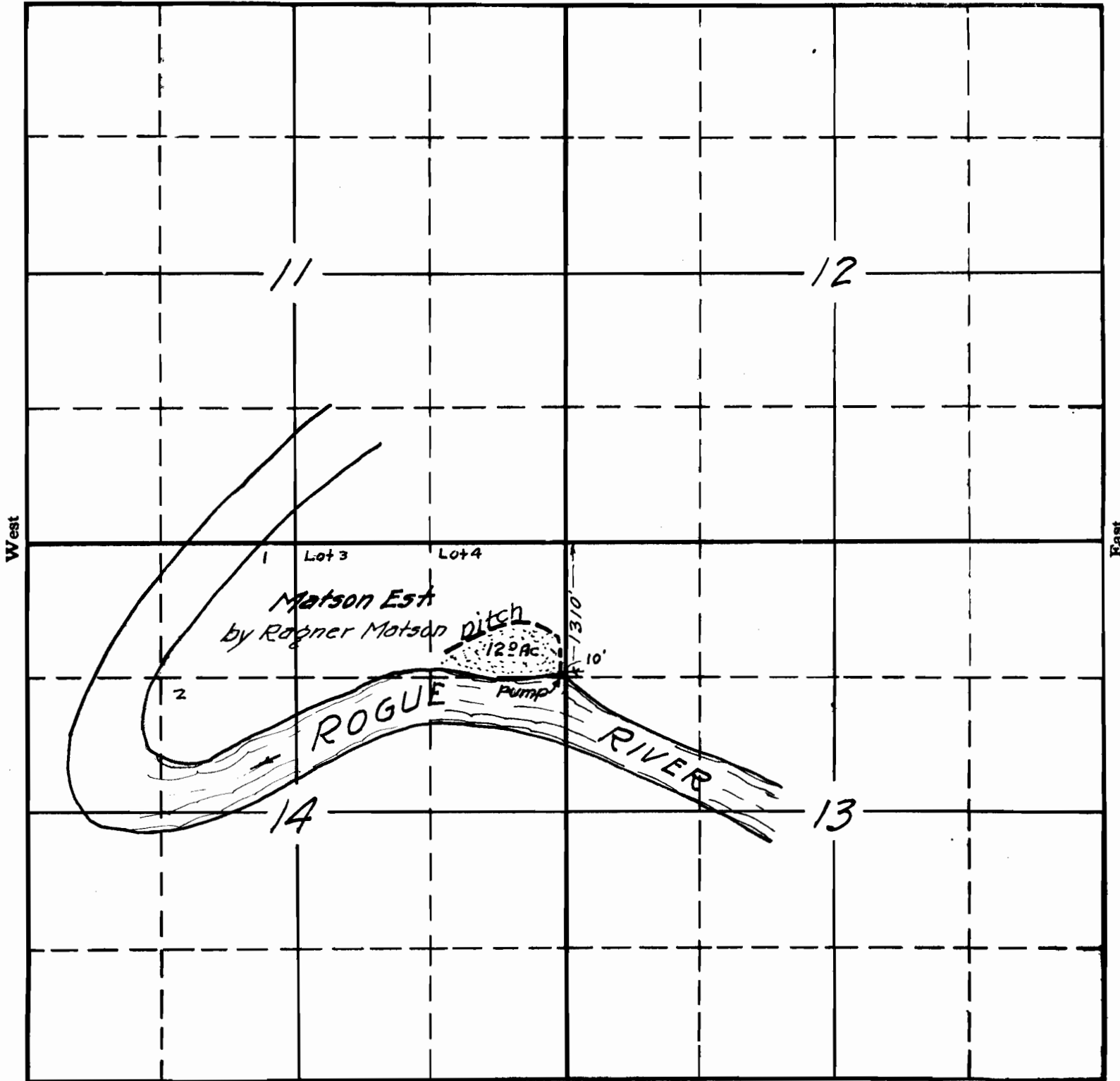

South

1565

17156.75

RECEIVED

8:00 AM

NOV 10 1937

STATE ENGINEER  
SALEM, OREGON

Nov. 37 APPLICATION No. 17156  
PERMIT No. 12874