

SECTION

TOWNSHIP 38 S , RANGE 14 W , W. M.

North

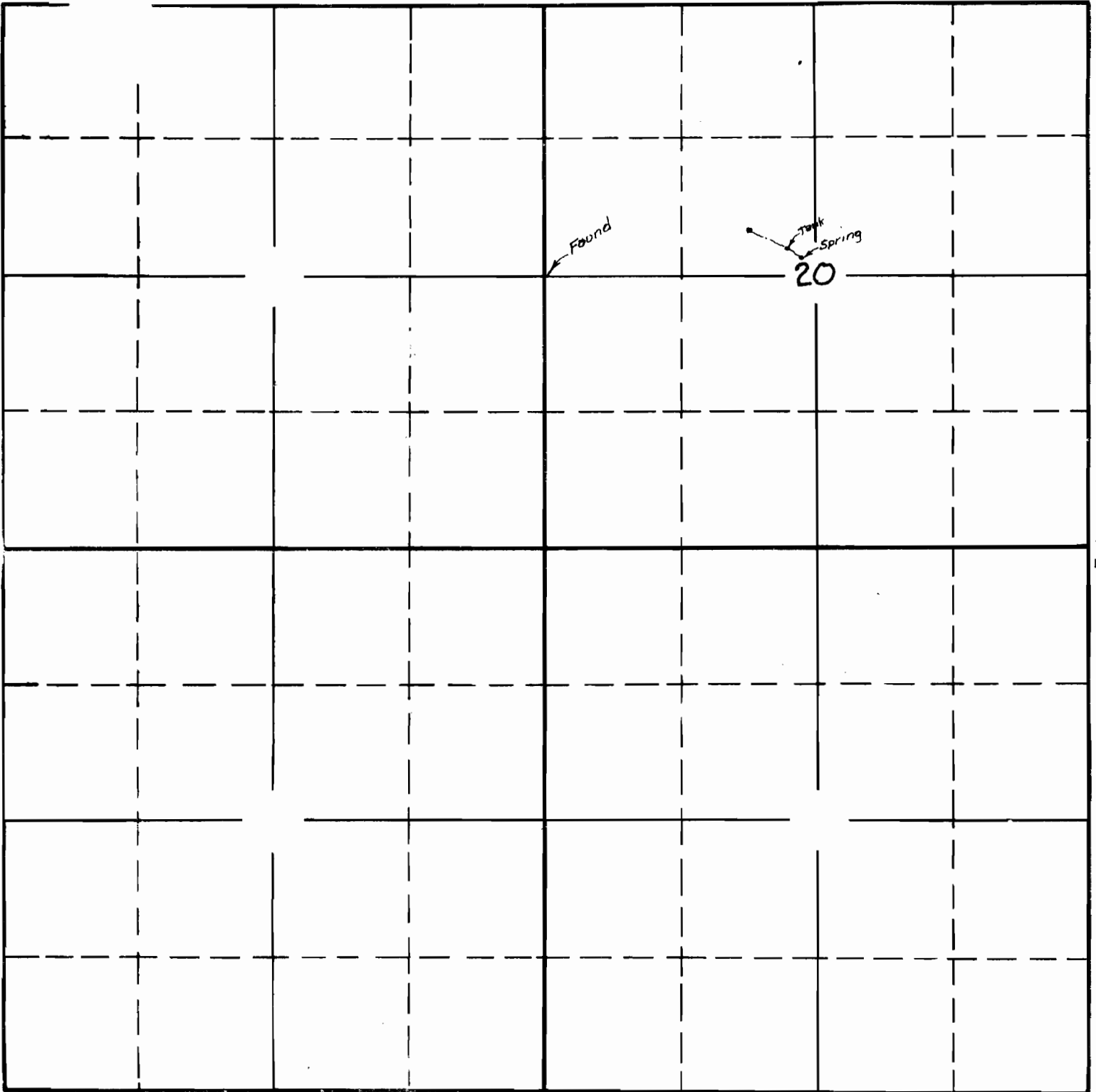

West

East

South

Surveyed by  
C.A. Cummings  
June 16 1939

APPLICATION No. 17179  
PERMIT No. 12901

SECTION

20

TOWNSHIP 38 S., RANGE 14 W., W. M.

North

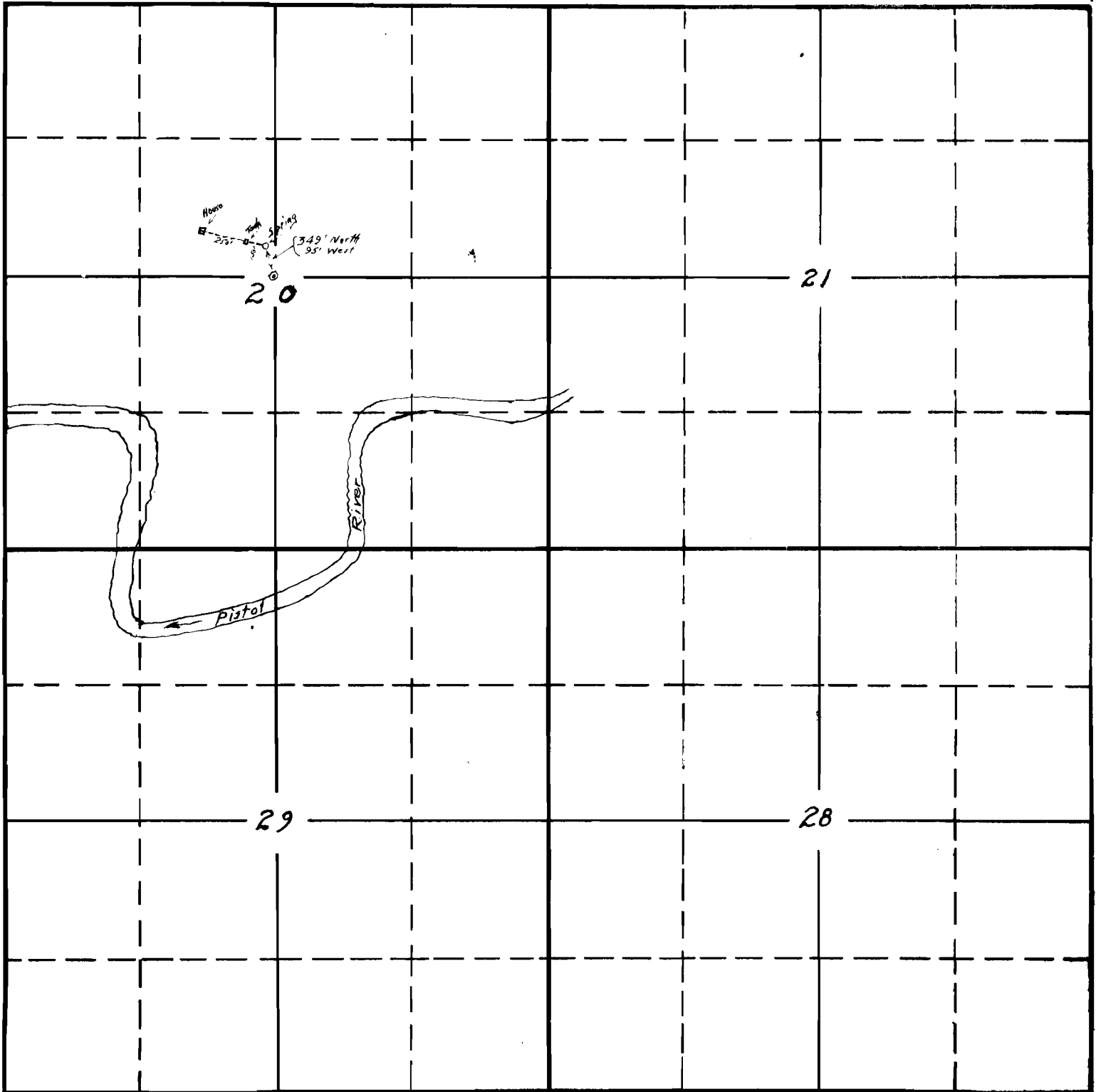

West

East

South

S.T.M.E. 11-37  
**RECEIVED**  
 DEC-6 1937  
 STATE ENGINEER  
 SALEM, OREGON

17179

17179  
 APPLICATION No. 12901  
 PERMIT No.