

SECTION

SECTION

TOWNSHIP 15, RANGE 43 E, W. M.

TOWNSHIP 15, RANGE 44 E, W. M.

North

North

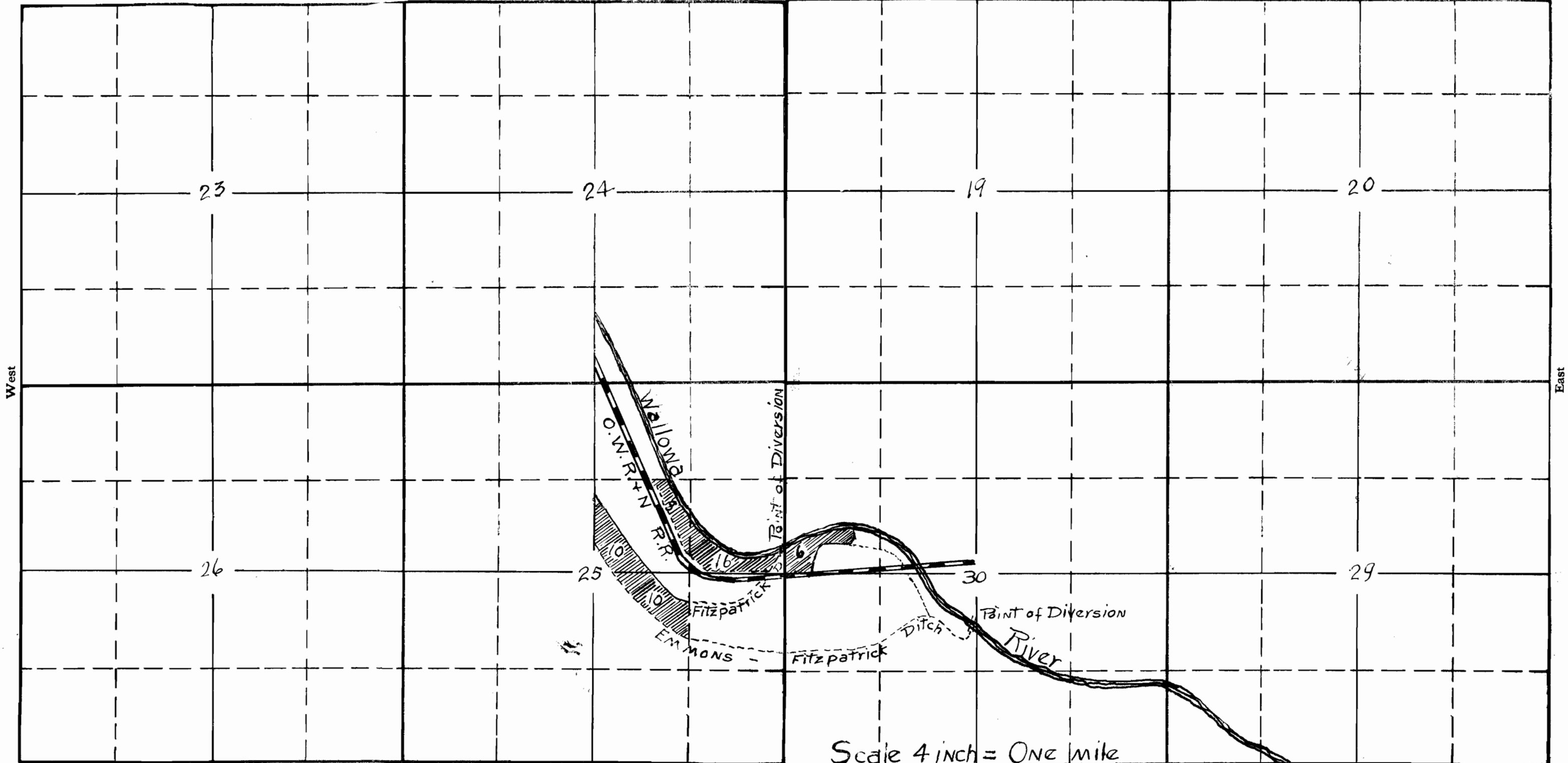

West

East

South

South

APPLICATION No.
PERMIT No.

RECEIVED
OCT 28 1937
STATE ENGINEER
SALEM, OREGON

APPLICATION No. 17139
PERMIT No. ~~12909~~

12909