

Ap. May 1938
 scale 4" = 1 Mile

See Map Adjudication Survey
 of Illinois River

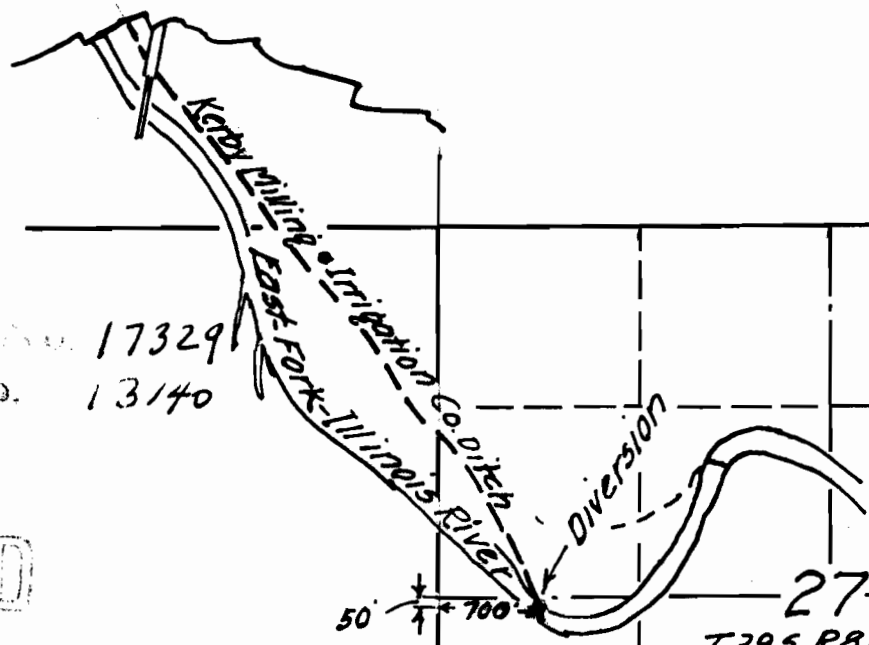

Application No. 17329
 Permit No. 13140

RECEIVED
 MAY 1938
 STATE ENGINEER
 SALEM, OREGON

17329 AC
 15-36 @

NW 1/4
 of
 SW 1/4
 SEC. 27

27
 T.39 S, R. 8 W, W. M.