

# SURVEYORS CERTIFICATE

I, W. Stanley Coates of Tillamook, Ore. do hereby certify that this map was made from notes taken during an actual survey made under my direct supervision, and that it correctly represents the location of streams and marks herein shown

W. Stanley Coates  
C.E. #967

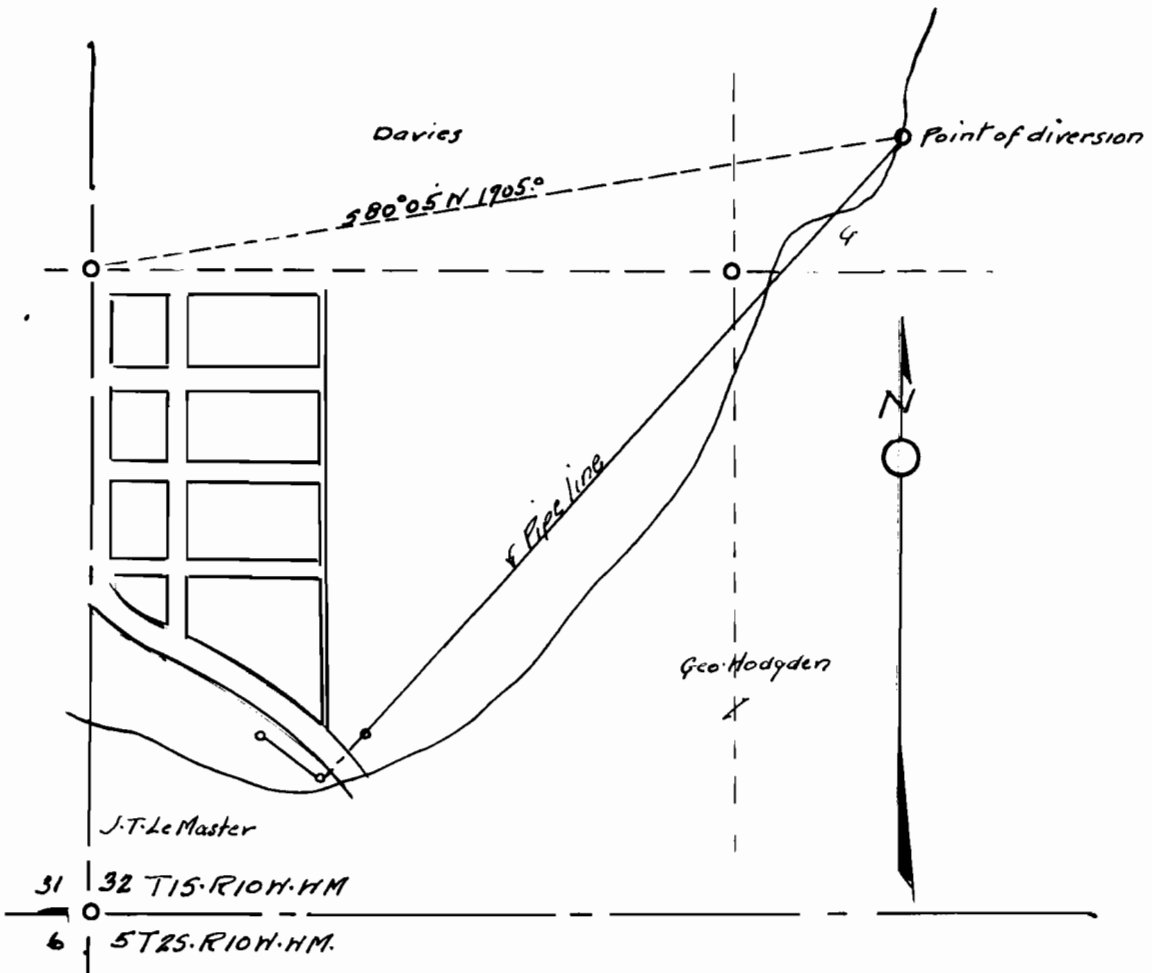

Application No. 1707 (1967 M)  
Permit No. 15116

WATER RIGHT  
FOR

J.T. LE MASTER AND GEO. HODGDEN  
SEC. 32 - T15 - R10W - HM

Scale 1"=400'

TOWNSHIP 15, RANGE 10W, W.M.

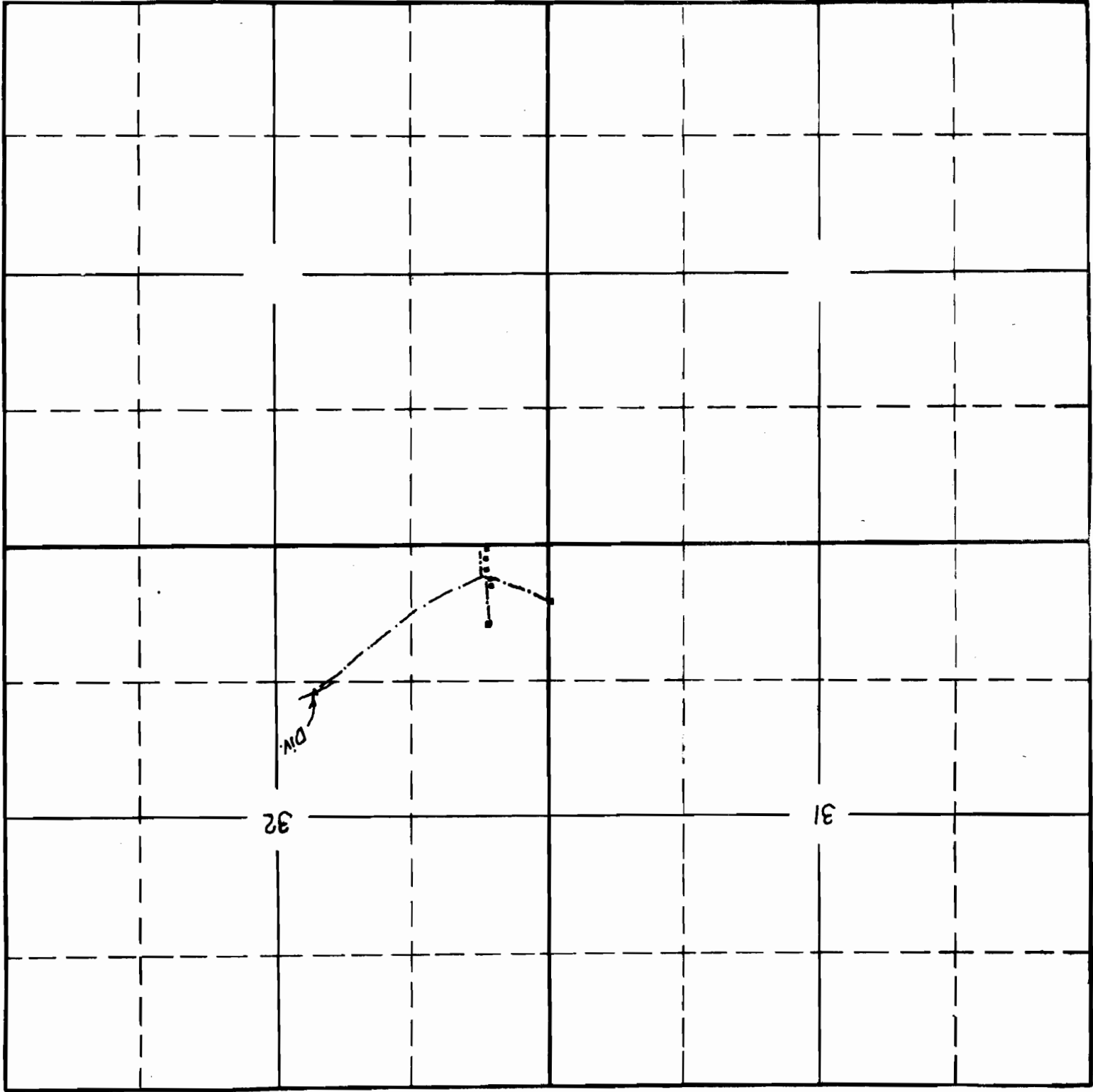

APPLICATION NO. 17467  
PERMIT NO. 13178