

TOWNSHIPS 27 & 28S. RANGE 6 W, WM.

SECTIONS.

34-3-4-9 & 10.

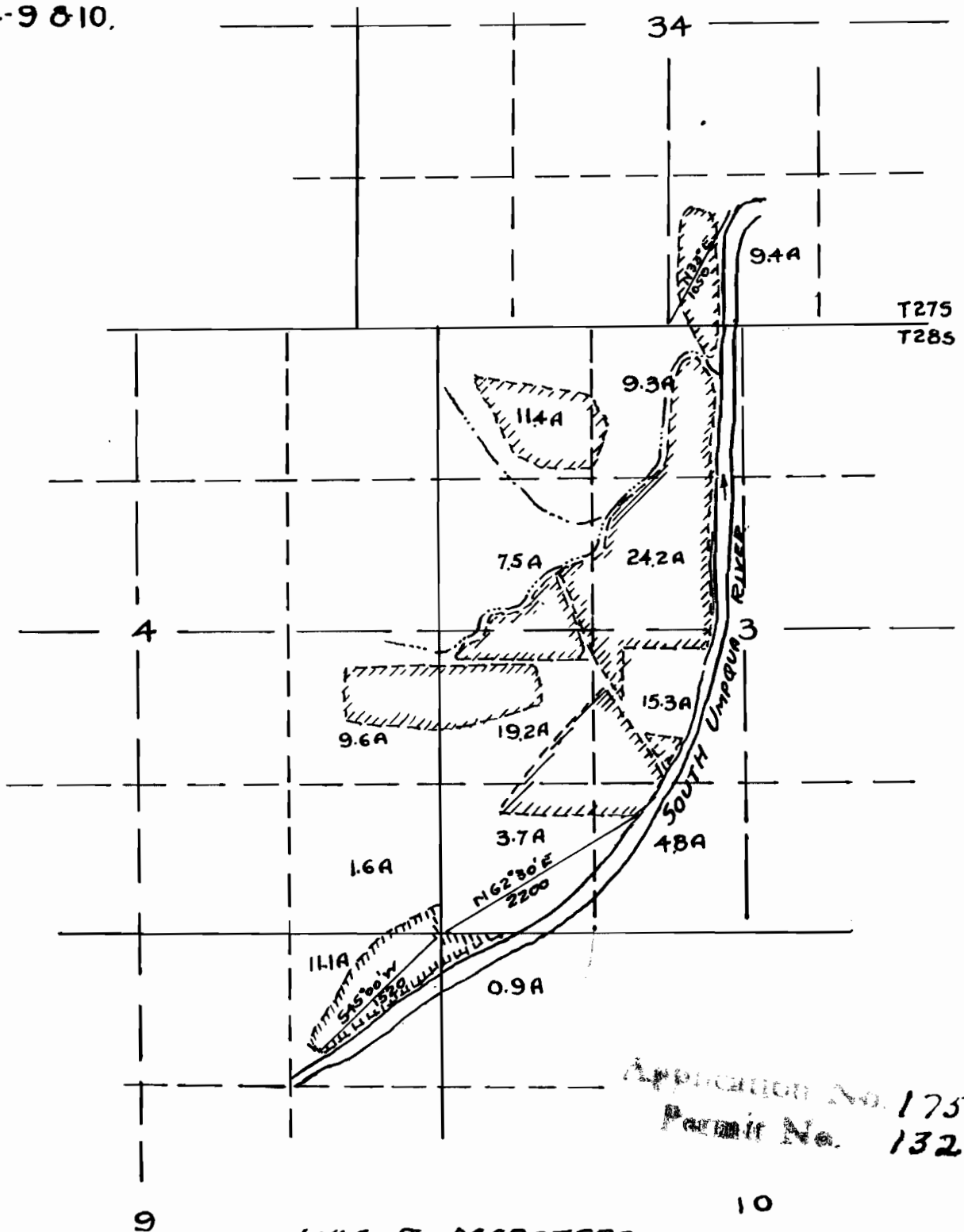

Application No. 17580
Permit No. 13277

LYLE E. MARSTERS
IRRIGATION SYSTEM.

RECEIVED
SEP 12 1938
STATE ENGINEER
SALEM OREGON

SURVEYED BY BEN B. IRVING.
REGISTERED ENGINEER & SURVEYOR.
ROSEBURG OREGON 9-3-38
17580 OK 16-30