

SECTION

2

TOWNSHIP 7S RANGE 3W, W. M.

North

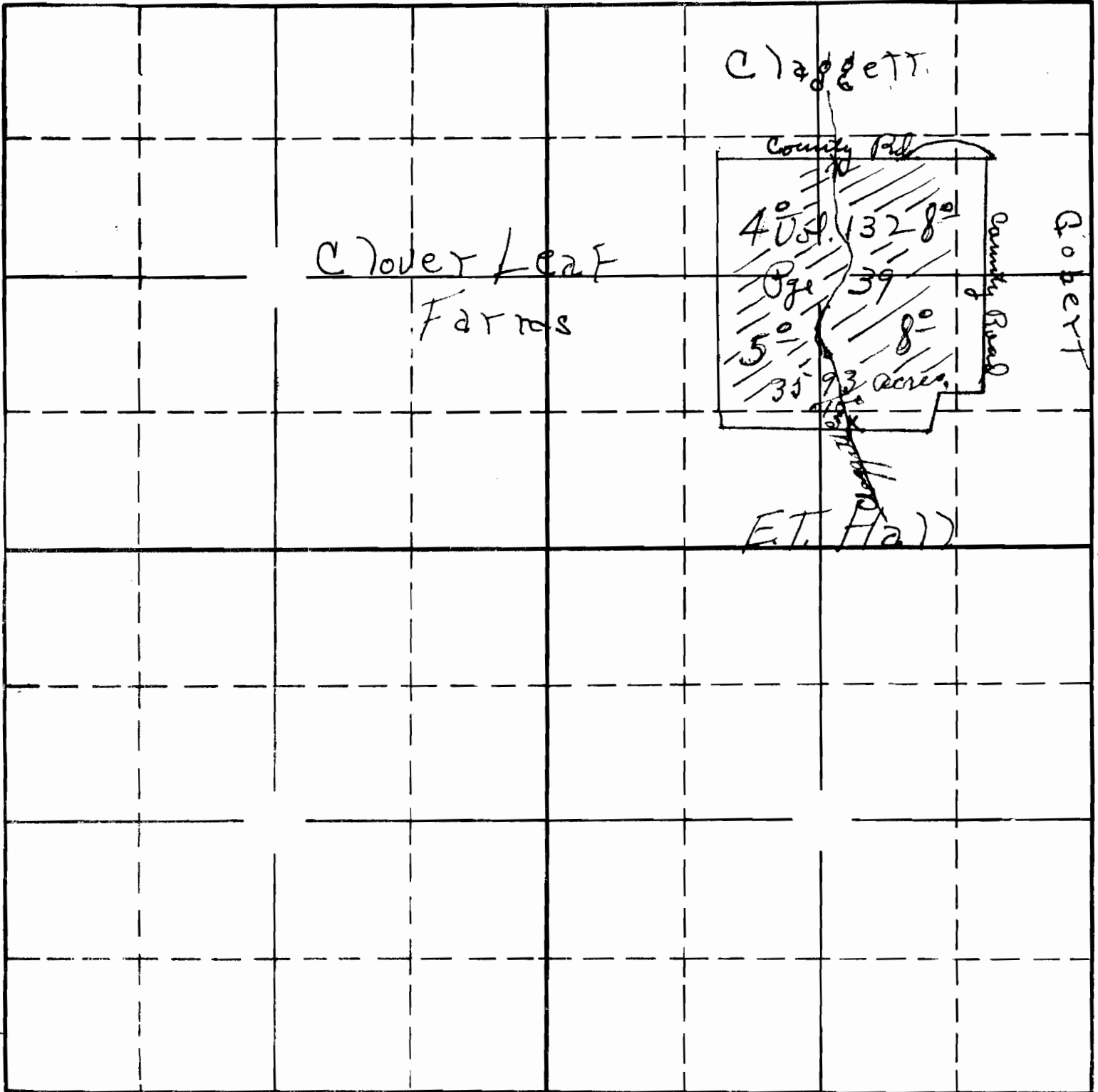

Claggett

County Rd

Clover Leaf Farms

40° 13' 28"

Page 39

5° 35' 9.3" acres

County Road

Gober

E.T. Hall

West

East

South

1744575
2-768
APPLICATION No.
PERMIT No.

TOWNSHIP 7S., RANGE 3W., W. M.

North

William R. Pugh
D.L.C. 41

09

John M. Pugh
D.L.C. 55

67

85

66

115

2

West

South

Surveyed Apr. 20 1939
by C.A.G.

APPLICATION No. 17445
PERMIT No. 13316