

SECTION

TOWNSHIP 6 N, RANGE 4 W, W. M.

E half Sect. 29

North

W half Sect 28

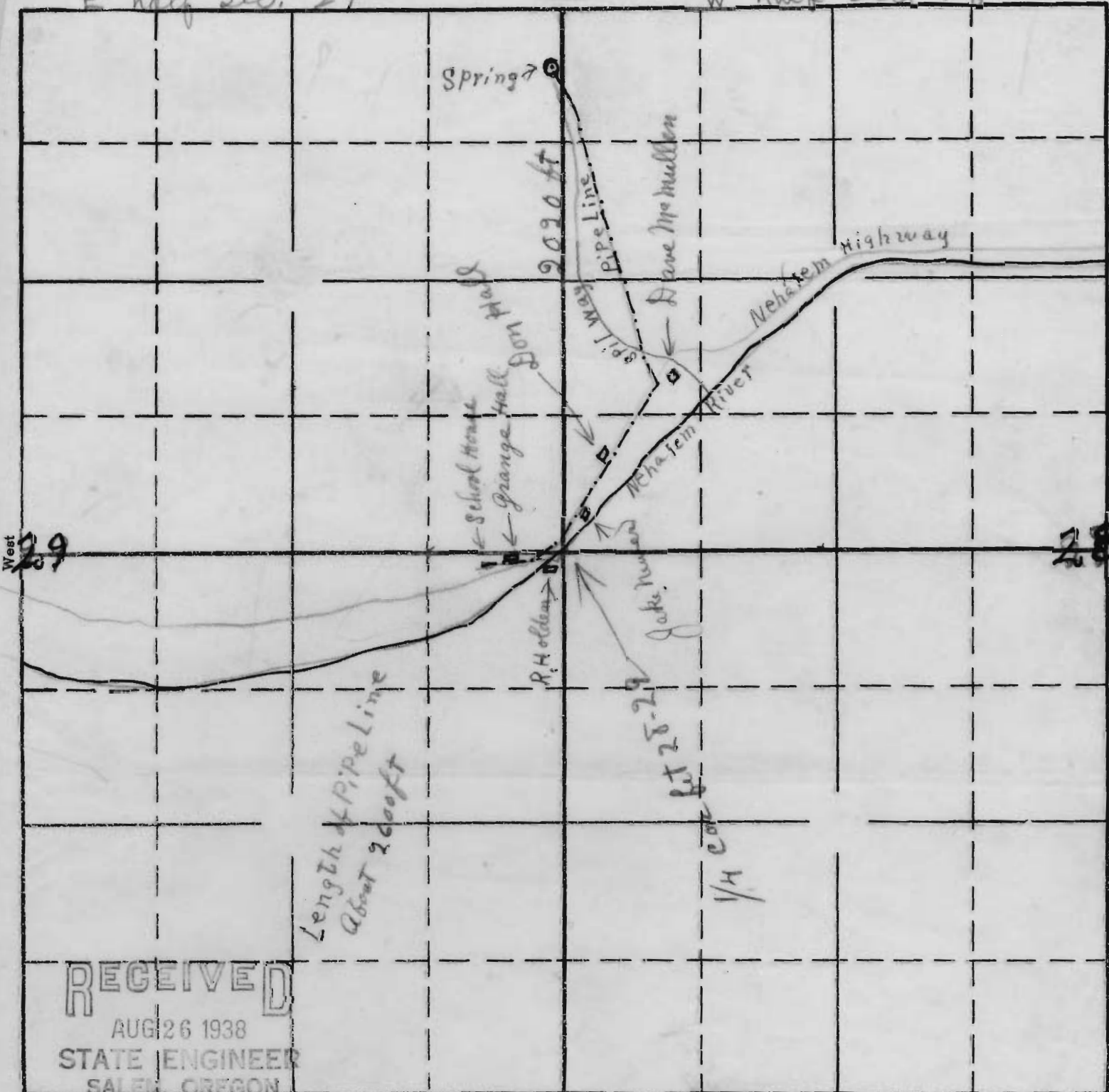

West 29

28 East

RECEIVED  
 AUG 26 1938  
 STATE ENGINEER  
 SALEM, OREGON

RECEIVED  
 OCT 17 1938  
 STATE ENGINEER  
 SALEM, OREGON

1010 road

South

17543 00  
 1-12  
 APPLICATION No. 17543  
 PERMIT No. 13322

SECTION

TOWNSHIP 6N, RANGE 4W, W. M.

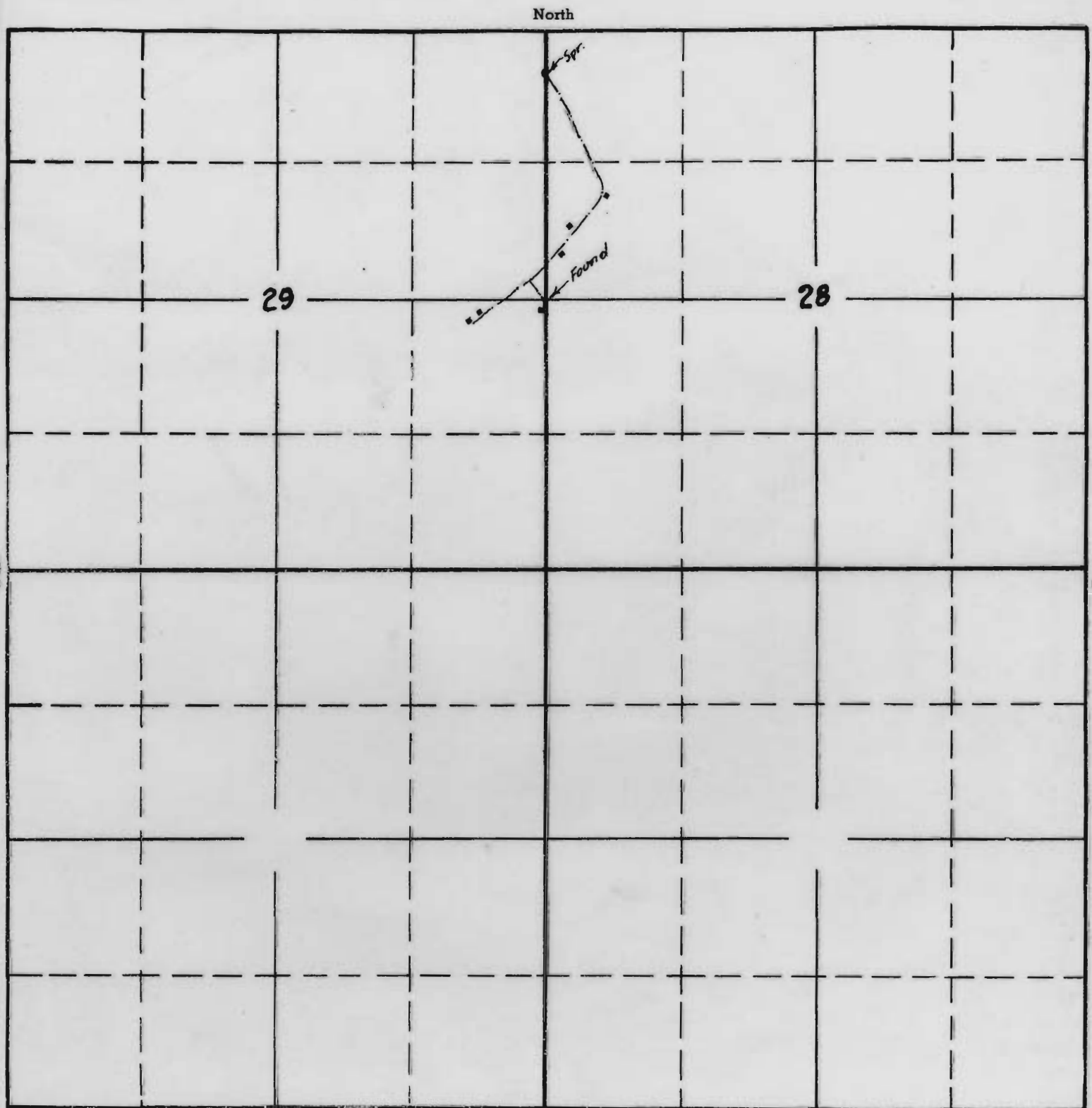

Surveyed by *Ed B May* <sup>29</sup> 1937 South

APPLICATION No. *17543*

PERMIT No. *13322*