

31

TOWNSHIP 35S, RANGE 1W, W. M.

North

Section 31.

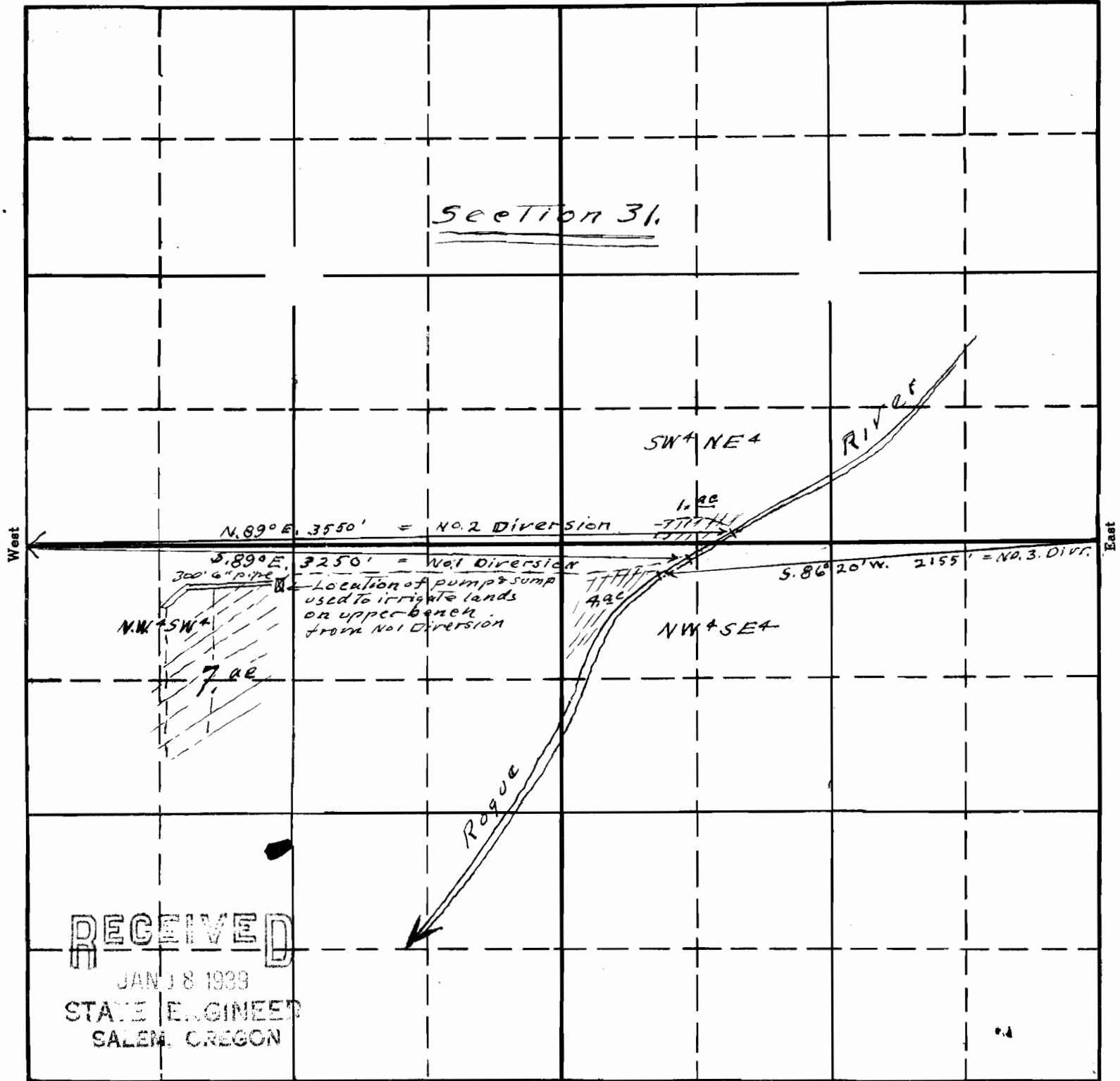

Sketch to accompany application of <sup>South</sup> Albert C Allen for use of the waters of Rogue River for irrigation purposes. Measurements furnished by A.C. Allen

17755 OK  
15-60  
APPLICATION No. 17755  
PERMIT No. 13416

This office 1/16/39 C.A. Smith