

SECTION

TOWNSHIP 45, RANGE 3W, W. M.

North

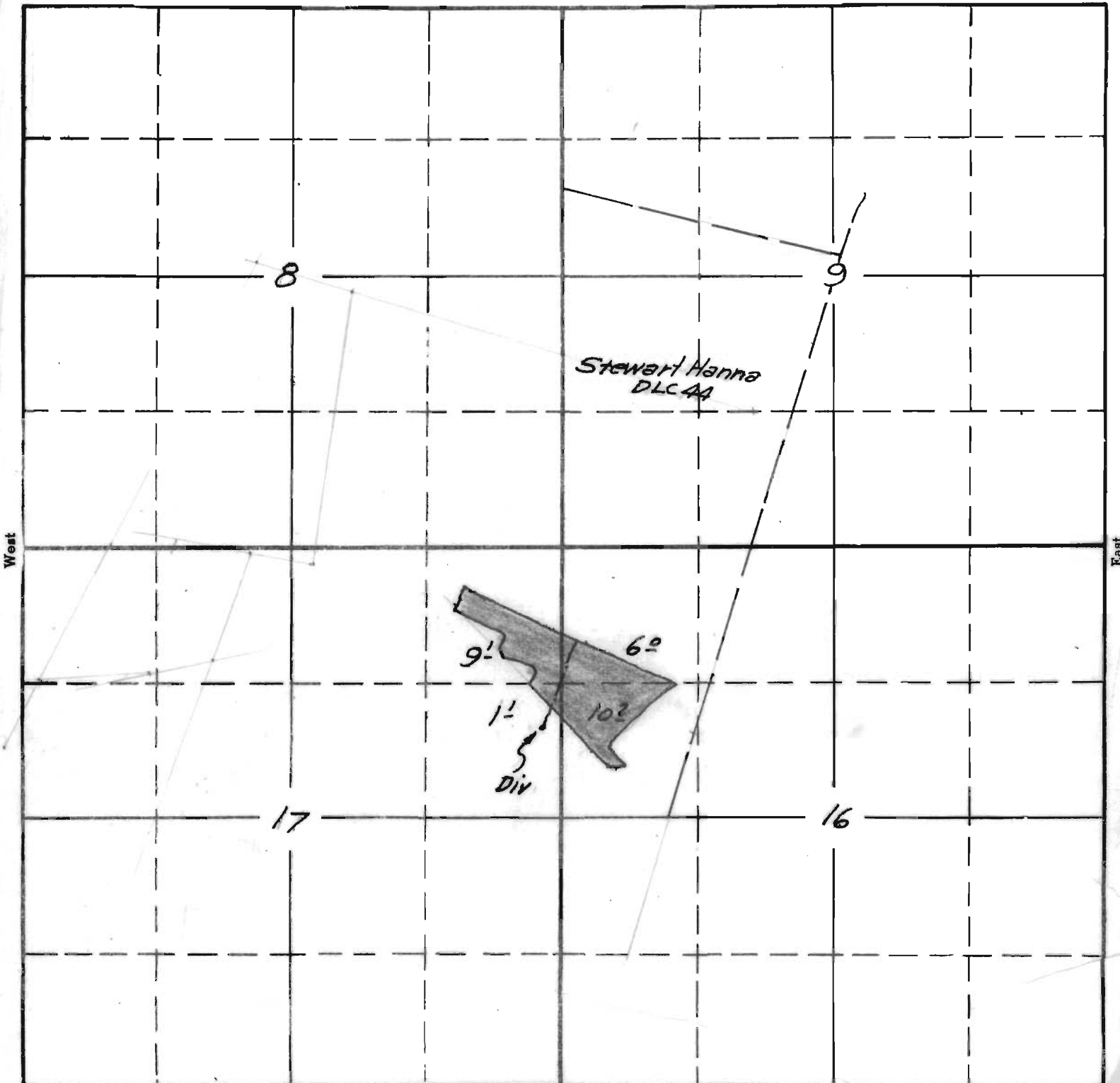

West

East

Surveyed June 5 1940 C.A.C.

South

APPLICATION No. 17759
PERMIT No. 13450

SECTION

TOWNSHIP 43, RANGE 3 W, W. M.

North

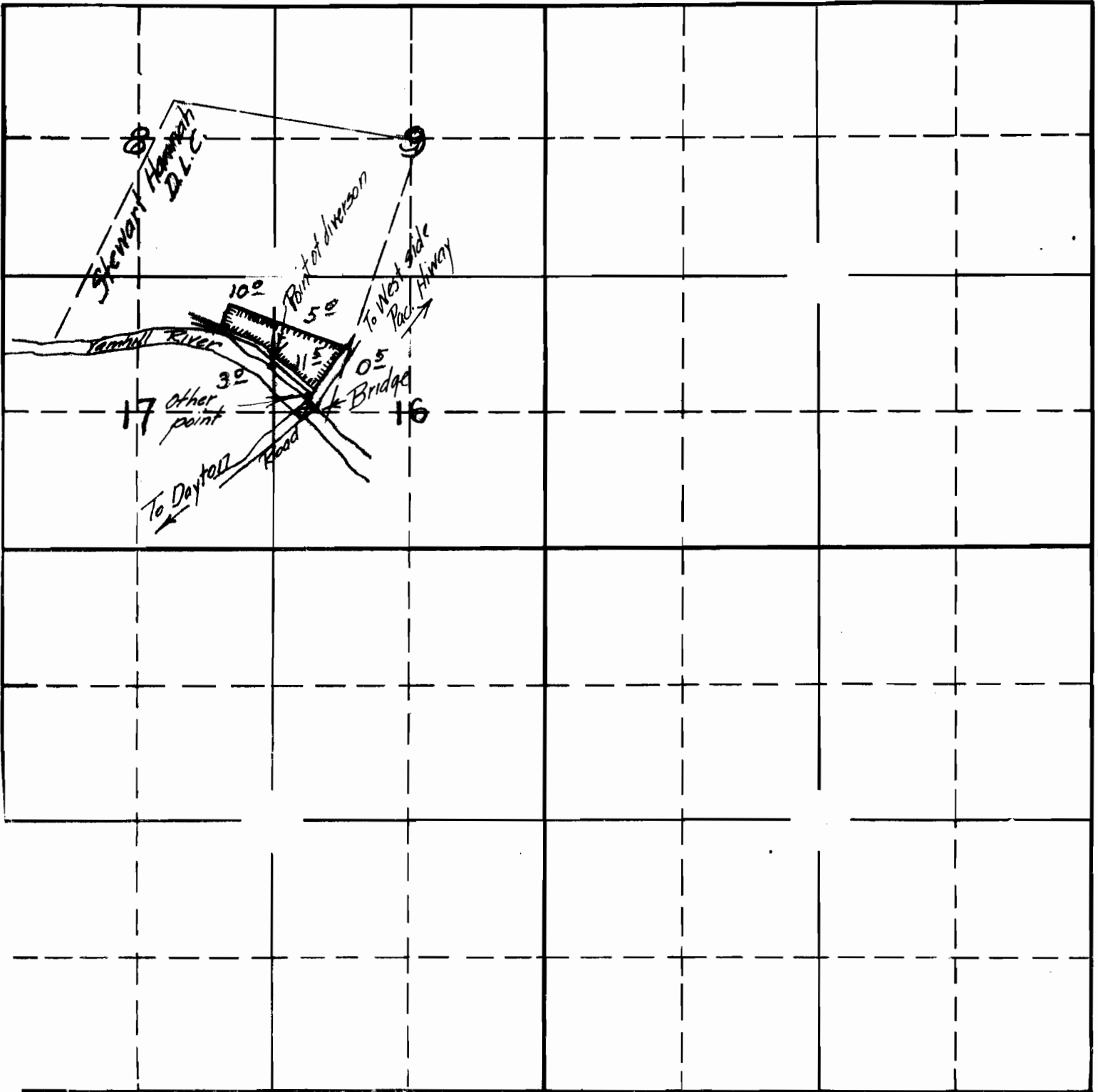

South

East

RECEIVED

JAN 18 1909

STATE ENGINEER
SALEM OREGON

APPLICATION No. 17759
PERMIT No. 13450