

DN

TOWNSHIP 35, RANGE 4W, W. M.

North

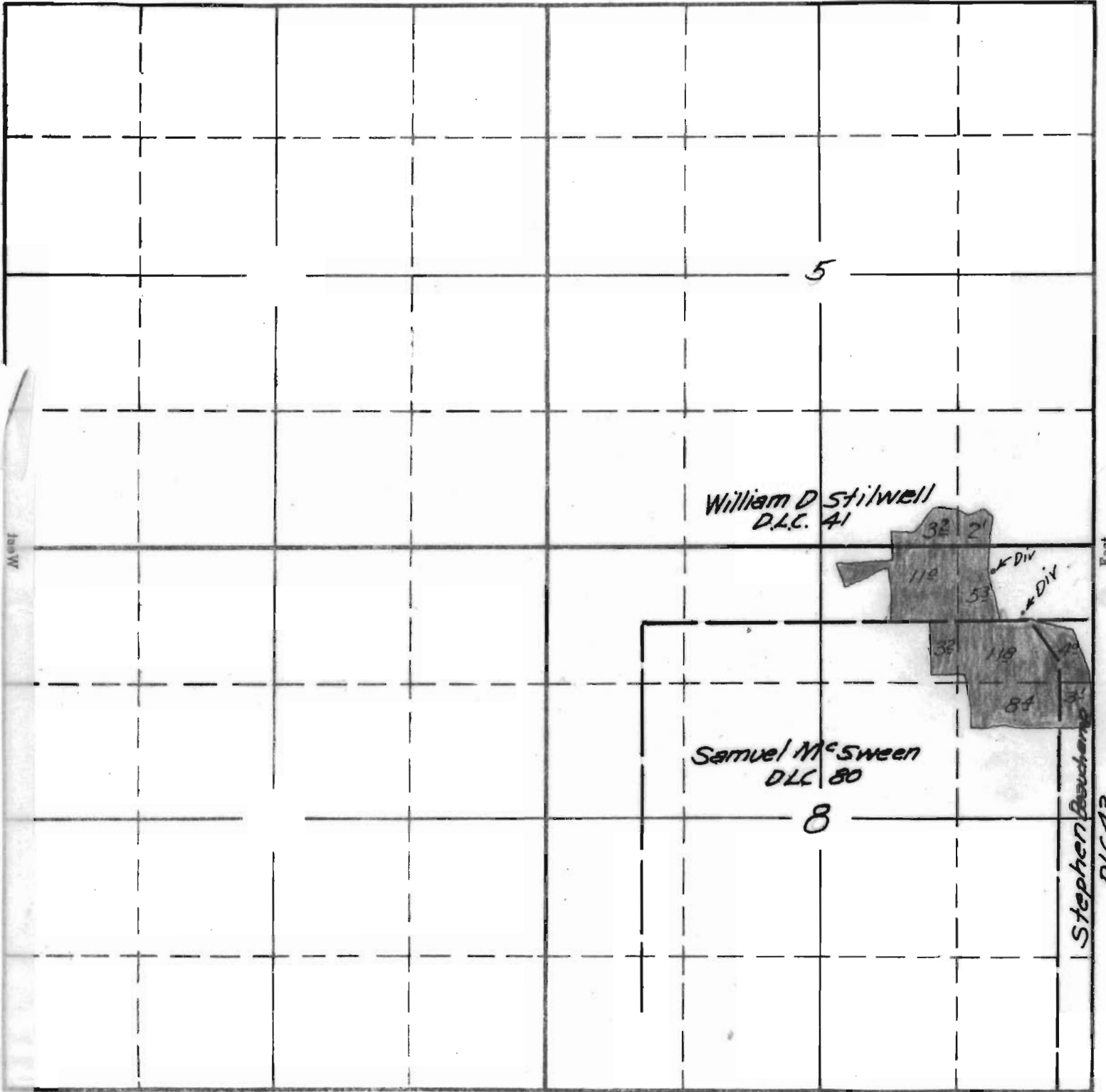

William D Stilwell
D.L.C. 41

Samuel McSween
D.L.C. 80

Stephen Baucom
D.L.C. 43

Surveyed June 6 1940 E.A.C.

South

APPLICATION No. 17774
PERMIT No. 13461

SECTION

TOWNSHIP 38, RANGE 4W, W. M.

North

West

East

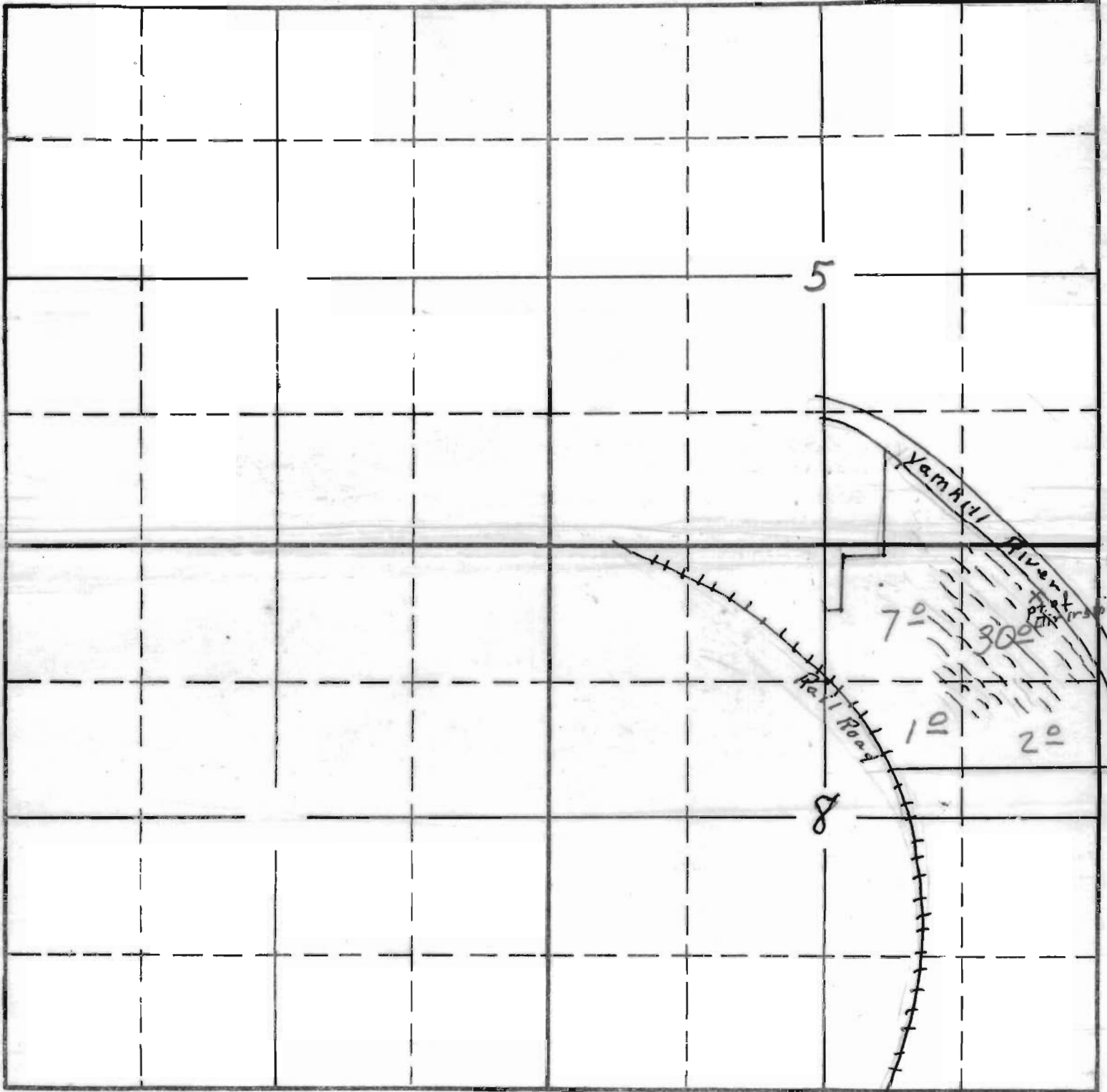

South

RECEIVED
JAN 30 1939
STATE ENGINEER
SALEM, OREGON

RECEIVED
FEB 8 1939
STATE ENGINEER
SALEM, OREGON

17774 OR
2-90d
APPLICATION No. 17774
PERMIT No. 13461