

MAP OF G. F. Campbell's
Irrigation Ditch.

Application No. 2222
Permit No. 1361

Application No. 2222
Permit No.

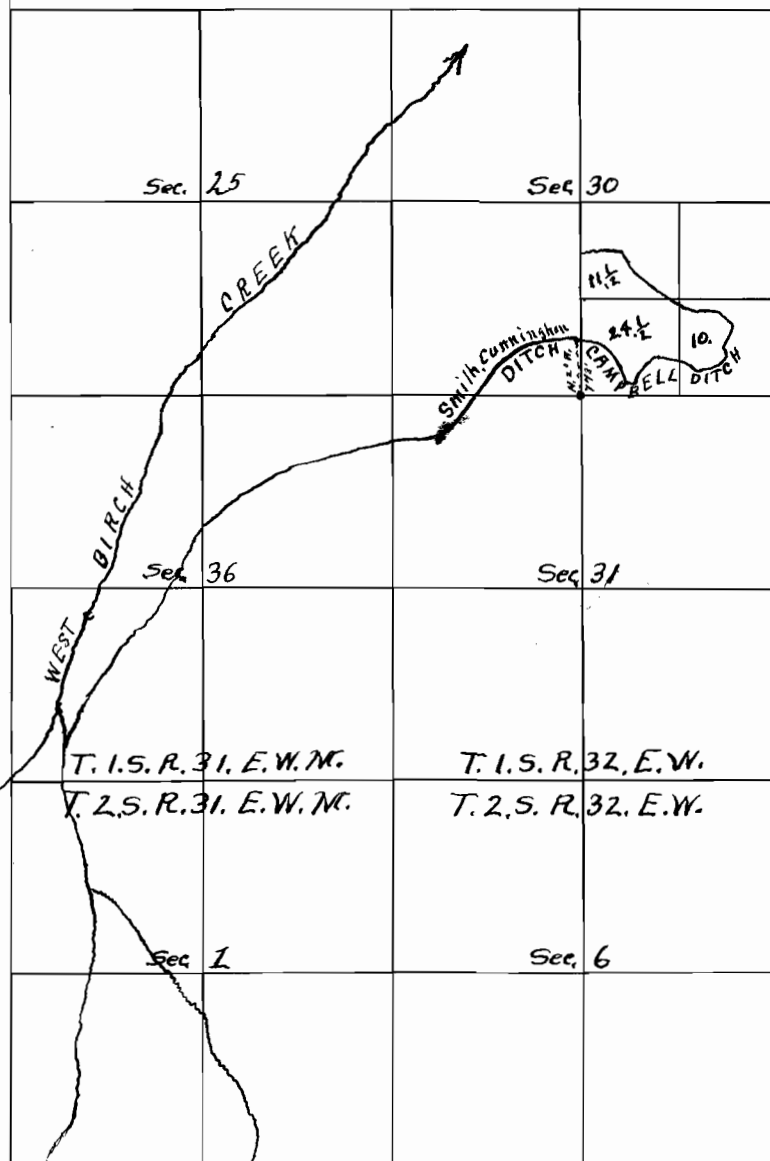

I, John W. Kimbrell do hereby certify that this map was made from notes taken during an actual survey made by me on the 26th day of August 1912 and that it correctly represents the works described in the accompanying application, together with the location of streams and other ditches in the immediate vicinity, and has written thereon the area in each smallest legal subdivision which it is proposed to irrigate.

John W. Kimbrell Surveyor.

App. 2222
Per 1361

True Meridian
Var. 21° E
Scale 40. Ch² 1"