

SECTION 31

TOWNSHIP 5N, RANGE 7W, W. M.

North

West

East

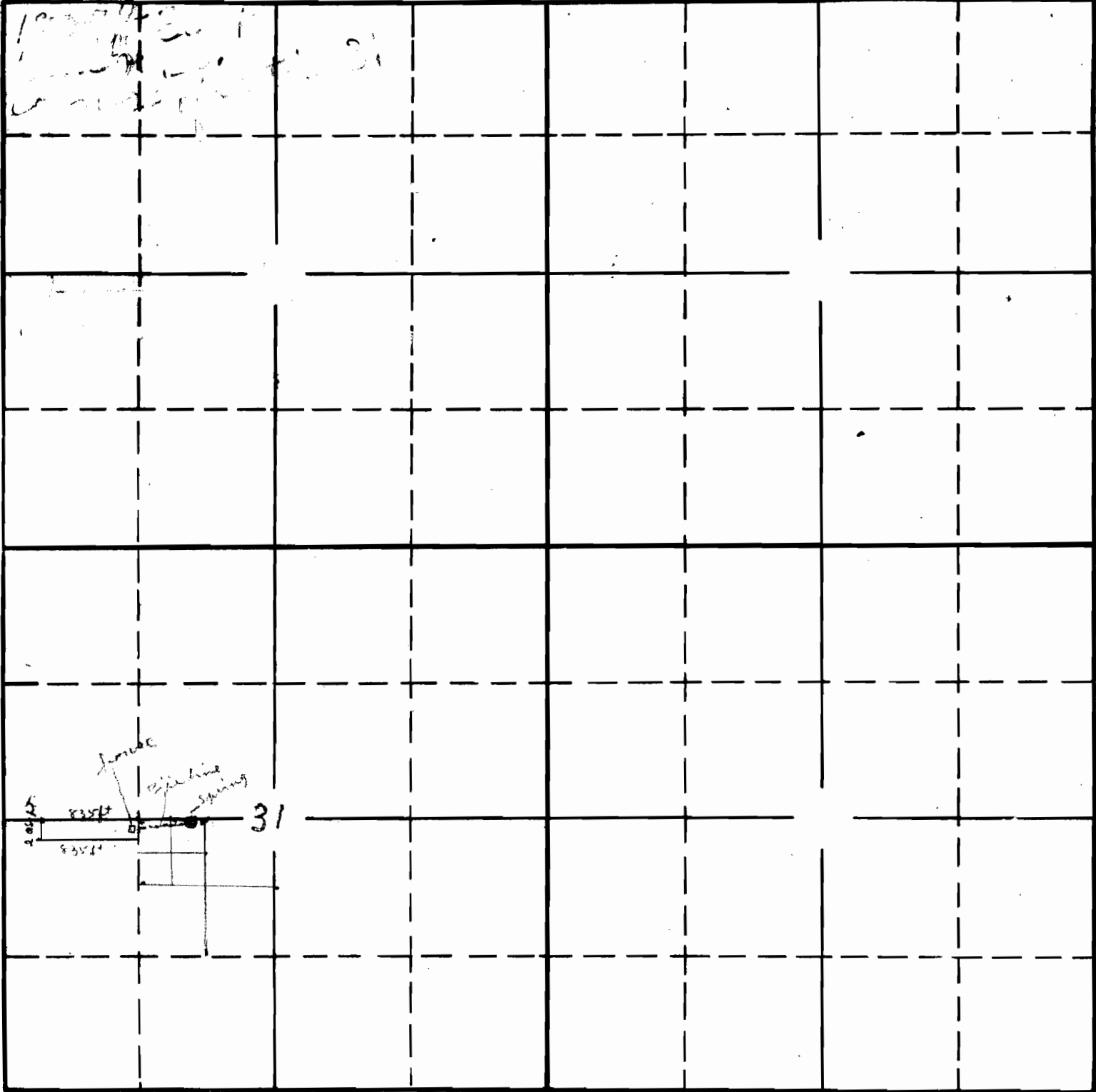

South

18160 02
1-12

APPLICATION No. 18160

PERMIT No. 13801

SECTION

TOWNSHIP *5N*, RANGE *7W*, W. M.

North

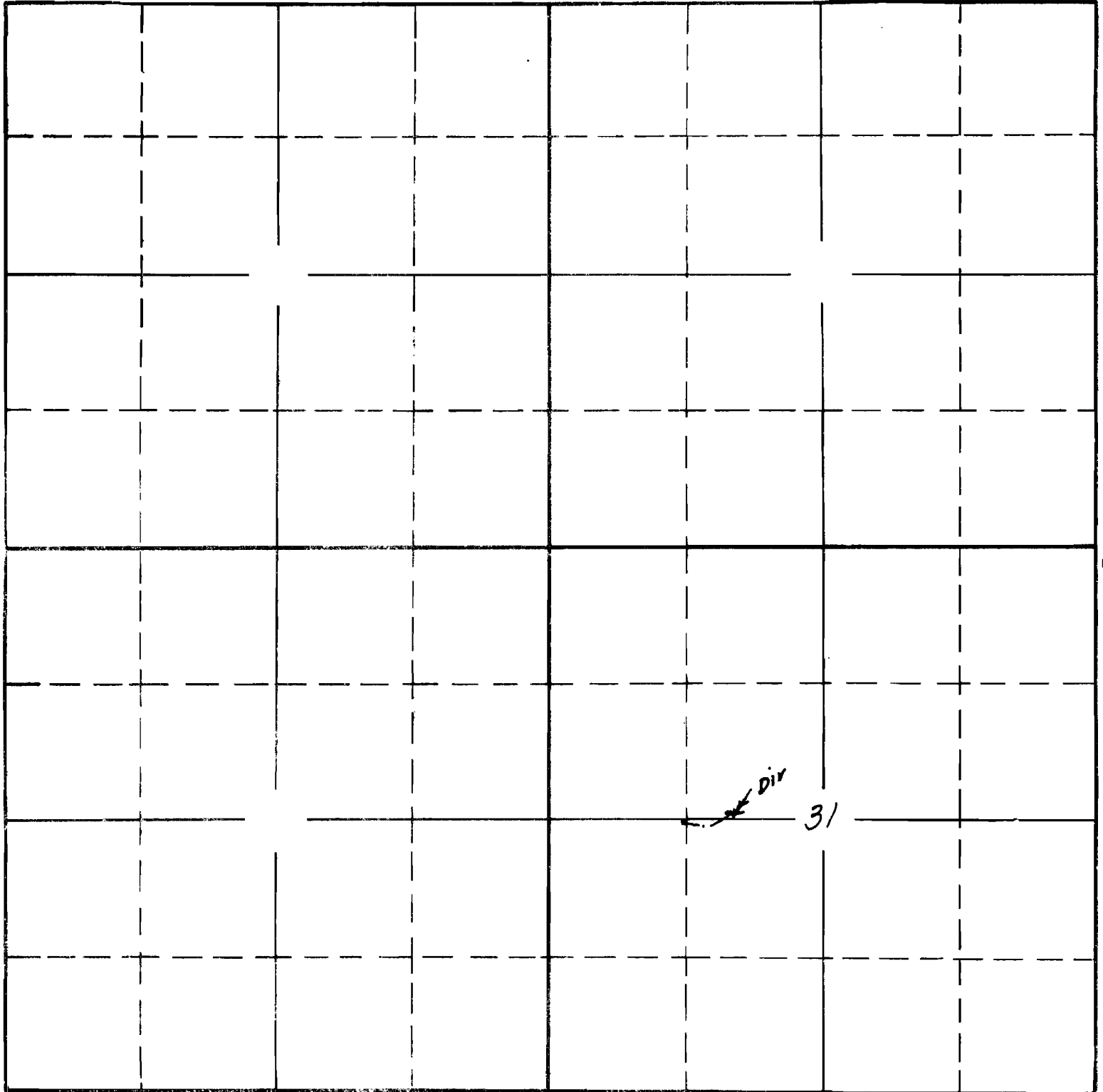

West

East

Surveyed June 21 1940 C.A.C.

South

APPLICATION No. *18160*

PERMIT No. *13801*