

SECTION

\_\_\_\_\_

\_\_\_\_\_

\_\_\_\_\_

\_\_\_\_\_

TOWNSHIP 32 S, RANGE 5 W, W. M.

North

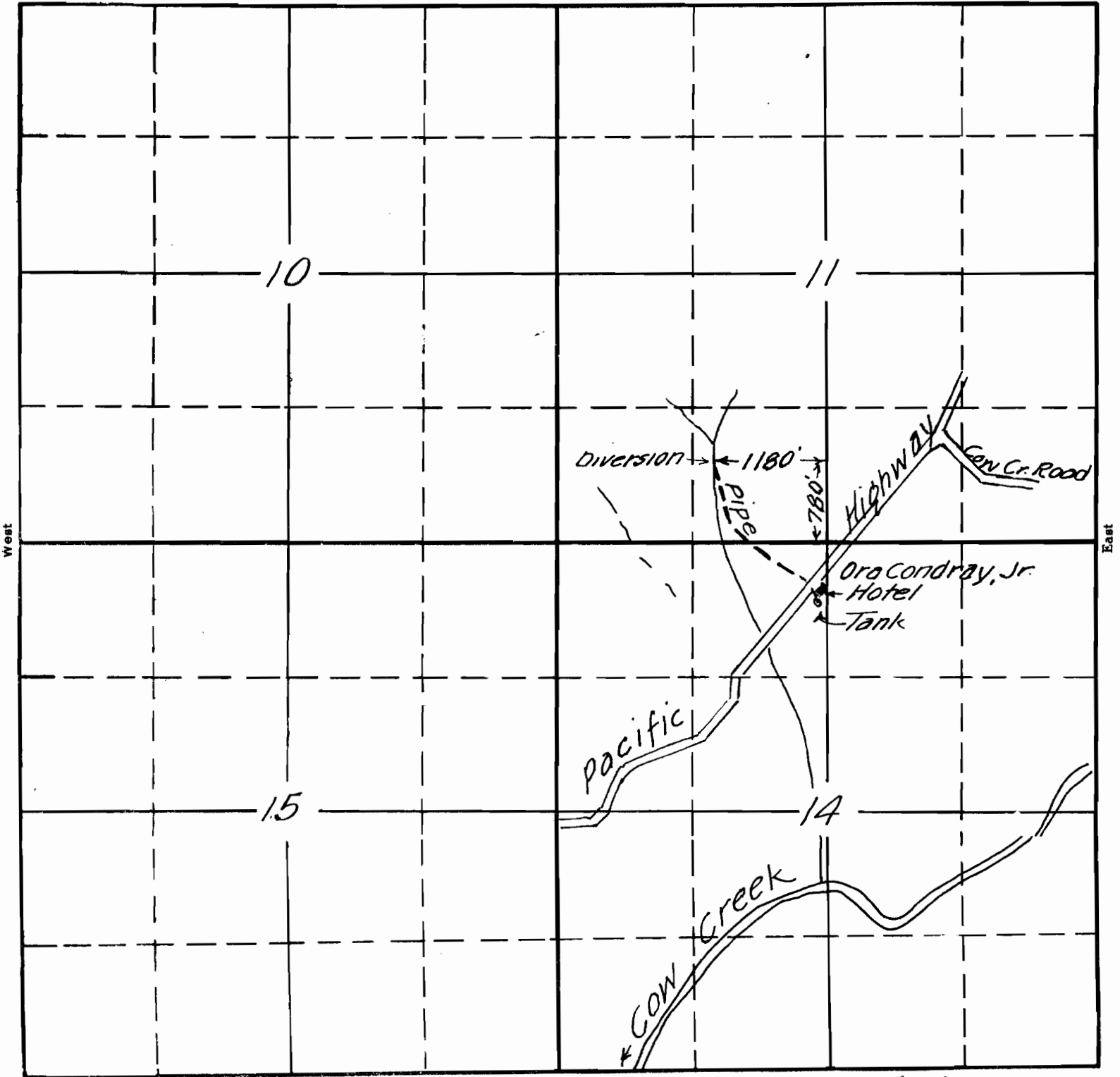

South

18198  
16-11

APPLICATION No. 18198  
PERMIT No. 13822

RECEIVED

JUN 17 1939

STATE ENGINEER  
SALEM, OREGON