

Section  
5, 32, 33

Townships 3 & 4 N., Range 38 E., W.M.  
North

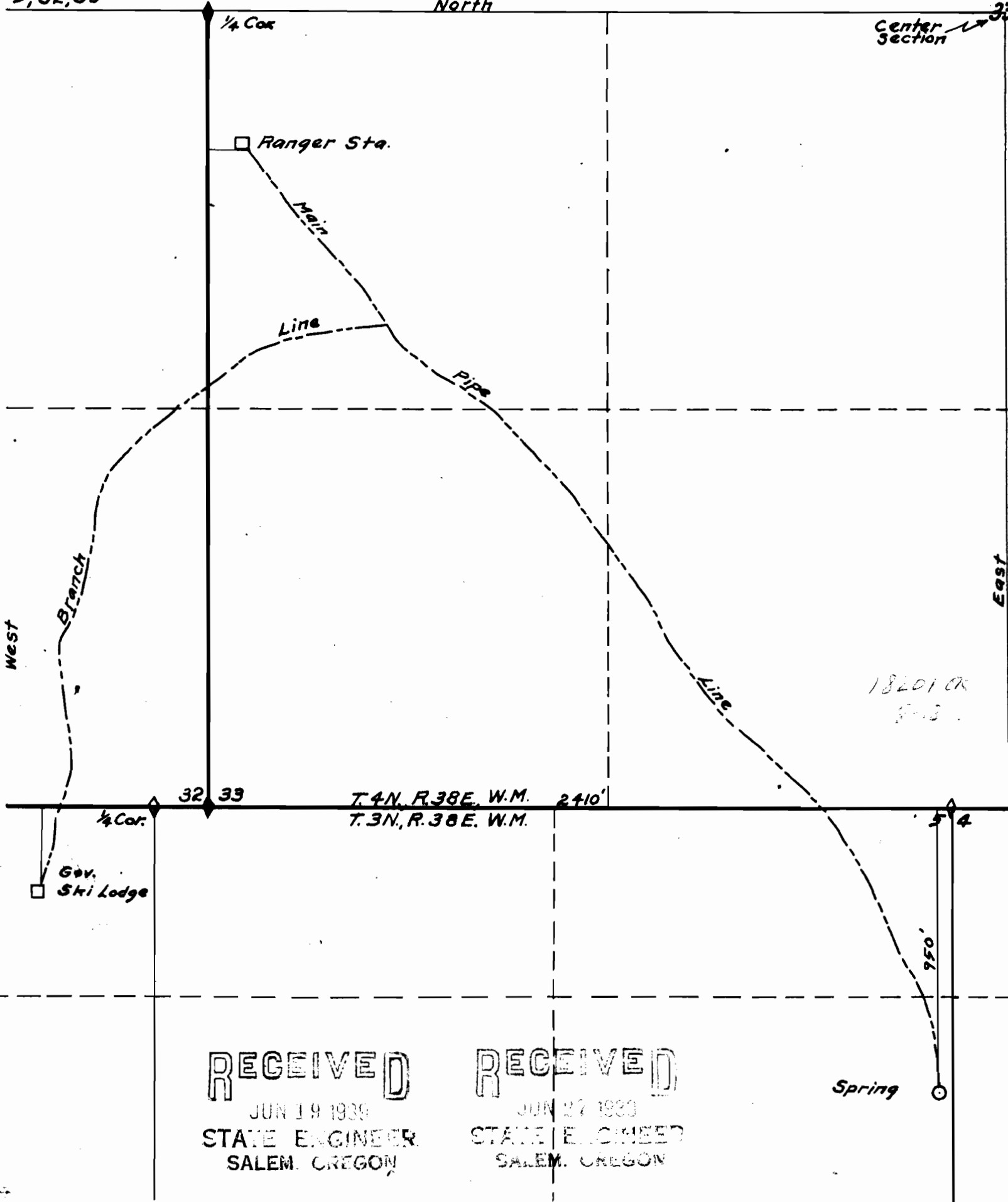

RECEIVED  
 JUN 19 1939  
 STATE ENGINEER  
 SALEM, OREGON

RECEIVED  
 JUN 27 1939  
 STATE ENGINEER  
 SALEM, OREGON

Scale 1" = 400'

R.G.M. 5/29/39

South

Application No. 18201

Permit No. 13825