

RECEIVED

JUN 22 1939

STATE ENGINEER
SALEM, OREGON

North

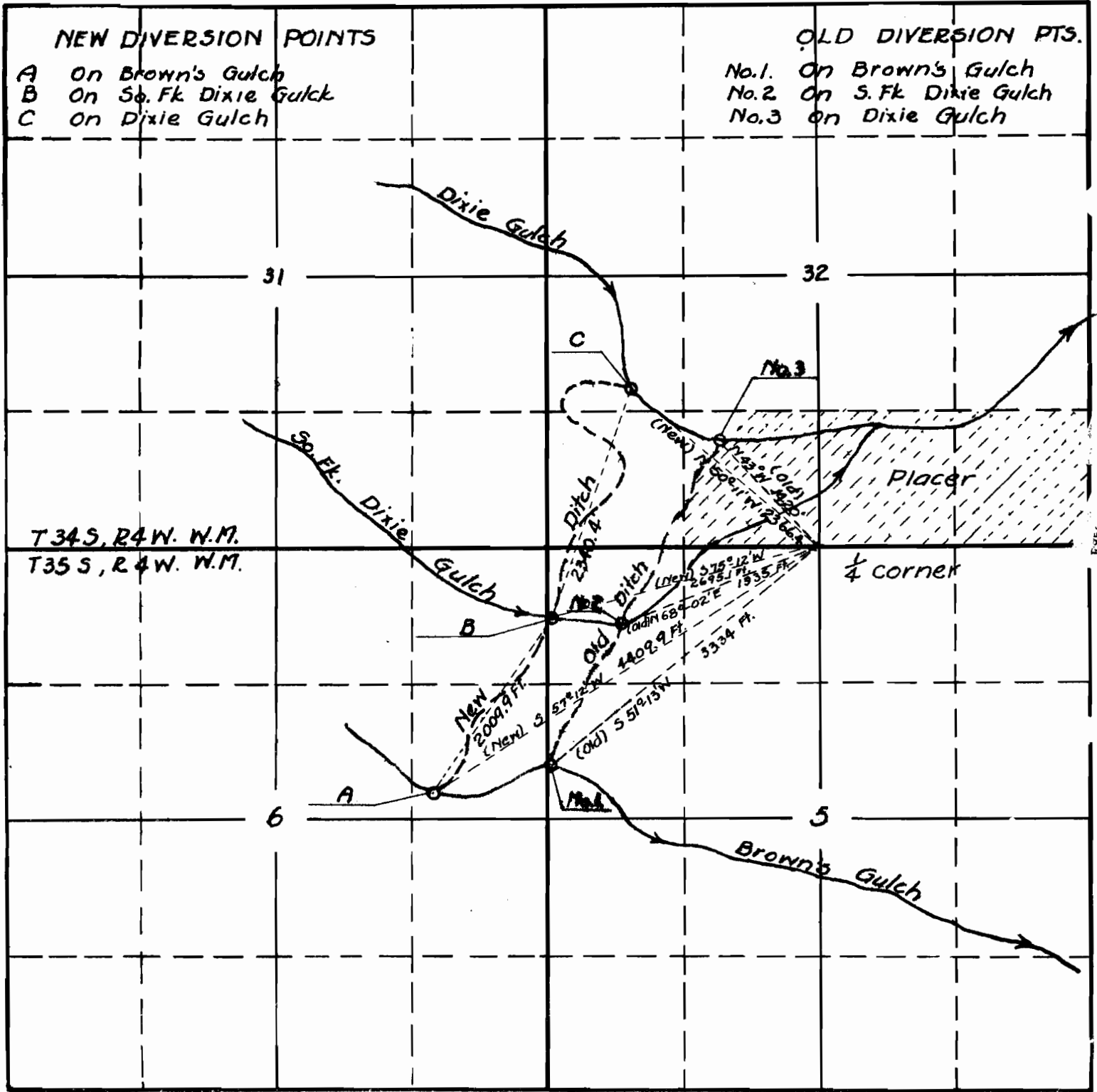

South

Map to accompany application of Bunce & McCarrel (Dixie Placers) for change in diversion points on Brown's Gulch, So. Fk. Dixie Gulch and Dixie Gulch, also application for 2.0 addition second feet from Brown's Gulch. Diversion points located on map from notes taken on actual survey in the field. Streams sketched from information taken from Township Plats of U.S. Land Survey.

18211 AC
15-40
APPLICATION No. 18211
PERMIT No. 13833