

SECTION

TOWNSHIP 1 N, RANGE 43 E, W. M.

North

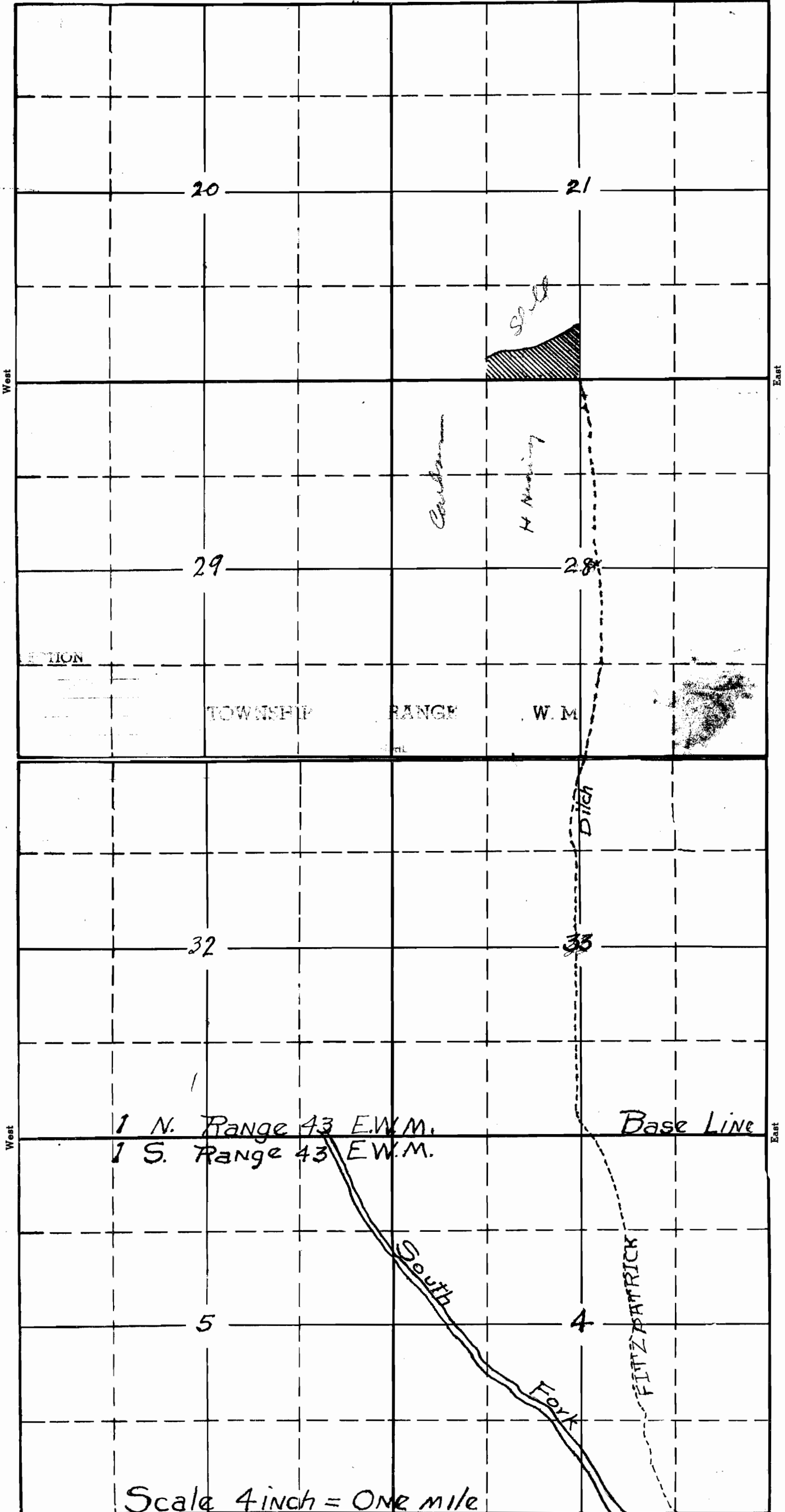

1 N. Range 43 E.W.M.
1 S. Range 43 E.W.M.

Base Line

South

Sec. 9

18210.01
8-36

APPLICATION No. 18210
PERMIT No. 13850

RECEIVED

JUN 19 1939

STATE ENGINEER
SALEM, OREGON