

SECTION

TOWNSHIP 29 S , RANGE 14 W , W. M.

North

West

East

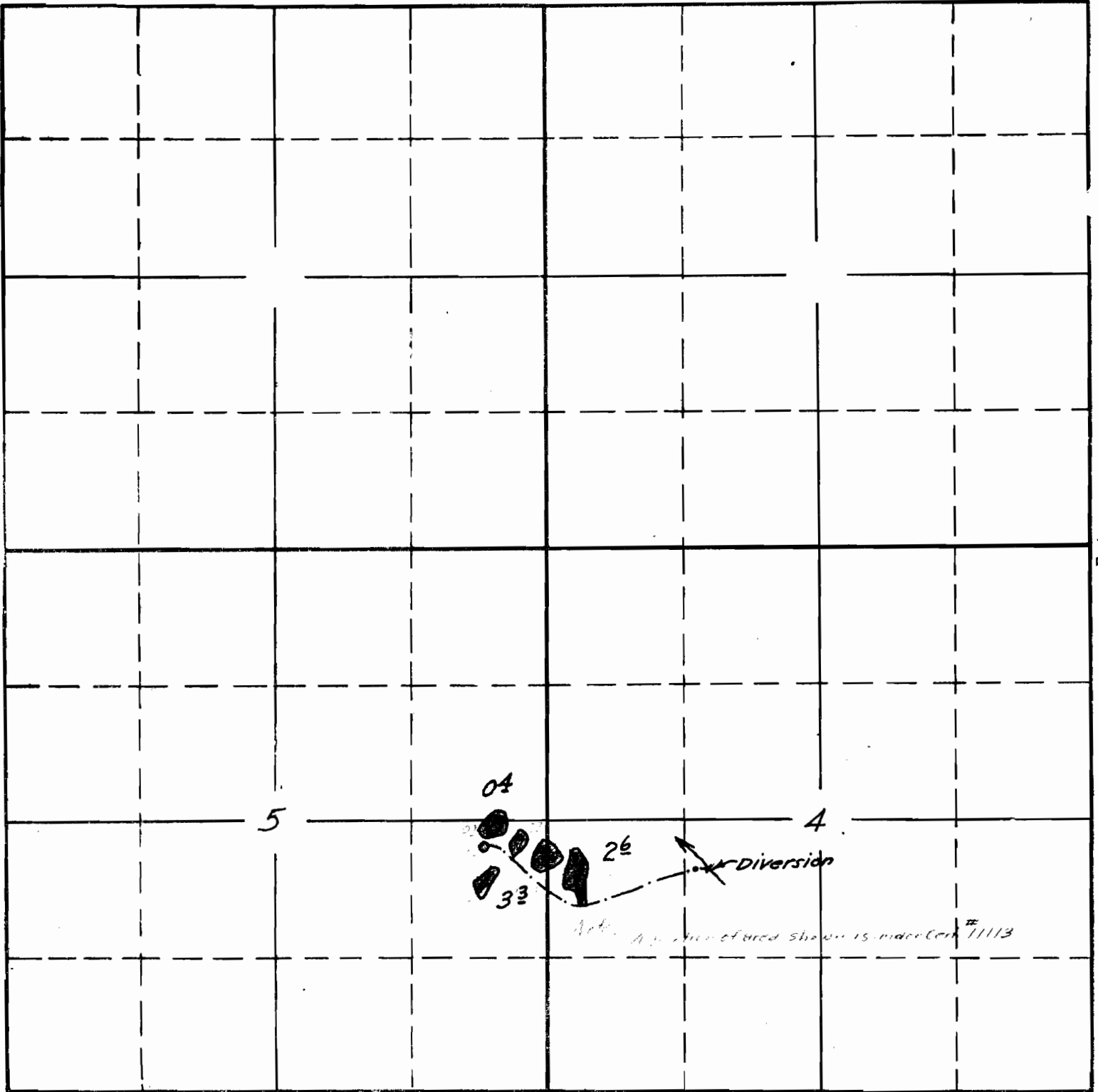

Surveyed July 5, 1940 C.A.C.

South

APPLICATION No. 18237

PERMIT No. 13898

SECTION

~~576~~
475

TOWNSHIP 29 S., RANGE 14 W., W. M.

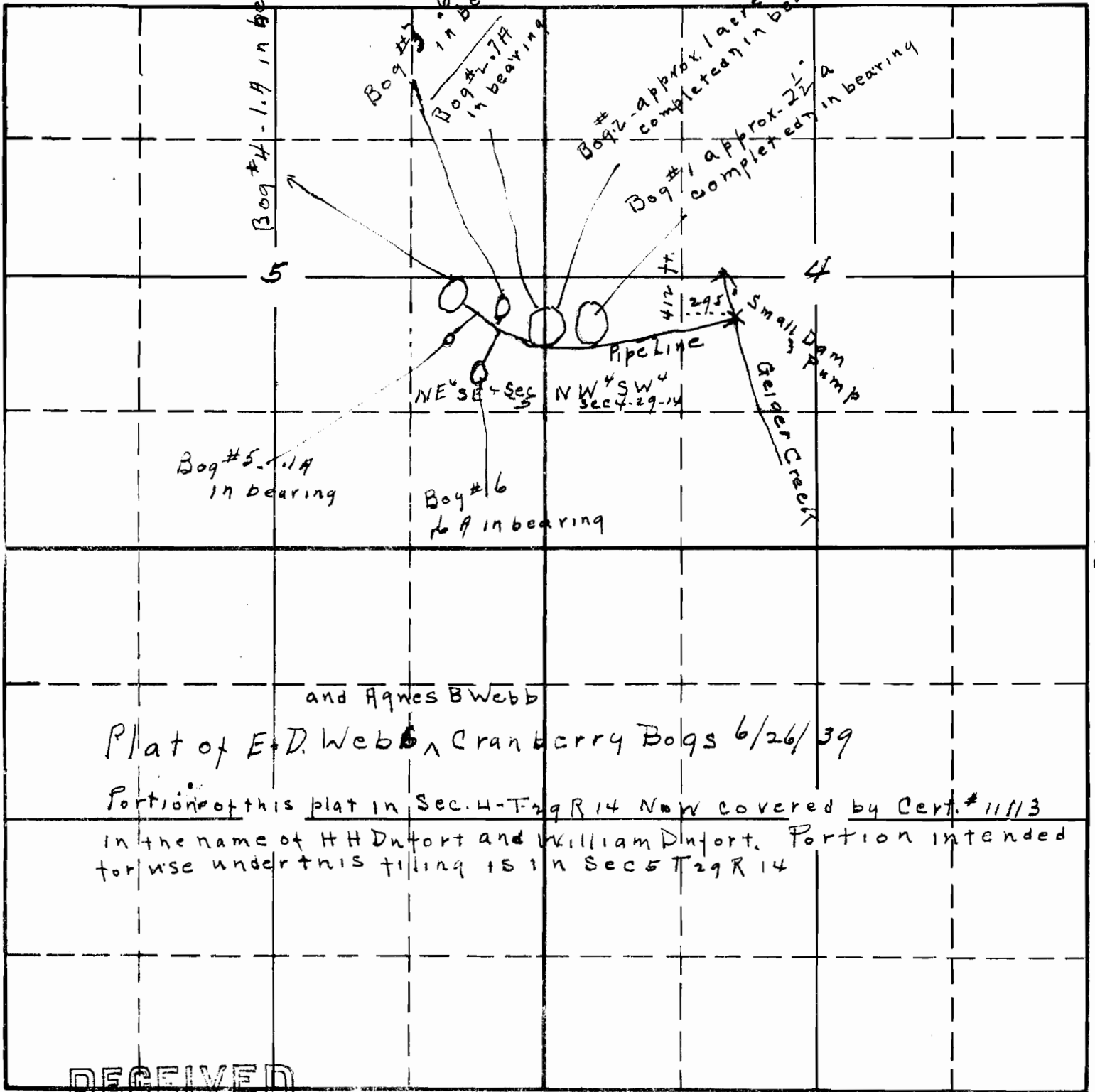

and Agnes B Webb

Plat of E. D. Webb & Cranberry Bogs 6/26/39

Portions of this plat in Sec. 4-T29R14 Now covered by Cert. # 11113

In the name of H H Dufort and William Dufort. Portion intended for use under this filing is in Sec 5 T29R14

RECEIVED

JUN 28 1939

STATE ENGINEER
SALEM, OREGON

South

APPLICATION No.

18237

PERMIT No.

13898